



# Cutter Lane

London, SE10

Asking Price £725,000

A stunning 2-bedroom 2-bathroom apartment located on the 10th floor of this luxury development. Ideally located next to the O2, offering a range of amenities. North Greenwich tube station is very close by offering swift access across the city.



# Cutter Lane

London, SE10

- Two bedroom two bathroom apartment
- Modern, stylish interior
- Underfloor heating
- River views
- Communal BBQ terrace overlooking the River Thames
- Residents have access to The Upper Riverside Club with
- Gym, swimming pool, cinema, multimedia room and 24 hour concierge.
- Located next to to O2





This modern two-bedroom, two-bathroom apartment is ideally situated on the 10th floor of Building No 5 within Greenwich Peninsula's exclusive 'Upper Riverside' neighbourhood on Cutter Lane with its art galleries and food market.

The apartment is located 300m from North Greenwich bus and tube station, beside North Greenwich Pier and just moments from the IFS Cloud Cable Car. It is also close proximity to North Greenwich boat terminals for commuting across the city.

Residents enjoy access to the 'Upper Riverside Club', offering access to amenities including three gyms, 15th floor swimming pool,

**Tenure:** Leasehold 229 years 2 months

**Service Charge:** £6351.72

**Ground Rent:** £0 Peppercorn

**Local Authority:** Tower Hamlets

**Council Tax Band:** E

Energy Efficiency Rating		
	Current	Potential
Very energy efficient - lower running costs		
<b>A</b> (91-100)		
<b>B</b> (81-90)	83	83
<b>C</b> (69-80)		
<b>D</b> (55-68)		
<b>E</b> (39-54)		
<b>F</b> (21-38)		
<b>G</b> (1-20)		
Not energy efficient - higher running costs		
England, Scotland & Wales		EU Directive 2002/91/EC

## Chestertons Canary Wharf & Greenwich Sales

Harbour Island

28 Harbour Exchange Square

London

E14 9GE

canarywharf@chestertons.co.uk

020 7510 8300

chestertons.co.uk

# Cutter Lane, SE10

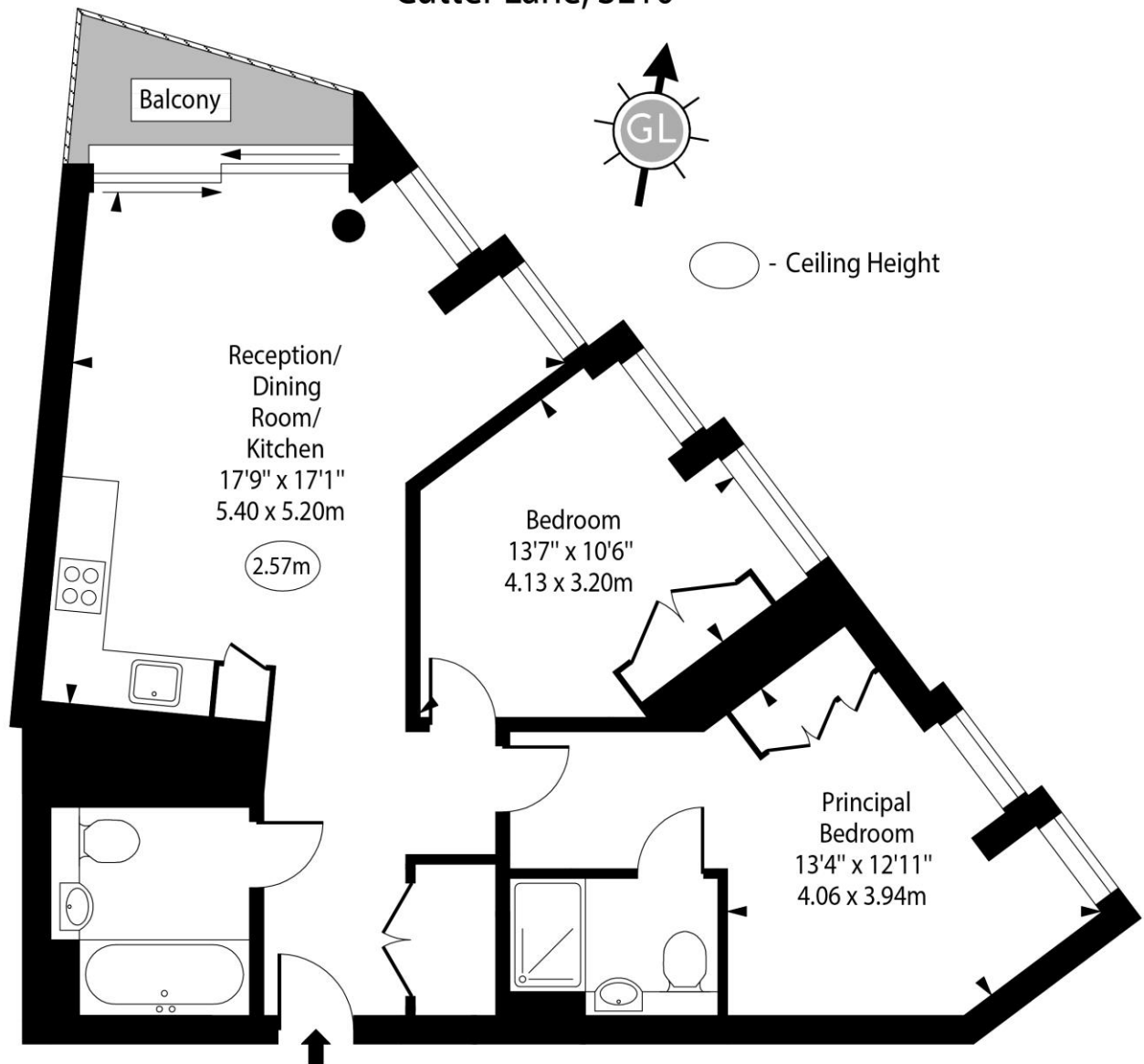

Tenth Floor

Approx Gross Internal Area

735 Sq Ft - 68.28 Sq M

For Illustration Purposes Only - Not To Scale

[www.goldlens.co.uk](http://www.goldlens.co.uk)

Ref. No. 027286IG

