



Seacon Tower

5 Hutchings Street, E14

Asking Price £350,000

Stunning one bedroom apartment in Seacon Wharf, a modern riverside development with 24hr concierge, gym, jacuzzi, sauna & steam room.



Seacon Tower

5 Hutchings Street, E14

- Modern design with high-quality finishes
- Spectacular views of Canary Wharf Skyline
- Spacious Open-plan Living Area
- Modern Galley Kitchen
- One Double Bedrooms
- Stylish Bathroom Suite
- Private Balcony
- Access to Gym and Concierge Services



Stunning one bedroom apartment of 500sq ft in Seacon Tower with accommodation comprising of a semi open-plan living kitchen arrangement, a private balcony boasting stunning views of Canary Wharf skyline, wooden flooring throughout and a designer bathroom.

Seacon Tower boasts an exceptional location very close to Canary Wharf's business district, Jubilee Line station & subterranean shopping centre and offers residents a 24 hour concierge, & on-site facilities. The building possesses a satisfactory EWS1 form and the apartment is offered chain-free.

Excellent transport connections are available via Heron Quays DLR 0.7 mile, Canary Wharf London Underground (Jubilee Line Services) 0.7 mile away

Tenure: Leasehold 975 years 10 months

Service Charge: £5,669 pa approx.

Ground Rent: £770 ap approx. Increasing every 15th anniversary from the Commencement Date of the Term, inline with RPI for the first 125 years.

Local Authority: Tower Hamlets

Council Tax Band: D

Energy Efficiency Rating		
	Current	Potential
Very energy efficient - lower running costs		
(94-100) A		
(81-93) B		
(69-80) C	71	71
(55-68) D		
(39-54) E		
(21-38) F		
(1-20) G		
Not energy efficient - higher running costs		
England, Scotland & Wales EU Directive 2002/91/EC		

Chestertons Canary Wharf & Greenwich Sales

Harbour Island
 28 Harbour Exchange Square
 London
 E14 9GE
 canarywharf@chestertons.co.uk
 020 7510 8300
 chestertons.co.uk

Seacon Tower, Hutchings Street, E14

○ - Ceiling Height

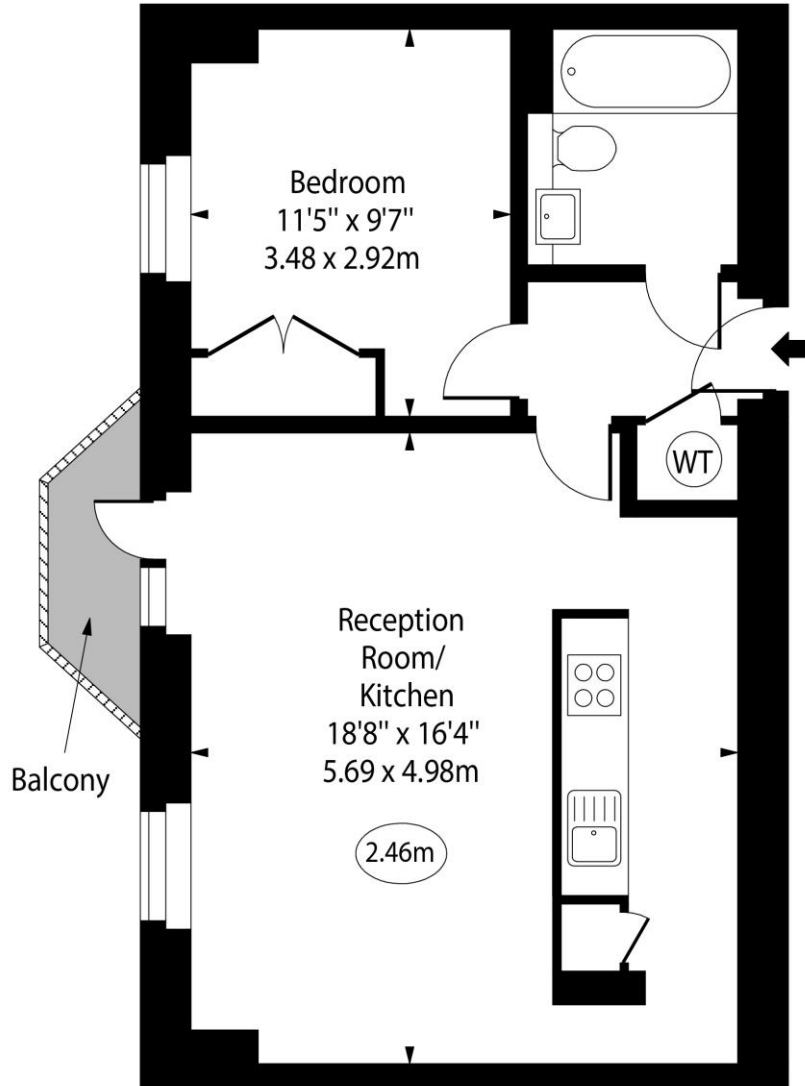
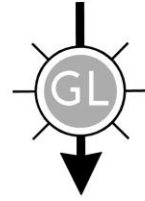

Sixth Floor

Approx Gross Internal Area 500 Sq Ft - 46.45 Sq M

For Illustration Purposes Only - Not To Scale

www.goldlens.co.uk

Ref. No. 026761K

