



Arena Tower

25 Crossharbour Plaza, E14

Asking Price £770,000

This stunning two-bedroom, two bathroom apartment offers a premium modern city lifestyle with exceptional views and top tier amenities.

CHESTERTONS



Arena Tower

25 Crossharbour Plaza, E14

- Two bedroom, two bathroom apartment in Arena Tower
- 42nd Floor
- Large balcony with stunning views
- 24hr concierge
- Parking
- Gym and swimming pool access



Located on 42nd floor of Arena Tower, this apartment boasts a large South Easterly facing balcony with sweeping views of the River Thames, the O2 arena and Greenwich Park.

The apartment is filled with natural light, featuring a spacious living room with floor to ceiling windows and wooden floors. The sleek open-plan kitchen provides ample space for entertaining. Both bedrooms come with built in storage, and the main bedroom includes an en-suite bathroom. there is also a family bathroom with contemporary fixtures.

Residents of Arena Tower enjoy exclusive 24 hours concierge service, access to a cinema room, a fully equipped gym, and a swimming pool. A parking space is also included.

Tenure: Leasehold 980 years 9 months

Service Charge: £6847.22 approx.

Ground Rent: £750 such sum to double on every twenty fifth anniversary of the Commencement Date for the first 101 years of the Term

Council Tax Band: G

Local Authority: Tower Hamlets

| Energy Efficiency Rating | | |
|---|---------|-------------------------|
| | Current | Potential |
| Very energy efficient - lower running costs | | |
| (92-100) A | | |
| (81-91) B | 81 | 81 |
| (69-80) C | | |
| (55-68) D | | |
| (39-54) E | | |
| (21-38) F | | |
| (1-20) G | | |
| Not energy efficient - higher running costs | | |
| England, Scotland & Wales | | EU Directive 2002/91/EC |

Chestertons Canary Wharf & Greenwich Sales

Harbour Island

28 Harbour Exchange Square

London

E14 9GE

canarywharf@chestertons.co.uk

020 7510 8300

chestertons.co.uk

Arena Tower, Crossharbour Plaza, E14

○ - Ceiling Height

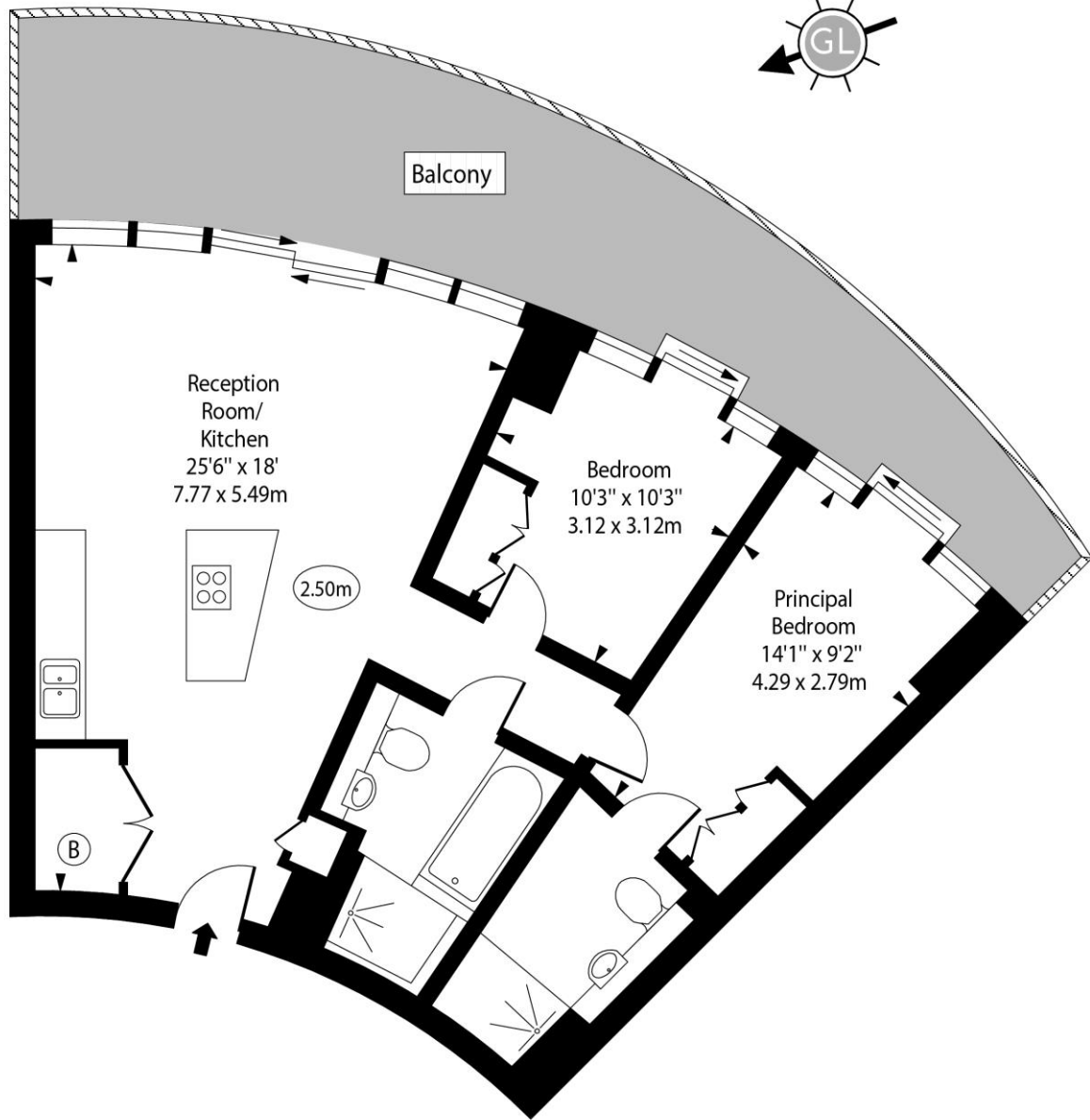
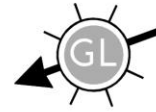

Fourty Second Floor

Approx Gross Internal Area 780 Sq Ft - 72.46 Sq M

For Illustration Purposes Only - Not To Scale

www.goldlens.co.uk

Ref. No. 025897E

