



Boardwalk Place

London, E14

Asking Price £1,350,000

The property boasts three spacious double bedrooms, two bathrooms of which one is en-suite with further W.C. and spacious reception/dining area. Boardwalk Place is the perfect location for access to Canary Wharf and its amenities.



Boardwalk Place

London, E14

- Three bedroom penthouse with wrap-around balcony
- Stunning panoramic views
- Riverside development with concierge service
- Allocated parking space
- Lift access
- Large private roof terrace
- Walking distance to Canary Wharf



A Beautiful 9th floor Penthouse Apartment with private roof terrace close to Canary Wharf.

The property boasts three spacious double bedrooms, two bathrooms of which one is en-suite with further W.C. and spacious reception/dining area. The property has stunning wrap around views of the locality and features a large roof terrace.

Boardwalk Place is the perfect location for access to Canary Wharf and its amenities. There is a concierge and the property comes with off street parking.

Tenure: Leasehold 971 years 8 months
Service Charge: £12185 £12,185 pa approx
Ground Rent: £200
Local Authority: Tower Hamlets
Council Tax Band: G

Energy Efficiency Rating		
	Current	Potential
Very energy efficient - lower running costs		
A (94-100)		
B (81-93)		
C (69-80)		
D (55-68)		
E (39-54)	51	69
F (21-38)		
Not energy efficient - higher running costs		
G (1-20)		
England, Scotland & Wales EU Directive 2002/91/EC		

Chestertons Canary Wharf & Greenwich Sales

Harbour Island
 28 Harbour Exchange Square
 London
 E14 9GE
 canarywharf@chestertons.co.uk
 020 7510 8300
 chestertons.co.uk

Boardwalk Place, E14

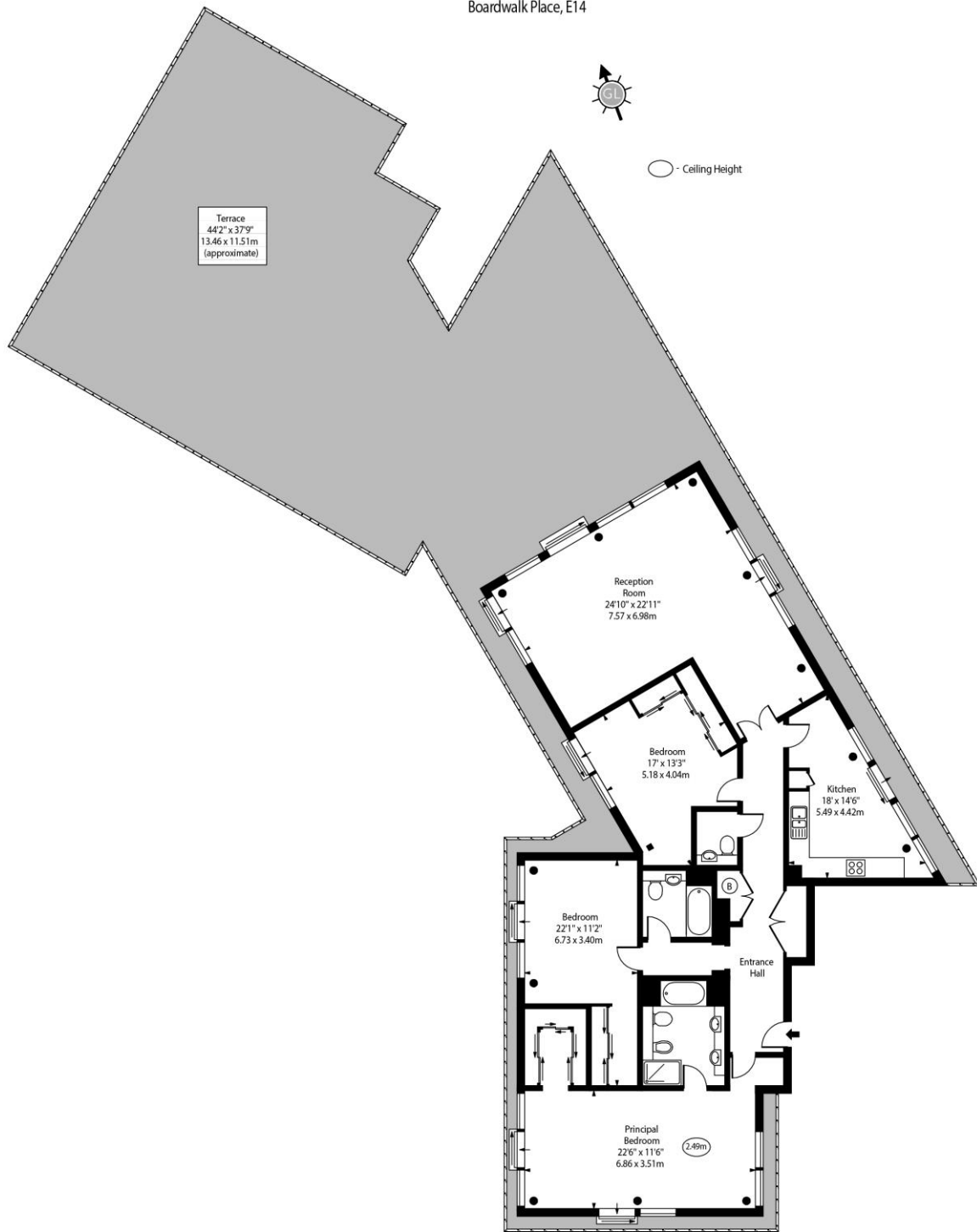

Ninth Floor

Approx Gross Internal Area 1733 Sq Ft - 161.00 Sq M

For Illustration Purposes Only - Not To Scale
www.goldlens.co.uk
Ref. No. 020499E

Chesterton UK Services Limited trading as Chestertons for themselves and for the vendor of this property whose agents they are, give notice that (i) these particulars do not constitute any part of an offer or contract, (ii) all statements contained within these particulars are made without responsibility on the part of Chestertons or the vendor, (iii) whilst made in good faith, none of the statements contained within these particulars are to be relied upon as a statement or representation of fact, (iv) any intending purchasers must satisfy themselves by inspection or otherwise as to the correctness of each of the statements contained within these particulars, (v) the vendor does not make or give either Chestertons or any person in their employment any authority to make or give representation or warranty whatsoever in relation to this property. Wide angle lenses may be used. ©Copyright Chestertons | Chesterton UK Services Limited | Registered Office 40 Connaught Street, Hyde Park, London W2 2AB Registered Company Number 05334580.



This paper is
100% recyclable