



St. Davids Square

London, E14

Asking Price £475,000

This spacious one bedroom apartment in St Davids Square development boasts amazing panoramic views over the River Thames from its corner position in the building. A viewing is highly recommended to appreciate the space, light and view!



St. Davids Square

London, E14

- One bedroom apartment with private balcony and River Thames views
- 24 hour concierge
- Residents gym and swimming pool
- Private parking space
- Superb location near Island Gardens DLR
- The Greenwich foot tunnel is close by
- EWS1 compliant
- Lease length - 972 years approx
- Service charge - £3,934 pa approx
- Ground rent - £300 pa



This spacious one bedroom apartment boasts amazing panoramic views of the River Thames from the lounge and private balcony. When looking North from the balcony you can also see the impressive Canary Wharf skyline.

These corner flats rarely come to the market as they combine a balance of space, light, views and a separate fitted kitchen. The bedroom has bespoke fitted wardrobes to maximise space and the bathroom has been recently refurbished to a high standard.

Residents of the development benefit from twenty-four hour concierge, residents gym and swimming pool. This apartment is located on the 4th floor of the very popular St David's Square development in the heart of Island Gardens. The green open spaces of Millwall Park and Island Gardens are close by. Mudchute and Island Gardens DLR stations are very close by, giving swift access to Canary Wharf within 8 minutes and Bank within 19 minutes. The Greenwich foot tunnel located next to Island Gardens gives residents access to the heart of Greenwich with the markets and many local amenities.

Tenure: Leasehold 972 years 7 months
Service Charge: £3934 approx.
Ground Rent: £300
Local Authority: Tower Hamlets
Council Tax Band: E

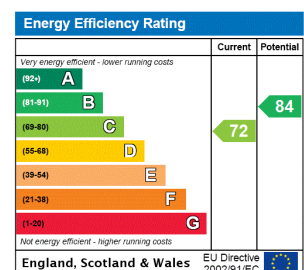

Chestertons Canary Wharf & Greenwich Sales

Harbour Island
 28 Harbour Exchange Square
 London
 E14 9GE
 canarywharf@chestertons.co.uk
 020 7510 8300
 chestertons.co.uk

St. Davids Square, E14

○ - Ceiling Height

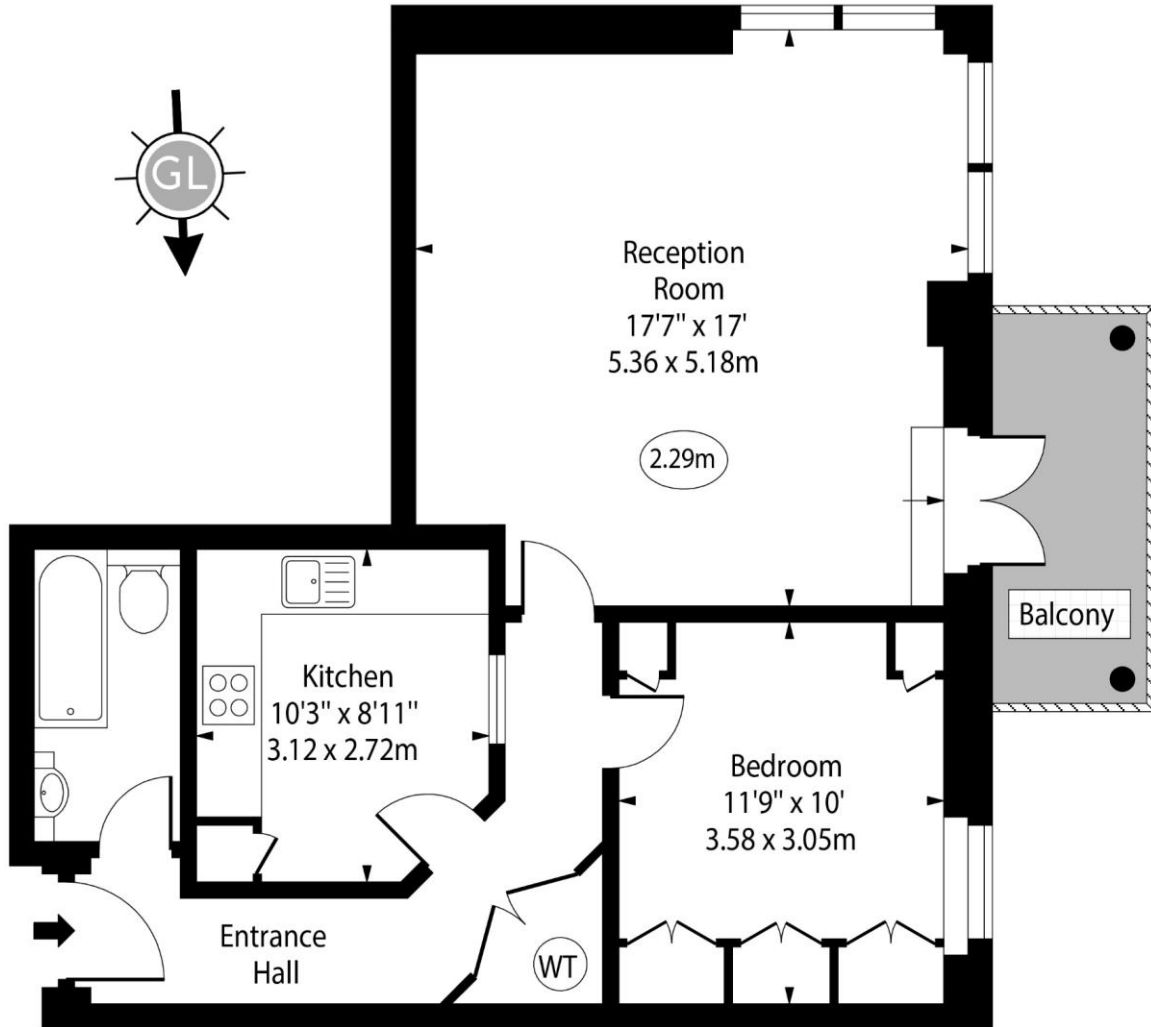

Fourth Floor

Approx Gross Internal Area 646 Sq Ft - 60.01 Sq M

For Illustration Purposes Only - Not To Scale

www.goldlens.co.uk

Ref. No. 023994K

