



Lowry House

Cassilis Road, E14

Asking Price £375,000

A spacious one bedroom apartment situated on the 5th floor of Lowry House on Cassilis Street. The location is ideal being situated 0.3 miles to South Quay DLR. Excellent onsite facilities include: 24hr concierge, residents gym, swimming pool and parking space.



Lowry House

Cassilis Road, E14

- One bedroom apartment
- EWS1 - A1 status
- Allocated parking space
- 5th floor
- 976 Years remaining on lease
- Service charge £2,785 per annum approx.
- Private South facing balcony
- Excellent on-site facilities include: 24hr concierge, residents' gym and swimming pool.
- 0.3 miles to South Quay DLR
- 0.5 miles to Canary Wharf Jubilee Line



A spacious one bedroom apartment situated on the 5th floor of Lowry House on Cassilis Street.

The property has a large reception room with floor to ceiling patio doors leading to a south facing private balcony. There is ample storage throughout the apartment and the kitchen comes equipped with built-in appliances.

Residents have the benefit of making use of the on-site leisure facilities that include a fabulous indoor heated pool, sauna and a fully equipped gym. The development has the added benefit of a 24 hour concierge.

The location is ideal being situated 0.3 miles to South Quay DLR and 0.5 miles to the Jubilee Line at Canary Wharf.

Tenure:	Leasehold – 976 years remaining approx.
Service Charge:	£2,785pa approx.
Ground Rent:	£250pa such sum to double on every twenty-fifth anniversary
Local Authority:	Tower Hamlets
Council Tax Band:	D

Energy Efficiency Rating		
	Current	Potential
Very energy efficient - lower running costs		
A (92-100)		
B (81-91)		
C (69-80)	75	76
D (55-68)		
E (39-54)		
F (21-38)		
G (1-20)		
Not energy efficient - higher running costs		
England, Scotland & Wales EU Directive 2002/91/EC		

Chestertons Canary Wharf & Greenwich Sales

Harbour Island
 28 Harbour Exchange Square
 London
 E14 9GE
canarywharf@chestertons.co.uk
 020 7510 8300
chestertons.co.uk

Lowry House, Cassilis Road, E14

○ - Ceiling Height

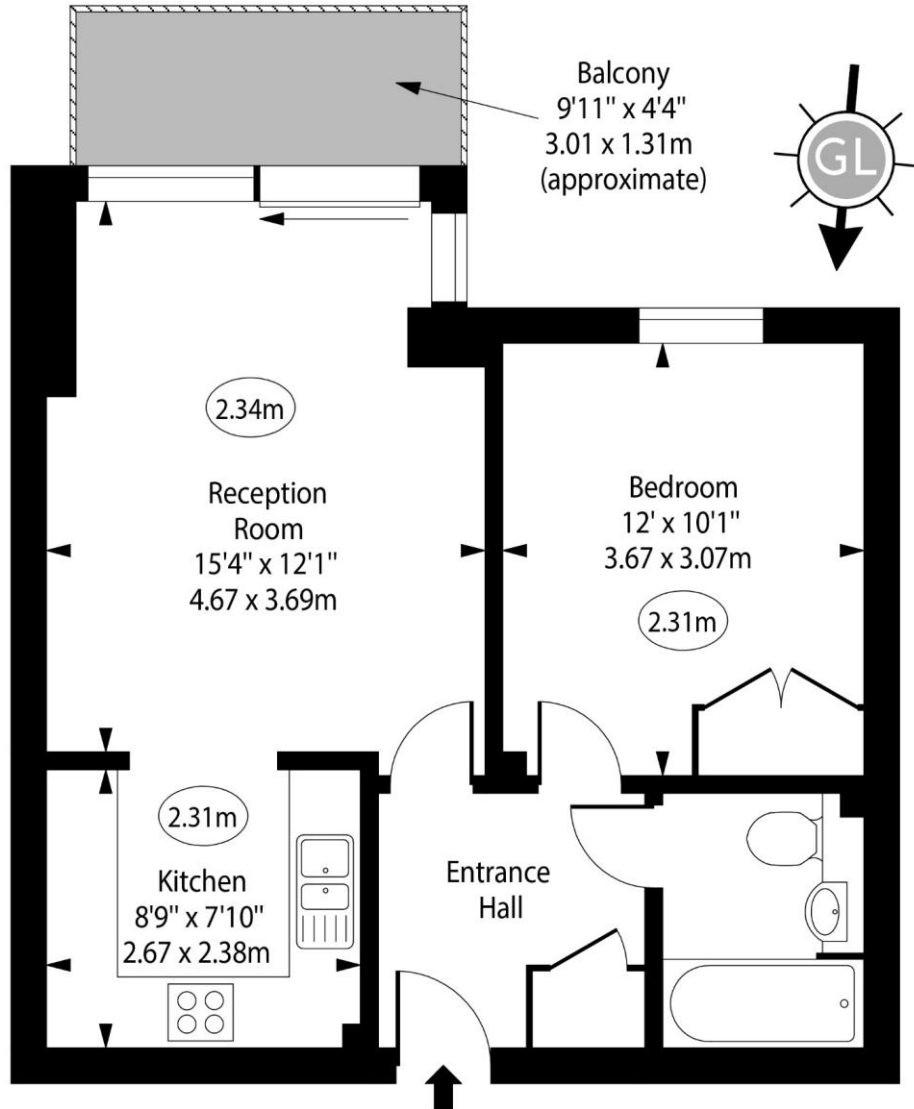

Fifth Floor

Approx Gross Internal Area 478 Sq Ft - 44.41 Sq M

For Illustration Purposes Only - Not To Scale

www.goldlens.co.uk

Ref. No. 023535R

