



# Wotton Court

6 Jamestown Way, E14

Asking Price £650,000

A beautifully presented, southeast-facing, 10th floor, two bedroom apartment in the ever-popular Virginia Quay development, with stunning views over the O2 and River Thames from a generous balcony & an allocated parking space.



# Wotton Court

## 6 Jamestown Way, E14

- Tenth Floor
- Private Balcony
- Excellent River Views
- 943sq ft Internal Space
- Two Bathrooms
- Located within 200m of East India DLR Station





This terrific two bedroom, two bathroom apartment offers nearly 950sq ft of internal living space and offers commanding views over the River Thames. Accommodation consists of a generous living room with plenty of space for a separate dining arrangement and direct access onto the private balcony, a fully fitted modern kitchen, two large fantastic double bedrooms both with views to the river, one with an en-suite and a separate main bathroom. The property also benefits from a secure allocated parking space within Wotton Court.

Wotton Court is located within 200 metres of East India DLR station for easy access to Canary Wharf & The City. Virginia Quay benefits from 24 hour porterage & controlled vehicle access. The property is offered chain-free.

---

**Tenure:** Leasehold 973 years

**Service Charge:** £4289 pa approx. Reviewed annually

**Ground Rent:** £324 pa. Reviewed every 21 years in line with the commencement date

**Local Authority:** Tower Hamlets

**Council Tax Band:** F

---

### *Chestertons Canary Wharf & Greenwich Sales*

Harbour Island

28 Harbour Exchange Square

London

E14 9GE

canarywharf@chestertons.co.uk

020 7510 8300

chestertons.co.uk

Wotton Court,  
Jamestown Way, E14

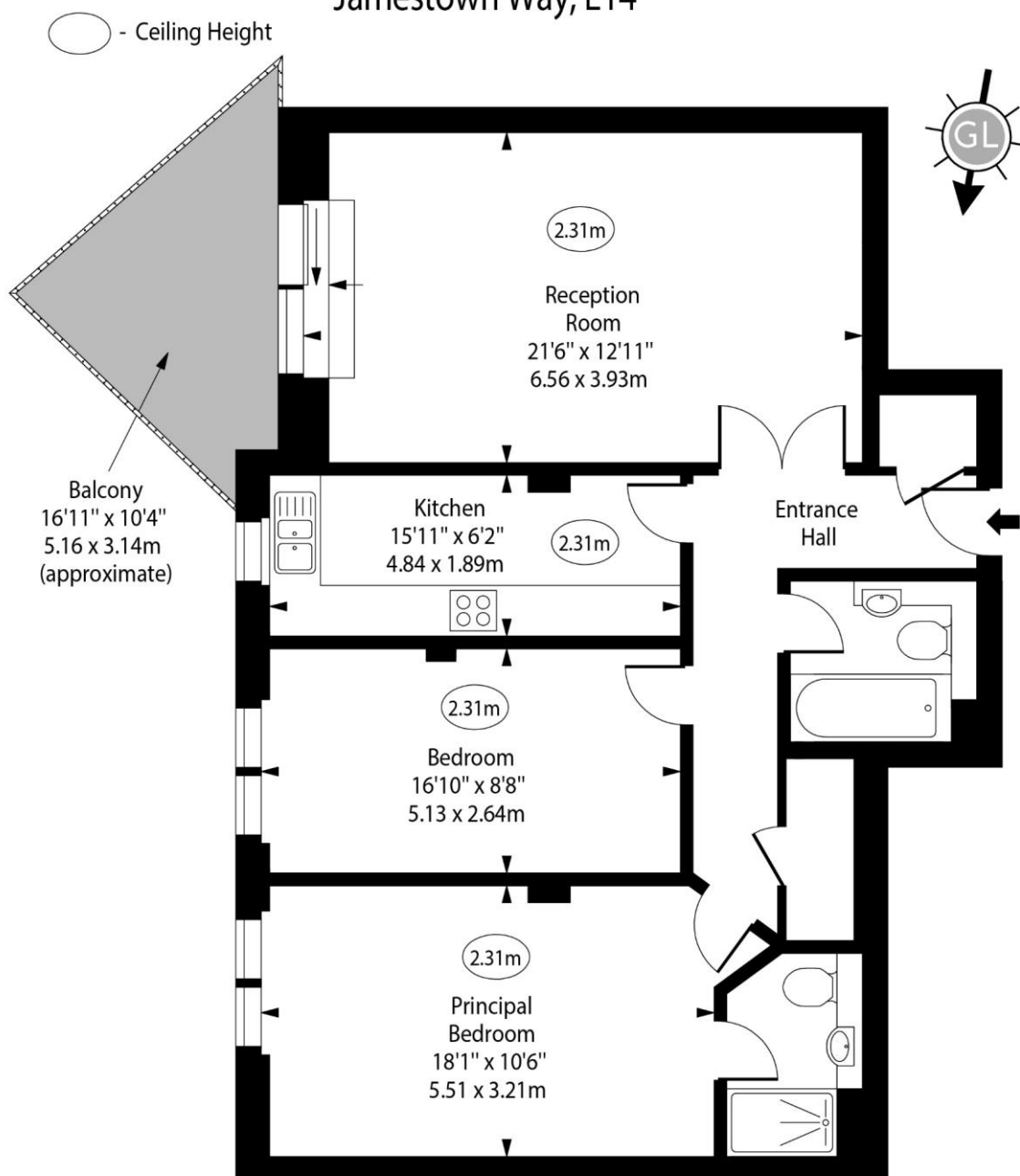

Tenth Floor

Approx Gross Internal Area      943 Sq Ft - 87.60 Sq M

For Illustration Purposes Only - Not To Scale

[www.goldlens.co.uk](http://www.goldlens.co.uk)

Ref. No. 023246R

