



# Jessop Building

## 14 Dominion Walk, E14

Offers in excess of £425,000

A West-facing 2 bedroom apartment with open-plan kitchen in the Jessop Building at New Providence Wharf. The property benefits from an excellent location close to Canary Wharf, & Blackwall DLR station is nearby for easy access to The City.



# Jessop Building

## 14 Dominion Walk, E14

- 2 bedroom 2nd floor apartment.
- West-facing aspect with views of Canary Wharf
- Open-plan kitchen/reception
- Close to Blackwall DLR station.
- Local amenities nearby
- EWS1 compliant
- Ground Rent- £200 p.a
- Service charge -£2,992 p.a approx.



This West-facing 2 bedroom apartment features an open-plan kitchen/reception room with views of Canary Wharf and 2 double bedrooms.

Jessop Building is located at New Providence Wharf. The property benefits from an excellent location close to Canary Wharf and Blackwall DLR station is nearby for easy access to The City.

**Tenure:** Leasehold 116 years  
**Service Charge:** £2992 approx.  
**Ground Rent:** £200 Ground rent doubles every 25 years  
**Local Authority:** Tower Hamlets  
**Council Tax Band:** E

Energy Efficiency Rating		
	Current	Potential
Very energy efficient - lower running costs		
<b>A</b> (94-100)		
<b>B</b> (81-93)	83	83
<b>C</b> (69-80)		
<b>D</b> (55-68)		
<b>E</b> (39-54)		
<b>F</b> (21-38)		
<b>G</b> (1-20)		
Not energy efficient - higher running costs		
England, Scotland & Wales EU Directive 2002/91/EC		

### *Chestertons Canary Wharf & Greenwich Sales*

Harbour Island  
 28 Harbour Exchange Square  
 London  
 E14 9GE  
 canarywharf@chestertons.co.uk  
 020 7510 8300  
 chestertons.co.uk



Jessop Building,  
Dominion Walk, E14

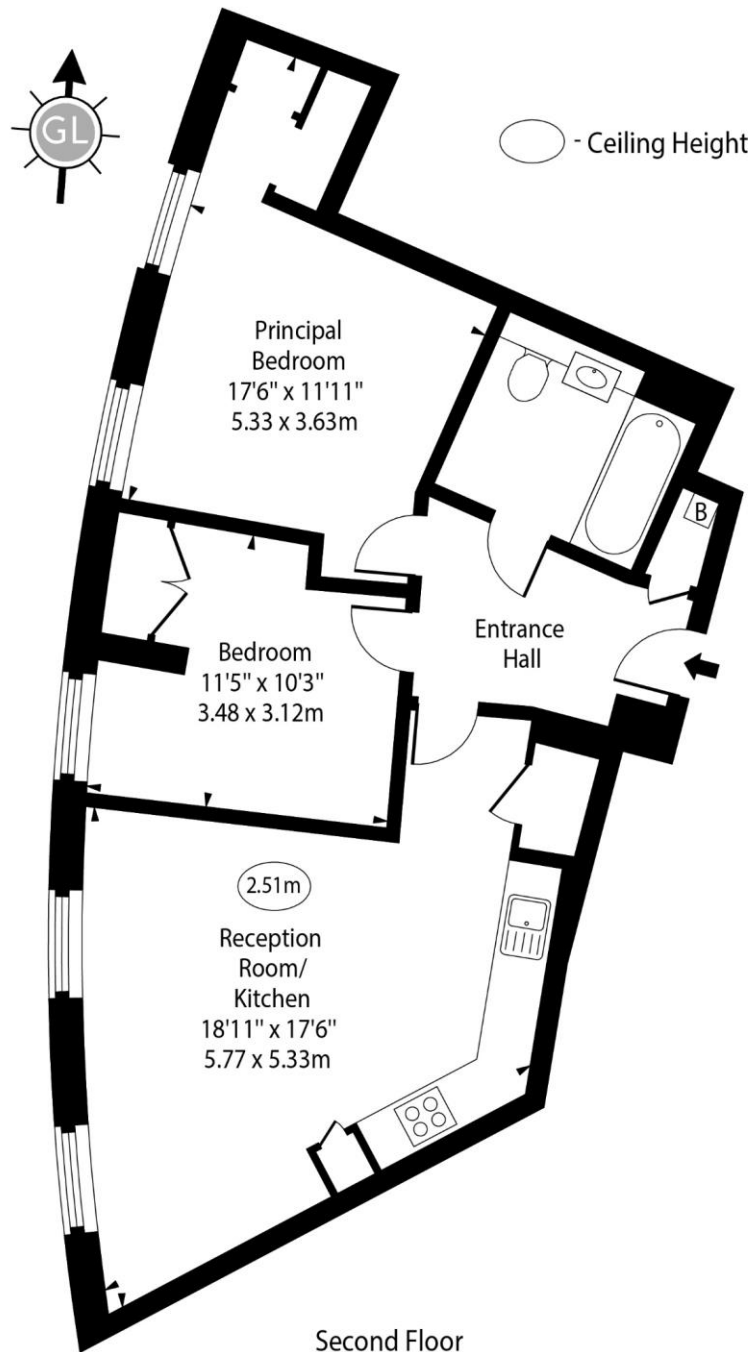

Second Floor

Approx Gross Internal Area      682 Sq Ft - 63.36 Sq M

For Illustration Purposes Only - Not To Scale

[www.goldlens.co.uk](http://www.goldlens.co.uk)

Ref. No. 020708K

