



Chipka Street

London, E14

Asking Price £599,000

A two bed end of terrace house with potential for extending. Located just off Marsh Wall in the Isle of Dogs close to South Quay DLR station.



Chipka Street

London, E14

- 2 bedroom end of terrace house
- Potential for extending at the rear and loft
- Close to South Quay DLR
- Private garden



This two bedroom house offers 764sq ft of space and has the potential to be extended at the rear and the loft space to be converted.

The house is located close to South Quay DLR Station and a short walk from the heart of Canary Wharf.

The land located next door has planning permission to build a house on it.

Tenure: Freehold
Service Charge: £0
Ground Rent: £0
Local Authority: Tower Hamlets
Council Tax Band: D

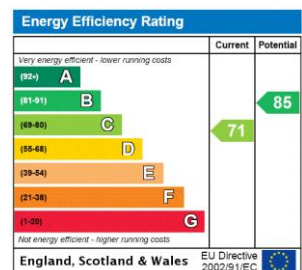

Chestertons Canary Wharf & Greenwich Sales

Harbour Island
 28 Harbour Exchange Square
 London
 E14 9GE
 canarywharf@chestertons.co.uk
 020 7510 8300
 chestertons.co.uk

Chipka Street, E14



○ - Ceiling Height

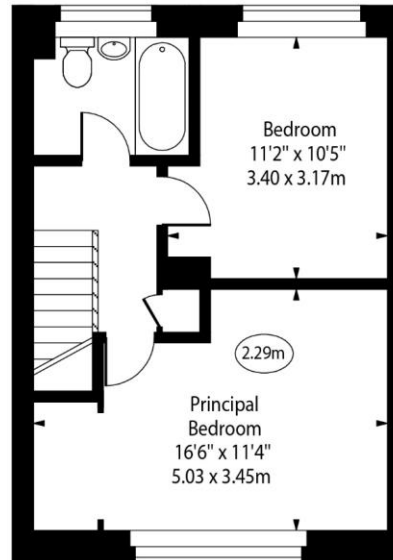
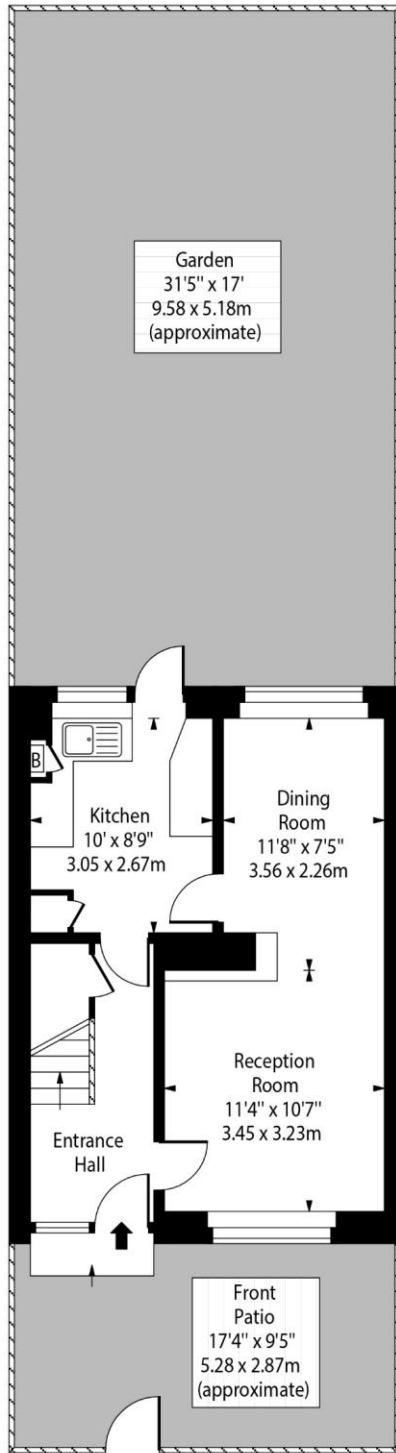

Ground Floor

First Floor

Approx Gross Internal Area

764 Sq Ft - 70.98 Sq M

For Illustration Purposes Only - Not To Scale

www.goldlens.co.uk

Ref. No. 021289K

