



# Millharbour

London, E14

Offers in excess of £365,000

A 500sq ft 1 bedroom apartment in the well-located 41 Millharbour development in the heart of South Quay, close to Canary Wharf.





# Millharbour

London, E14

- 485sq ft ground floor 1 bedroom apartment.
- Opens out onto the secure communal courtyard / decked area.
- Sought-after South Quay location.
- Modern block with 24 hour concierge.
- EWS1 B2 - Freeholder has confirmed no costs for remediation works will be passed to leaseholders





A 485sq ft 1 bedroom apartment in the well-located 41 Millharbour development in the heart of South Quay.

The property is in good internal condition and benefits from a large kitchen open-plan to the reception room. The reception room opens out onto the secure, communal gardens which are only accessible by the developments' residents on the 1st floor of the building.

41 Millharbour benefits from 24 hour concierge.

The building currently has a B2-rated EWS1 form, however, the developer (Weston Homes) has committed to covering the cost of the remediation works required in order to achieve a B1 EWS1 rating and as such the building should be suitable for mortgage lending. Prospective buyers should check with their mortgage provider as to their criteria and requirements.

The service charges include the communally-provided heating and hot (& cold) water.

**Tenure:** Leasehold 977 years 6 months

**Service Charge:** £5000 approx.

**Ground Rent:** £200 "the Review Period" is each successive period of twenty five years

**Local Authority:** Tower Hamlets

**Council Tax Band:** D

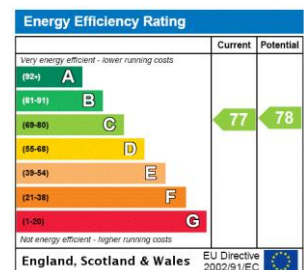

### Chestertons Canary Wharf & Greenwich Sales

Harbour Island  
 28 Harbour Exchange Square  
 London  
 E14 9GE  
 canarywharf@chestertons.co.uk  
 020 7510 8300  
 chestertons.co.uk

# Millharbour, E14

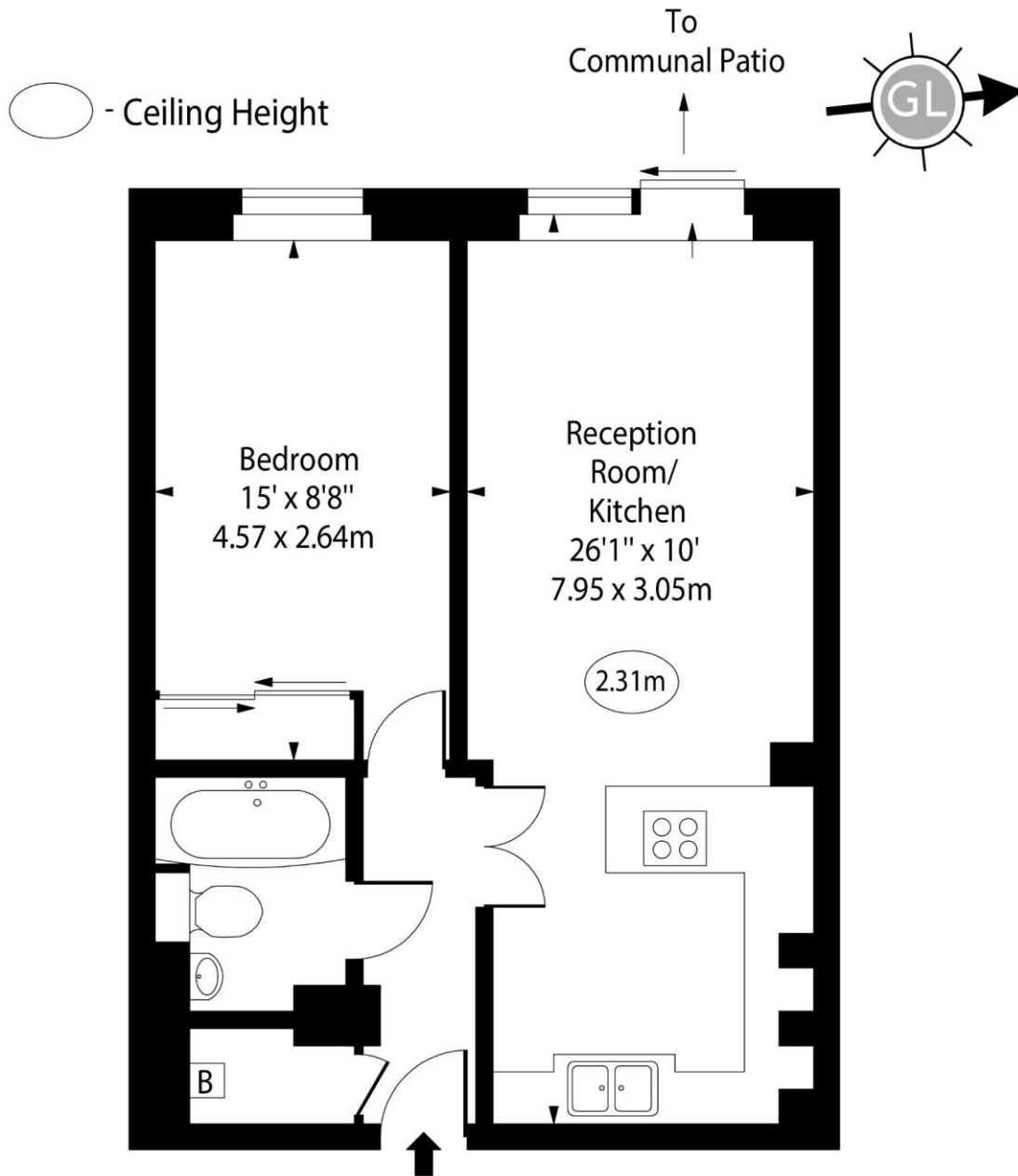

Ground Floor

Approx Gross Internal Area 485 Sq Ft - 45.06 Sq M

For Illustration Purposes Only - Not To Scale

[www.goldlens.co.uk](http://www.goldlens.co.uk)

Ref. No. 020960K

