



Telegraph Place

London, E14

Asking Price £310,000

A bijou top (2nd) floor 1 bedroom apartment with a south-facing reception room in a low-rise, low-density brick-built development located very close to Mudchute DLR station. Mill Quay benefits from residents' parking & a quiet location.



Telegraph Place

London, E14

- 417sq ft 2nd floor 1 bedroom apartment.
- Top floor; South-facing reception room.
- Separate kitchen.
- Quiet residential development.
- Located close to Mudchute DLR station.
- Extended lease.



A bijou top (2nd) floor 1 bedroom apartment with a south-facing reception room in a low-rise, low-density brick-built development located very close to Mudchute DLR station. Mill Quay benefits from residents' parking & a quiet location.

Tenure: Leasehold 115 years approx. remaining
Service Charge: £2,040 pa approx.
Ground Rent: £200 pa increase in accordance to terms laid in lease
Local Authority: Tower Hamlets
Council Tax Band: C

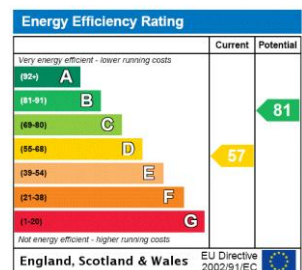

Chestertons Canary Wharf & Greenwich Sales

Harbour Island
 28 Harbour Exchange Square
 London
 E14 9GE
 canarywharf@chestertons.co.uk
 020 7510 8300
 chestertons.co.uk

Telegraph Place, E14

○ - Ceiling Height

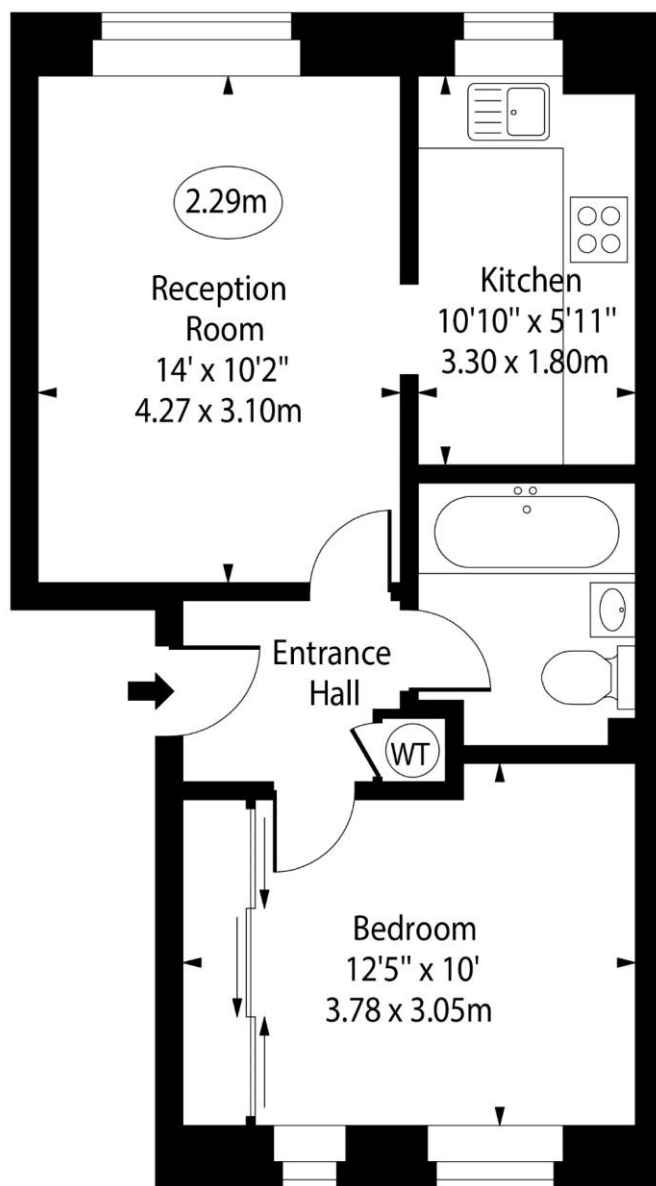

Second Floor

Approx Gross Internal Area 417 Sq Ft - 38.74 Sq M

For Illustration Purposes Only - Not To Scale

www.goldlens.co.uk

Ref. No. 017557K

