



OFFERS OVER

**£450,000**

**Viscount Close**

Newcastle Upon Tyne, NE27 0FP



Fresh Property Centre are pleased to present this exquisite detached house on Viscount Close, Earsdon View. With four generously sized double bedrooms, two of which boast their own ensembles, this property is ideal for families seeking both space and privacy.

The heart of the home is a beautifully presented kitchen, featuring elegant stone worktops and a central island, perfect for culinary enthusiasts and social gatherings alike. The open-plan design seamlessly connects the kitchen to the dining space and family room, creating a warm and inviting atmosphere for entertaining guests or enjoying family time. To the front of the property is an additional lounge.

Outside, the property is complemented by pleasant gardens that provide a tranquil retreat, ideal for relaxation or outdoor activities. A driveway offers convenient parking for two cars and leads to a garage, providing additional storage options.

This rare opportunity to acquire such a well-appointed home in a desirable location should not be missed. Viewing is highly recommended to fully appreciate the quality and charm this property has to offer.

4



3



3















**LOCAL AUTHORITY**

North tyneside

**TENURE**

Freehold

**COUNCIL TAX BAND**

C

**VIEWINGS**

By prior appointment only

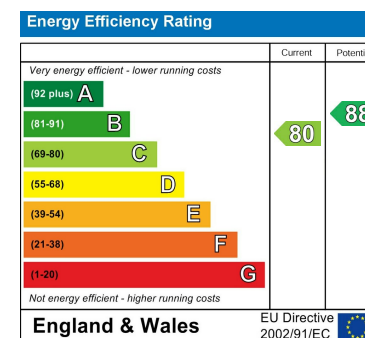
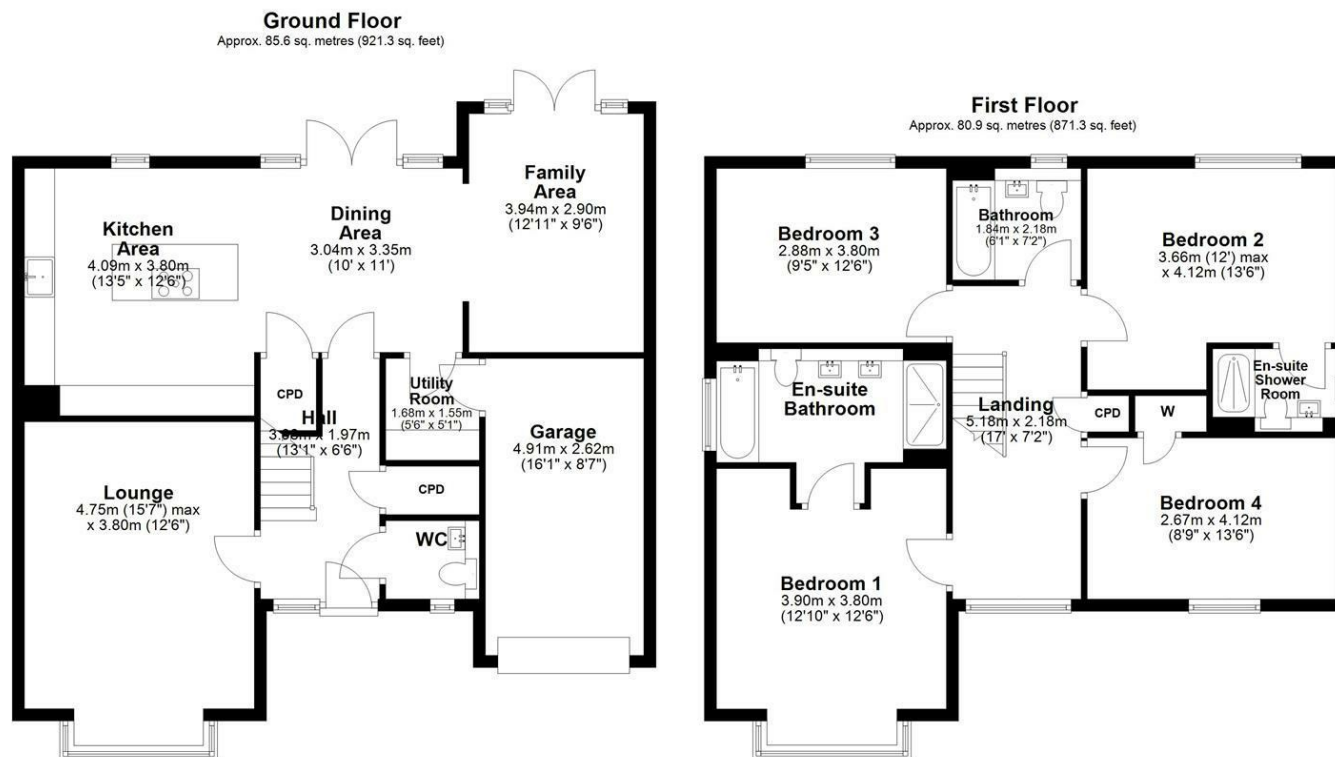

Agents Note: Whilst every care has been taken to prepare these particulars, they are for guidance purposes only. All measurements are approximate and are for general guidance purposes only and whilst every care has been taken to ensure their accuracy, they should not be relied upon and potential buyers/tenants are advised to recheck the measurements

**OFFICE ADDRESS**

63 Church Way  
North Shields  
Tyne & Wear  
NE29 0AE

**OFFICE DETAILS**

0191 257 6823  
hello@fresh.property  
www.freshpropertycentre.co.uk