



ASKING PRICE

£195,000

Grosvenor Place

North Shields, NE29 0NH

PROPERTY SUMMARY

Nestled in the heart of North Shields with easy access to local amenities, schools, and transport links, this terraced house on Grosvenor Place presents an opportunity for those seeking a project to transform a property.

The property features, an entrance hall, two inviting reception rooms, plus a dining kitchen. To the first floor there are three bedrooms and a family bathroom/WC. Externally the property boasts a quaint town garden and a rear yard.

While the house requires a full refurbishment, it has the potential to be a well proportioned family home.

3



1



2





LOCAL AUTHORITY
North Tyneside Council

TENURE
Freehold

COUNCIL TAX BAND
C

VIEWINGS
By prior appointment only

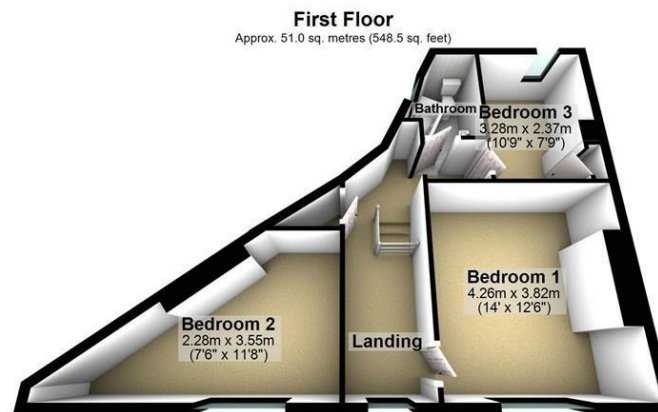
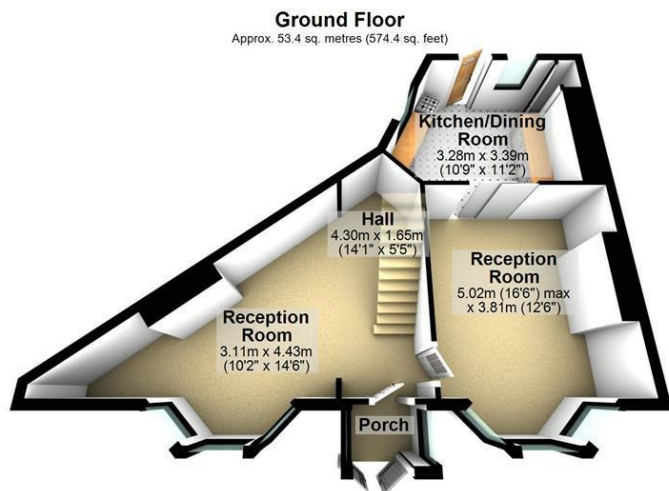

Total area: approx. 104.3 sq. metres (1122.9 sq. feet)

Energy Efficiency Rating		
	Current	Potential
Very energy efficient - lower running costs		
(92 plus) A		91
(81-91) B		
(69-80) C	71	
(55-68) D		
(39-54) E		
(21-38) F		
(1-20) G		
Not energy efficient - higher running costs		
England & Wales	EU Directive 2002/91/EC	

Agents Note: Whilst every care has been taken to prepare these particulars, they are for guidance purposes only. All measurements are approximate and are for general guidance purposes only and whilst every care has been taken to ensure their accuracy, they should not be relied upon and potential buyers/tenants are advised to recheck the measurements



OFFICE ADDRESS
63 Church Way
North Shields
Tyne & Wear
NE29 0AE

OFFICE DETAILS
0191 257 6823
hello@fresh.property
www.freshpropertycentre.co.uk