

ASKING PRICE

**£325,000**

**Devonshire Terrace**

Whitley Bay, NE26 2EJ



## PROPERTY SUMMARY

Fresh Property Centre are delighted to offer for sale this period home situated on Devonshire Terrace, Whitley Bay. The accommodation comprises; entrance porch, entrance hall, lounge with feature log burner, dining room and spacious modern kitchen. To the first floor there are three bedrooms and a four piece bathroom. Externally there is a pleasant garden to the front and a yard to the rear. Ideally located with good access to whitley bay town centre the metro and a short walk to the beaches. Viewing is essential.

3



1



2









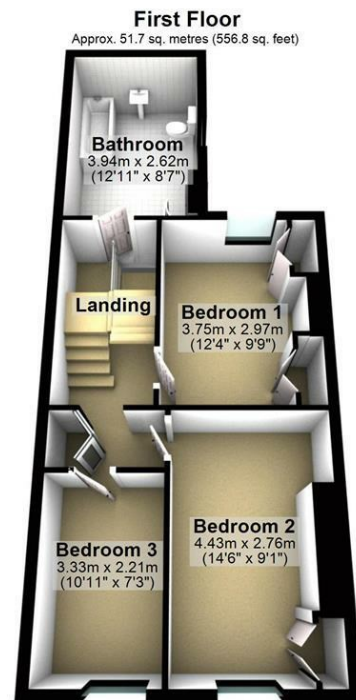
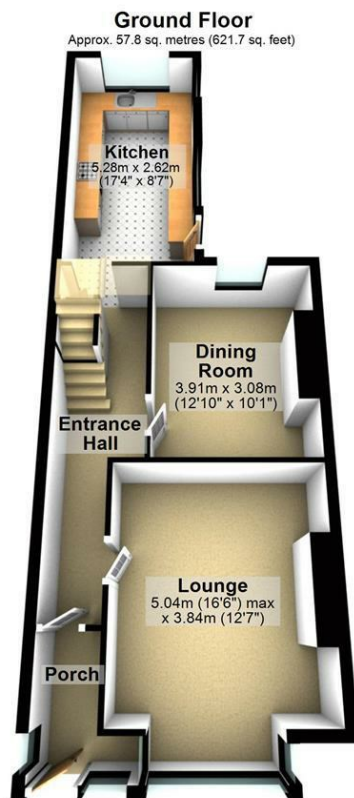

Total area: approx. 135.3 sq. metres (1456.5 sq. feet)

**LOCAL AUTHORITY**  
North Tyneside Council

**TENURE**  
Freehold

**COUNCIL TAX BAND**  
B

**VIEWINGS**  
By prior appointment only

Energy Efficiency Rating		
	Current	Potential
Very energy efficient - lower running costs		
(92 plus) <b>A</b>		
(81-91) <b>B</b>		78
(69-80) <b>C</b>		
(55-68) <b>D</b>	55	
(39-54) <b>E</b>		
(21-38) <b>F</b>		
(1-20) <b>G</b>		
Not energy efficient - higher running costs		
<b>England &amp; Wales</b>	EU Directive 2002/91/EC	

Agents Note: Whilst every care has been taken to prepare these particulars, they are for guidance purposes only. All measurements are approximate and are for general guidance purposes only and whilst every care has been taken to ensure their accuracy, they should not be relied upon and potential buyers/tenants are advised to recheck the measurements



**OFFICE ADDRESS**  
63 Church Way  
North Shields  
Tyne & Wear  
NE29 0AE

**OFFICE DETAILS**  
0191 257 6823  
hello@fresh.property  
www.freshpropertycentre.co.uk