



Etal Court

North Shields, NE29 0HH

Fresh Property Centre welcomes to the market this two bedroom, first floor apartment situated in Etal Court, North Shields. The accommodation comprises; communal entrance, entrance hall, lounge/dining room, kitchen, two double bedrooms and a bathroom/WC. Externally there are communal gardens, a drying area and residents parking. The property requires some modernisation but does benefit from gas central heating and double glazing. Available with immediate vacant possession.



Asking Price £105,000



0191 257 6823

www.fresh.property

hello@fresh.property

63 Church Way, North Shields, Tyne & Wear, NE29 0AE



Zoopla

rightmove

PrimeLocation

OnTheMarket.com

Fresh Property Centre welcomes to the market this two bedroom, first floor apartment situated in Etal Court, North Shields. The accommodation comprises; communal entrance, entrance hall, lounge/dining room, kitchen, two double bedrooms and a bathroom/WC. Externally there are communal gardens, a drying area and residents parking. The property requires some modernisation, but does benefit from gas central heating and double glazing. Available with immediate vacant possession.

Communal Entrance

Via secure entry system.

Entrance Hall

Secure entry phone.

Lounge

Feature fireplace with electric fire, radiator and double glazed window.



Bedroom One

Built in wardrobes, radiator and double glazed window.



Bedroom Two

Radiator and double glazed window.



Kitchen

Matching base and wall units with work surfaces over, stainless steel sink with drainer and mixer tap, plumbing for a washing machine, central heating boiler, built in cupboard and double glazed window.



0191 257 6823

www.fresh.property

hello@fresh.property

63 Church Way, North Shields, Tyne & Wear, NE29 0AE



Zoopla

rightmove

PrimeLocation

OnTheMarket.com

Bathroom

Three piece bathroom suite comprising; panelled bath with shower over, pedestal hand wash basin and low level WC. Part tiled walls, radiator and frosted double glazed window.



Externally

Communal gardens, communal drying area, residents parking.



Please Note: All measurements are approximate and quoted in metric with imperial equivalents and for general guidance only and whilst every attempt has been made to ensure accuracy, they must not be relied on. The fixtures, fittings and appliances referred to have not been tested and therefore no guarantee can be given that they are in working order. Internal photographs are reproduced for general information and it must not be inferred that any item shown is included with the property.

Thinking of Moving?

Fresh can help you;

- Sell your home
- Arrange a mortgage
- Select a local solicitor

Call our team to see how we can help

0191 257 6823

www.fresh.property

hello@fresh.property

63 Church Way, North Shields, Tyne & Wear, NE29 0AE



Zoopla

rightmove

PrimeLocation

OnTheMarket.com

First Floor

Approx. 60.5 sq. metres (651.2 sq. feet)

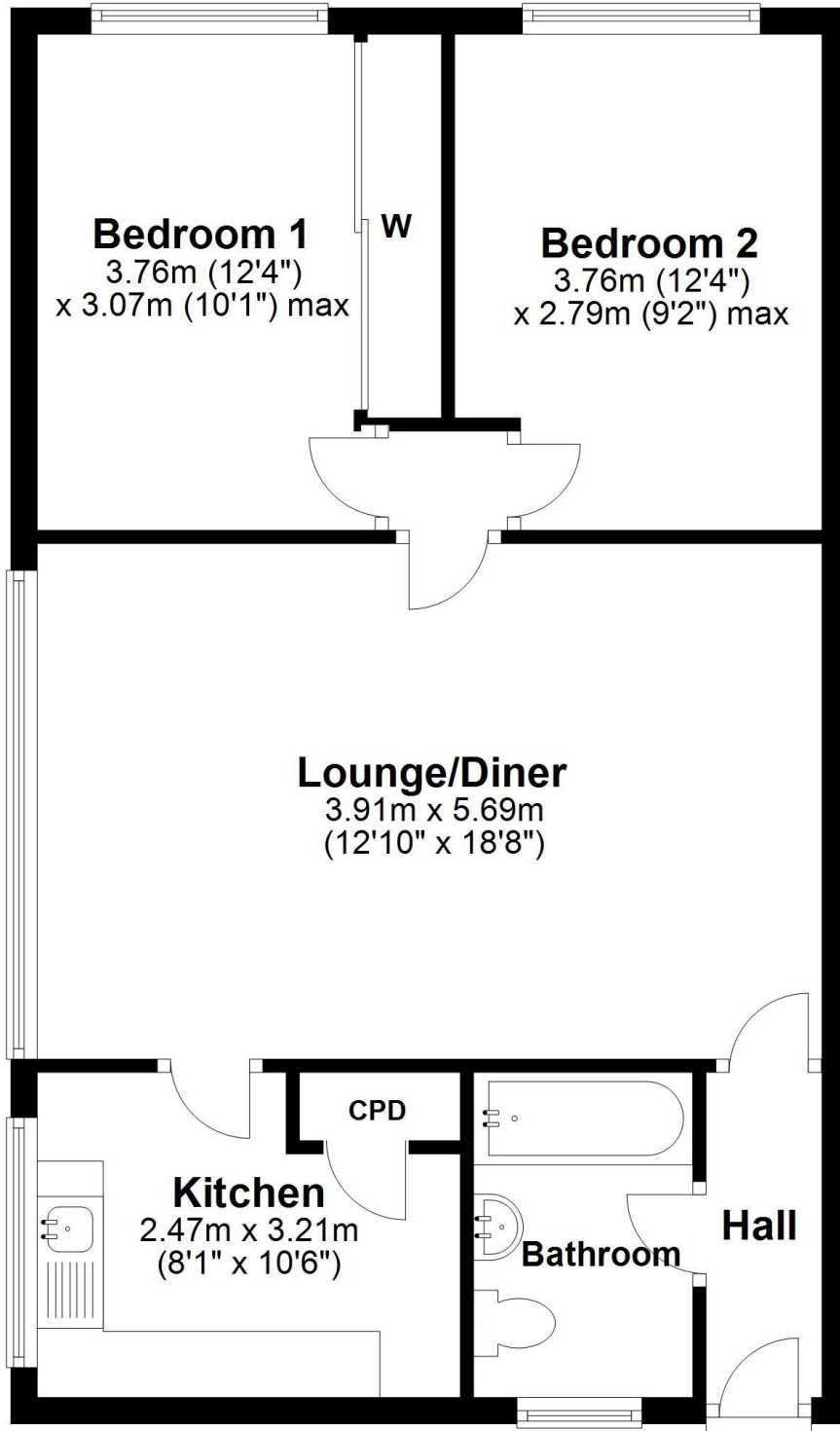

Total area: approx. 60.5 sq. metres (651.2 sq. feet)

The floor plan is for illustrative purposes and is not to scale. Where measurements are shown, these are approximate and should not be relied upon. Sanitary ware and kitchen fittings are representative only and approximate to actual position, shape and style. No liability is accepted in respect of any consequential loss arising from the use of this plan.

0191 257 6823

www.fresh.property

hello@fresh.property

63 Church Way, North Shields, Tyne & Wear, NE29 0AE



Zoopla

rightmove

PrimeLocation

onTheMarket.com