



Morpeth Terrace North Shields, NE29 7AN

We are pleased to offer to the market this two bedroom upper Tyneside flat situated on Morpeth Terrace, North Shields. The accommodation comprises; entrance lobby, landing, lounge/dining room with wood burner, modern kitchen, two bedrooms, rear lobby and bathroom/WC. Eternally there is a yard to the rear. Tastefully presented and benefiting from gas central heating and double glazing, the property would make an ideal first time buy.

£79,950



0191 257 6823

www.fresh.property

hello@fresh.property

63 Church Way, North Shields, Tyne & Wear, NE29 0AE



Zoopla

rightmove

PrimeLocation

OnTheMarket.com

We are pleased to offer to the market this two bedroom upper Tyneside flat situated on Morpeth Terrace, North Shields. The accommodation comprises; entrance lobby, landing, lounge/dining room with wood burner, modern kitchen, two bedrooms, rear lobby and bathroom/WC. Eternally there is a yard to the rear. Tastefully presented and benefiting from gas central heating and double glazing, the property would make an ideal first time buy.

Entrance Lobby

Stairs to first floor.

First Floor Landing

Radiator and loft access.

Lounge/Diner

Log burner, dado rail, wall lights, two radiators, two double glazed windows to rear.



Kitchen

Modern matching base and wall units with work surfaces over, sink with drainer and mixer tap, built in oven, four ring gas hob, extractor fan over, integrated dish washer, integrated fridge freezer and plumbing for a washing machine. Cupboard housing combi boiler, double glazed window to side.



Bedroom One

Dado rail, picture rail, coving to ceiling, radiator and two double glazed windows to front.



0191 257 6823

www.fresh.property

hello@fresh.property

63 Church Way, North Shields, Tyne & Wear, NE29 0AE



Zoopla

rightmove

PrimeLocation

OnTheMarket.com

Bedroom Two

Dado rail, radiator and double glazed window to front.



Yard

Gate to lane.



Rear Lobby

Built in cupboard, double glazed door to rear stairs.

Bathroom/WC

Three piece bathroom suite comprising; panelled bath with shower over, pedestal hand wash basin and low level WC. Tiled walls, spotlighting and frosted double glazed window.



Score	Energy rating	Current	Potential
92+	A		
81-91	B		
69-80	C	69 C	75 C
55-68	D		
39-54	E		
21-38	F		
1-20	G		

Please Note: All measurements are approximate and quoted in metric with imperial equivalents and for general guidance only and whilst every attempt has been made to ensure accuracy, they must not be relied on. The fixtures, fittings and appliances referred to have not been tested and therefore no guarantee can be given that they are in working order. Internal photographs are reproduced for general information and it must not be inferred that any item shown is included with the property.

Thinking of Moving?

Fresh can help you;

- Sell your home
- Arrange a mortgage
- Select a local solicitor

Call our team to see how we can help

0191 257 6823

www.fresh.property

hello@fresh.property

63 Church Way, North Shields, Tyne & Wear, NE29 0AE



Zoopla

rightmove

PrimeLocation

onTheMarket.com

First Floor

Approx. 67.9 sq. metres (730.5 sq. feet)

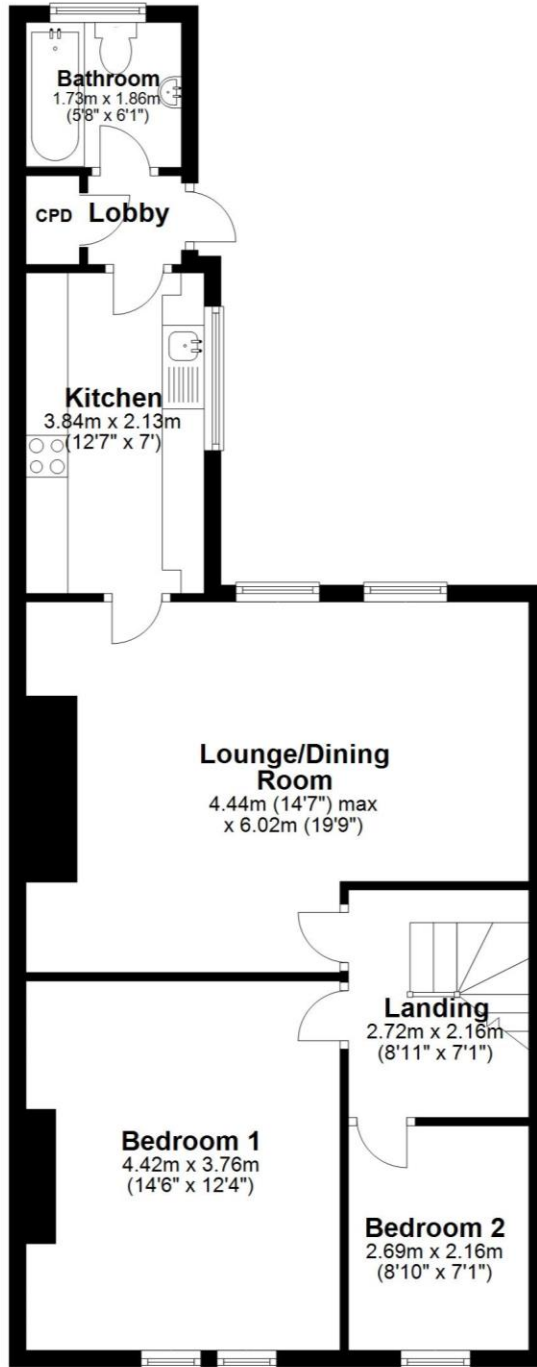

Total area: approx. 67.9 sq. metres (730.5 sq. feet)

The floor plan is for illustrative purposes and is not to scale. Where measurements are shown, these are approximate and should not be relied upon. Sanitary ware and kitchen fittings are representative only and approximate to actual position, shape and style. No liability is accepted in respect of any consequential loss arising from the use of this plan.

0191 257 6823

www.fresh.property

hello@fresh.property

63 Church Way, North Shields, Tyne & Wear, NE29 0AE



Zoopla

rightmove

PrimeLocation

onTheMarket.com