

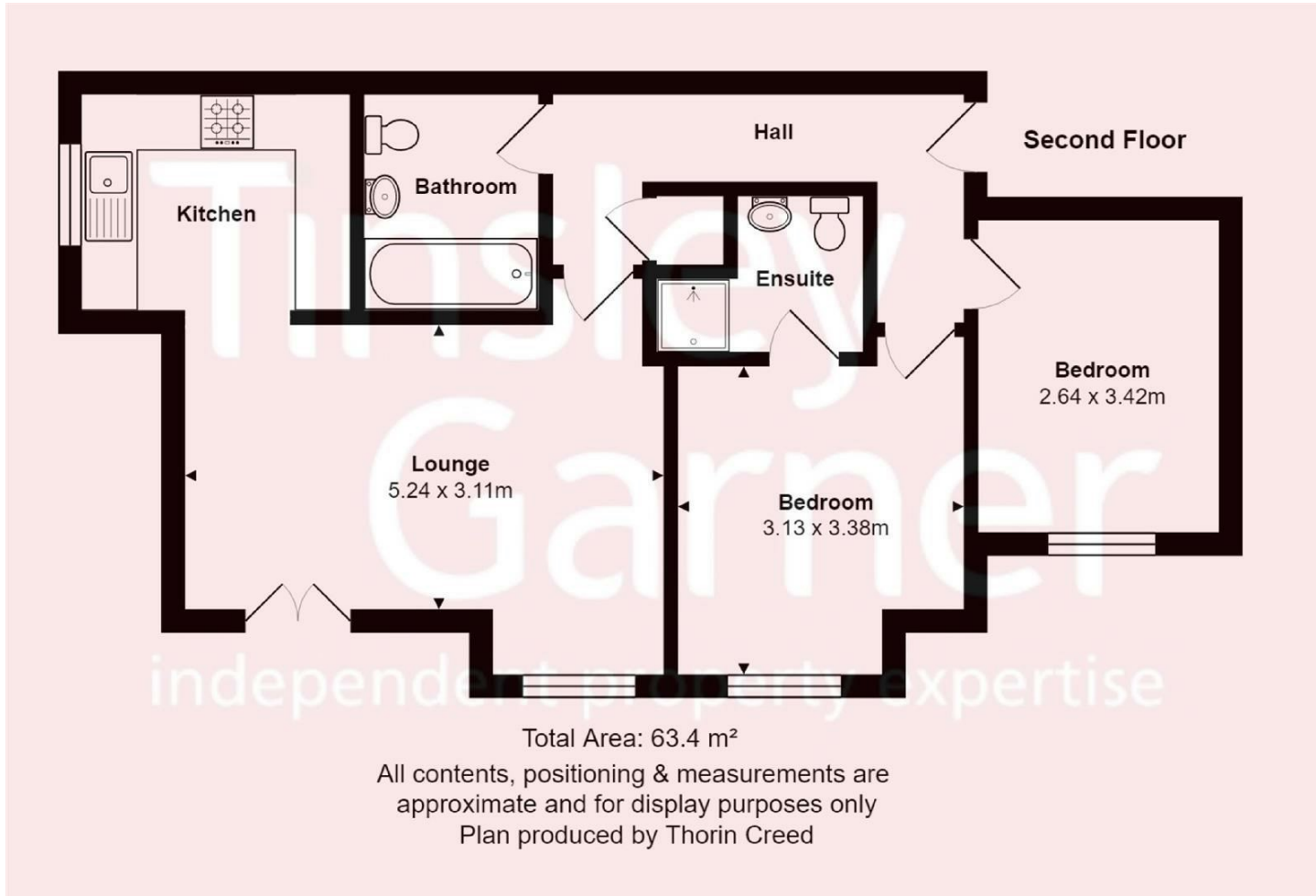

30 Millstone Court, Stone, Staffordshire, ST15 8AY

READY FOR IMMEDIATE OCCUPATION! This stylish second floor apartment is an absolute gem. Located on a popular modern development which is quite literally skipping distance from Stone's vibrant town centre and all the delights the town has to offer. Good size accommodation featuring open plan living space with Juliet balcony, separate kitchen with a full range of fitted appliances, two bedrooms, en-suite and guest bathroom. The apartment is situated on the quieter side of the building Gas central heating, upvc double glazing, tidy decor throughout, what more could you possibly need? AVAILABLE IMMEDIATELY. NO CHAIN

£895 Per Month



Energy Efficiency Rating		Current	Potential
Very energy efficient - lower running costs			
(92 plus) A			
(81-91) B			
(69-80) C			
(55-68) D			
(39-54) E			
(21-38) F			
(1-20) G			
Not energy efficient - higher running costs			
England & Wales		1	1
		EU Directive 2002/91/EC	

Environmental Impact (CO ₂) Rating		Current	Potential
Very environmentally friendly - lower CO ₂ emissions			
(92 plus) A			
(81-91) B			
(69-80) C			
(55-68) D			
(39-54) E			
(21-38) F			
(1-20) G			
Not environmentally friendly - higher CO ₂ emissions			
England & Wales		1	1
		EU Directive 2002/91/EC	