



16 Millstone Court, Stone, Staffordshire, ST15 8AY

An immaculately presented, luxury top floor apartment, conveniently located within strolling distance of Stone town centre. This apartment has been tastefully updated by the current owners, it's just perfect for anyone seeking a low maintenance lifestyle without compromising space and style. Offering accommodation that's both spacious and practical including; a lovely reception hallway, large living room, impressive breakfast kitchen with integrated appliances, three double bedrooms, an en-suite shower room to the main bedroom, and a guest bathroom. Outside there are well kept communal gardens and grounds, reserved parking, and additional visitor parking. A superb property in a much sought after location handy for literally everything that Stone has to offer. Available part furnished if required. Available immediately.

£1,150 Per Month

Approx Gross Internal Area
85 sq m / 912 sq ft

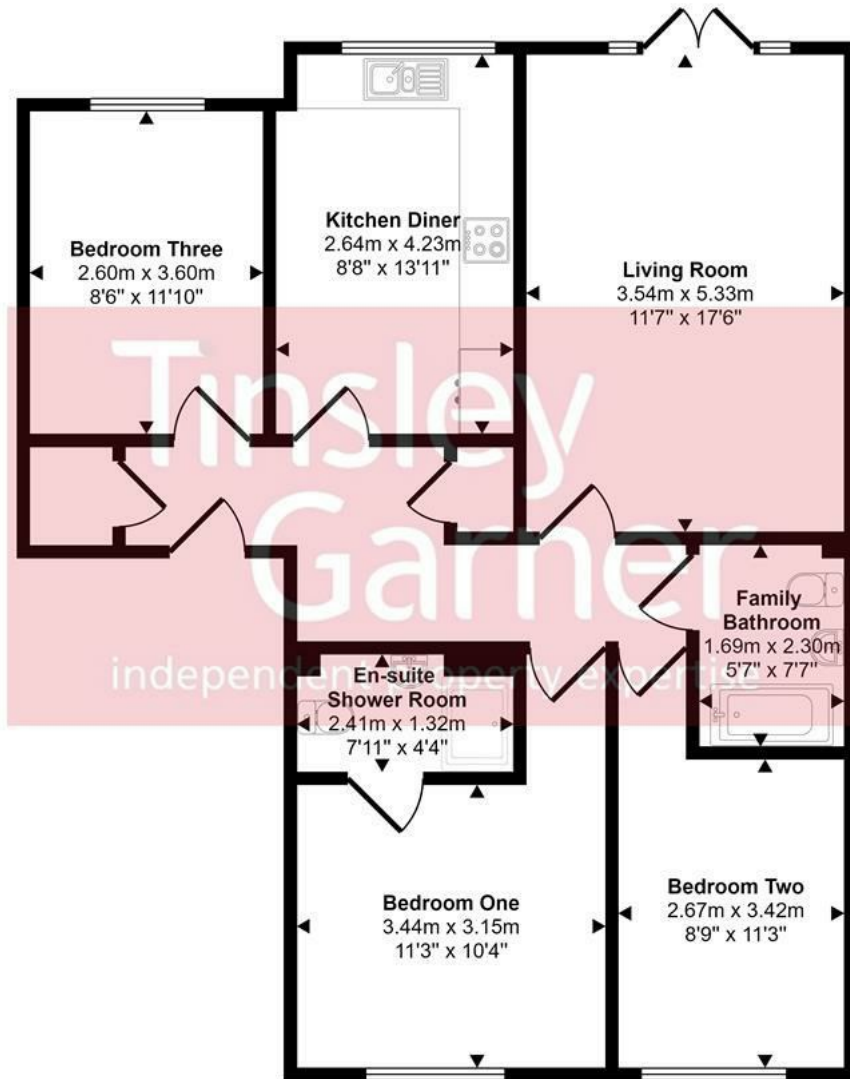

Floorplan

This floorplan is only for illustrative purposes and is not to scale. Measurements of rooms, doors, windows, and any items are approximate and no responsibility is taken for any error, omission or mis-statement. Icons of items such as bathroom suites are representations only and may not look like the real items. Made with Made Snappy 360.

Energy Efficiency Rating		Current	Potential
Very energy efficient - lower running costs			
(92 plus) A			
(81-91) B			
(69-80) C			
(55-68) D			
(39-54) E			
(21-38) F			
(1-20) G			
Not energy efficient - higher running costs			
England & Wales		79	81
EU Directive 2002/91/EC			

Environmental Impact (CO ₂) Rating		Current	Potential
Very environmentally friendly - lower CO ₂ emissions			
(92 plus) A			
(81-91) B			
(69-80) C			
(55-68) D			
(39-54) E			
(21-38) F			
(1-20) G			
Not environmentally friendly - higher CO ₂ emissions			
England & Wales		81	81
EU Directive 2002/91/EC			