



5 Doney Place, Stone, Staffordshire, ST15 0FA

A superb semi detached house. The house is on a new development on the outskirts of town, convenient for commuting and for a host of local amenities. Well proportioned accommodation with sitting room, open plan dining kitchen with integrated appliances, downstairs loo, three bedrooms, en-suite & family bathroom. All mod cons including gas c/h & Upvc double glazed windows. Turfed garden, off road parking for two cars.

Unfurnished

Sorry - no pets

Managed by Tinsley Garner

£825 Per Month

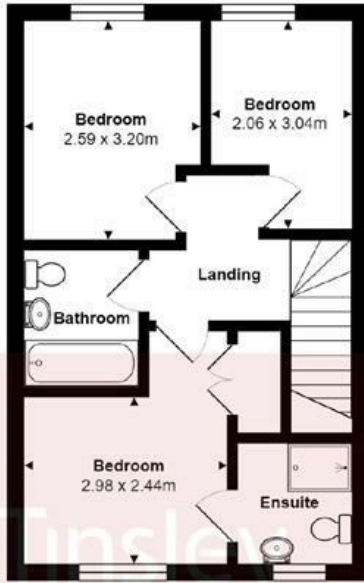

First Floor

Ground Floor

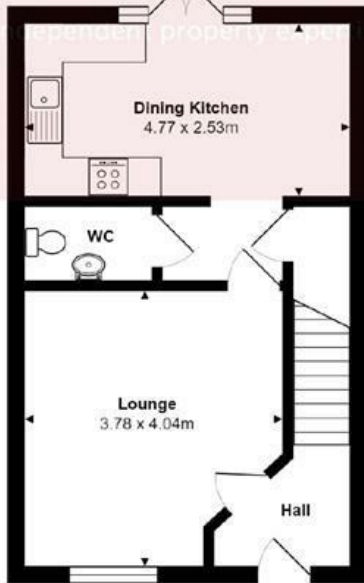

Total Area: 76.3 m²

All contents, positioning & measurements are approximate and for display purposes only

Energy Efficiency Rating		Current	Potential
Very energy efficient - lower running costs			
(92 plus) A			95
(81-91) B		83	
(69-80) C			
(55-68) D			
(39-54) E			
(21-38) F			
(1-20) G			
Not energy efficient - higher running costs			
England & Wales		EU Directive 2002/91/EC	

Environmental Impact (CO ₂) Rating		Current	Potential
Very environmentally friendly - lower CO ₂ emissions			
(92 plus) A			92
(81-91) B		81	
(69-80) C			
(55-68) D			
(39-54) E			
(21-38) F			
(1-20) G			
Not environmentally friendly - higher CO ₂ emissions			
England & Wales		EU Directive 2002/91/EC	