



The Annexe, Granville Terrace, Stone, Staffordshire, ST15 8DF

UNIQUE RENTAL PROPERTY. A fabulous character property situated in the heart of town, this former coach house has been converted into a luxurious pied a terre offering spacious & stylish accommodation - ideally suited to professional person / couple. Accommodation over 2 floors with upstairs studio style living / bedroom space and on the ground floor a fully equipped kitchen, dining / entertaining area, guest accommodation with futon bed and luxury shower room. Outside there is a courtyard garden with patio furniture. Gas central heating & double glazed windows.

Fully furnished, available from early September 2024

BILLS INCLUDED

Sorry No Pets

£1,200 Per Calendar Month

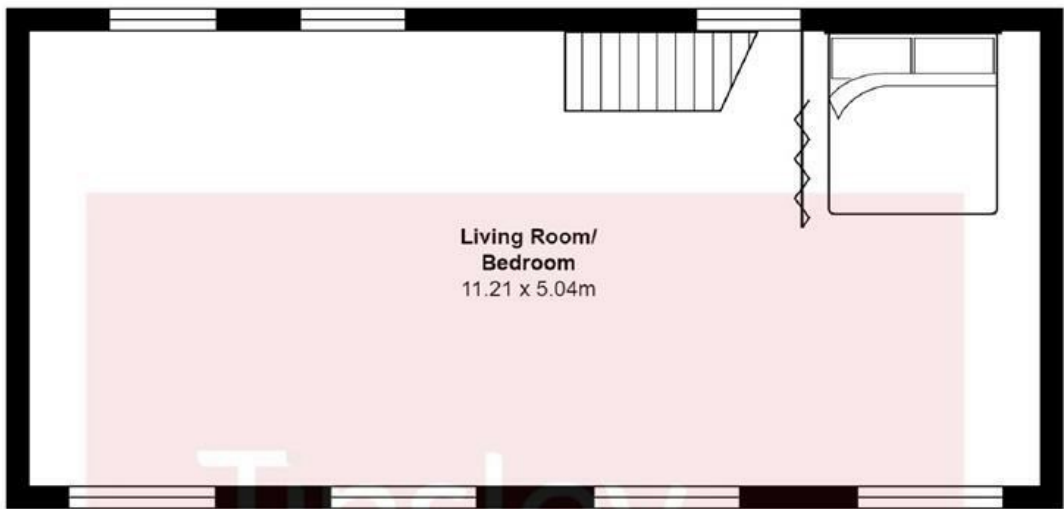

First Floor

Ground Floor

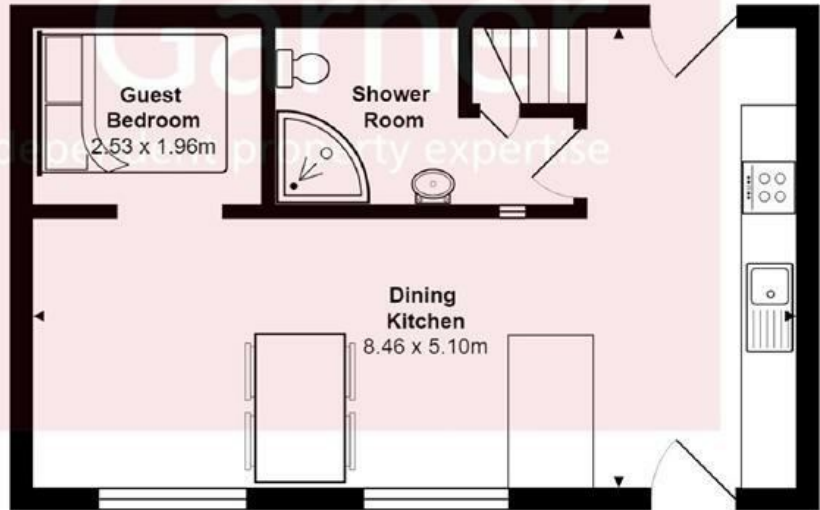

Total Area: 99.6 m²

All contents, positioning & measurements are approximate and for display purposes only

Energy Efficiency Rating		Current	Potential
Very energy efficient - lower running costs			
(92 plus) A			
(81-91) B			
(69-80) C			
(55-68) D			
(39-54) E			
(21-38) F			
(1-20) G		1	1
Not energy efficient - higher running costs			
England & Wales		EU Directive 2002/91/EC	

Environmental Impact (CO ₂) Rating		Current	Potential
Very environmentally friendly - lower CO ₂ emissions			
(92 plus) A			
(81-91) B			
(69-80) C			
(55-68) D			
(39-54) E			
(21-38) F			
(1-20) G		1	1
Not environmentally friendly - higher CO ₂ emissions			
England & Wales		EU Directive 2002/91/EC	