



Flat 1, 15 Leeds Road, Harrogate, North Yorkshire, HG2 8AY

£280,000

Flat 1, 15 Leeds Road, Harrogate, North Yorkshire, HG2 8AY

A particularly spacious and well-presented two-bedroom ground-floor apartment located in this convenient south Harrogate location, within easy reach of the excellent Leeds Road shopping parades, Harrogate town centre and the Hornbeam rail link for commuting to Leeds and York.

Situated within this brick-built detached property, the apartment comprises a spacious living room, good-sized dining kitchen, and two double bedrooms, both with en-suite facilities. The apartment has the advantage of an allocated off-street parking space.





GROUND FLOOR

SITTING ROOM

A large reception room with dual aspect and feature fireplace.

DINING KITCHEN

With spacious dining area. The kitchen comprises a range of stylish modern units with electric hob, integrated oven, microwave, dishwasher and fridge/freezer.

BEDROOM 1

A double bedroom with fitted wardrobes and ensuite shower room.

EN-SUITE SHOWER ROOM

With WC, basin and shower. Tiled walls and floor. Heated towel rail.

BEDROOM 2

A double bedroom with fitted wardrobes and ensuite.

ENSUITE

A modern white suite comprising wc, basin and bath with shower above. Heated towel rail.

OUTSIDE

The apartment has an allocated parking space.

AGENT'S NOTE

Lease length - originally 999 years.

No ground rent

The owner will be responsible for 2/13th of the costs of running the building.

Pets are permitted.

Renting is permitted.

Council Tax Band - C



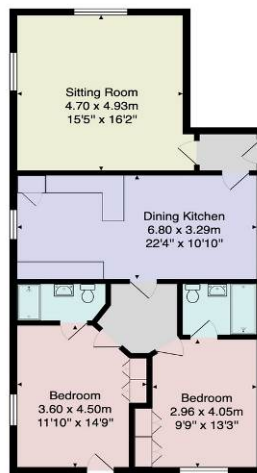

Total Area: 89.7 m² ... 966 ft²

All measurements are approximate and for display purposes only.
No liability is accepted by either the agency or Box Property Solutions Ltd as to the exact measurements of the rooms.
Box Property Solutions Ltd retains the copyright on this plan and allows agents to use it with agreed permission.

Verity Frearson

26 Albert Street, Harrogate,
North Yorkshire, HG1 1JT

For all enquiries contact us on:

01423 562531

sales@verityfearson.co.uk

