



23 The Chase, Knaresborough, North Yorkshire, HG5 0SY

£325,000

Offers Over

23 The Chase, Knaresborough, North Yorkshire, HG5 0SY

A very good sized two / three-bedroom detached bungalow with driveway and garage, situated in this delightful and quiet cul-de-sac position close to Knaresborough town centre.

The accommodation comprises a spacious sitting room, together with a well-equipped, modern kitchen, two double bedrooms, modern bathroom, dining room / bedroom 3 and conservatory extension. A driveway provides ample parking and leads to a garage, and there is an enclosed garden with paved sitting areas.

The property is situated at the head of a quiet cul-de-sac within this desirable location, well served by local amenities and close to Knaresborough town centre.





RECEPTION HALL

SITTING ROOM

A spacious reception room with feature place with gas fire.

KITCHEN

With range of fitted units with electric hob, integrated oven and fridge and space for washing machine.

DINING ROOM / BEDROOM 3

A further reception room providing a dining area with glazed doors, leading to a conservatory.

CONSERVATORY

Providing further sitting area with the windows and glazed doors overlooking the garden.



BEDROOM 1

A large double bedroom.

BEDROOM 2

A further good-sized bedroom with fitted wardrobes.

BATHROOM

A white suite comprising WC, washbasin and bath.



OUTSIDE

A driveway provides parking and leads to the garage. Enclosed garden with paved sitting areas.



Tenure - Freehold

Council Tax Band - E

EPC - D

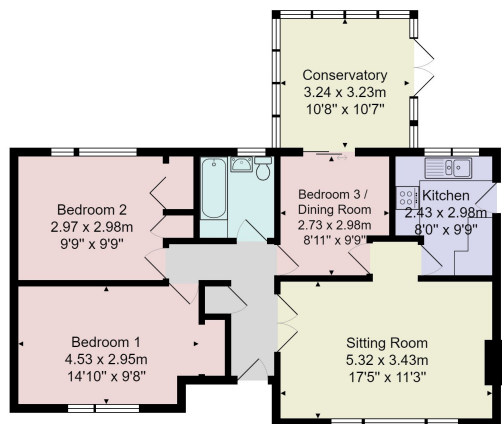

Total Area: 85.2 m² ... 917 ft²

All measurements are approximate and for display purposes only.

No liability is accepted by either the agency or Box Property Solutions Ltd as to the exact measurements of the rooms.
Box Property Solutions Ltd retains the copyright on this plan and allows agents to use it with agreed permission.

Verity Frearson

26 Albert Street, Harrogate,
North Yorkshire, HG1 1JT

For all enquiries contact us on:

01423 562531

sales@verityfrearson.co.uk