



- Secure Ground Floor
- Two Double Bedrooms with En Suite
- Bathroom/Shower Wc
- Newly Decorated
- Close To Great Transport Links
- (20/25 Mins City/West End)
- Private Garden
- Furnished

****AVAILABLE LATE JULY **** TWO-DOUBLE BEDROOM PURPOSE BUILT GROUND FLOOR APARTMENT set within a modern private block with private garden/secure phone entry and within a short walk to both Bowes Park National Rail & Bounds Green Tube stations (20/25 Mins City/West End). The property includes two double bedrooms with en-suite, a bath/shower room/WC, gas central heating system, open plan kitchen/living room and private garden. ****PART FURNISHED****

Finsbury Road, London, N22 8PD

£1,750 pcm

HOBARTS ESTATE AGENTS
3 Crescent Road, Alexandra Park, London, N22 7RP
rent@hobartsproperty.co.uk
www.hobarts.co.uk
0208 889 4322

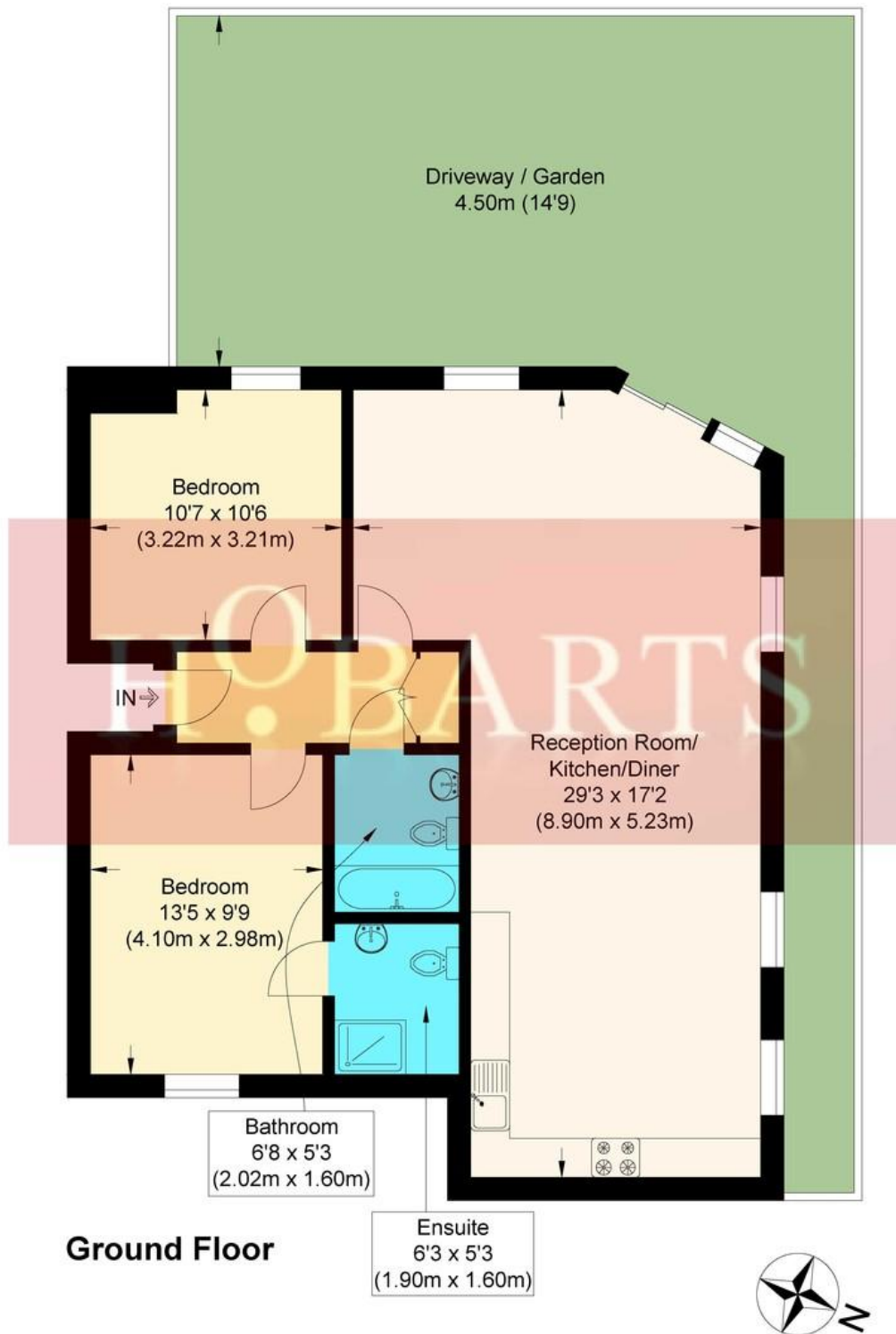

Finsbury Road, N22

Approximate Gross Internal Floor Area : 77.80 sq m / 837.43 sq ft
 Illustration for identification purposes only, measurements are approximate, not to scale.

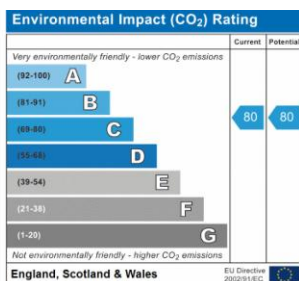
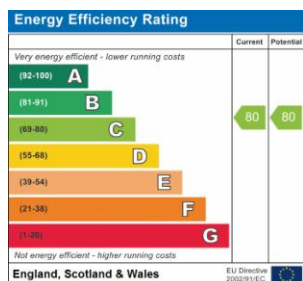
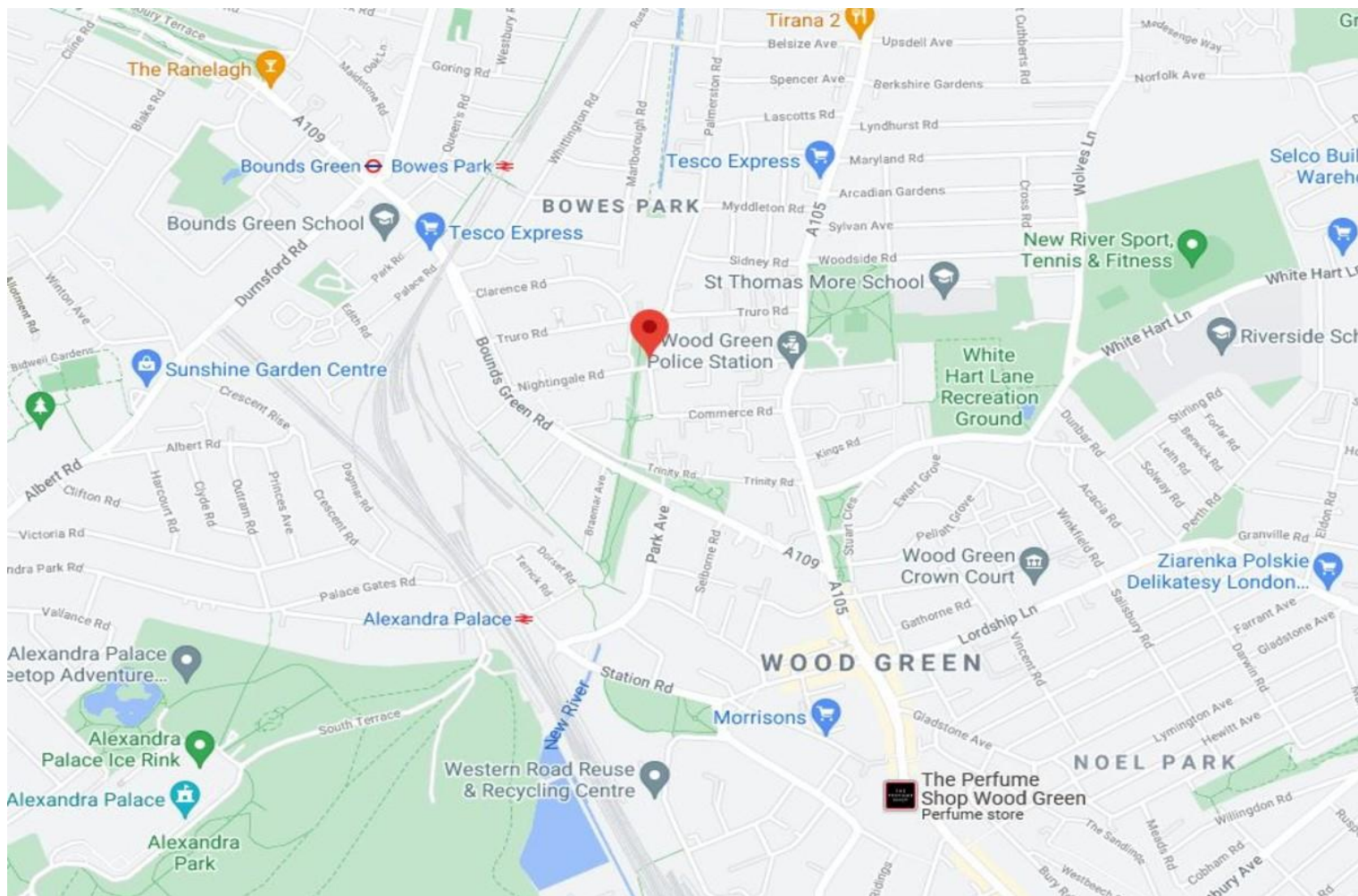

Local Authority:
Haringey London Borough Council

Viewings:
Strictly by appointment via
HOBARTS ESTATE AGENTS

Council Tax Band:
Band D

Contact:
3 Crescent Road
Alexandra Park
N22 7RP

0208 889 4322
rent@hobartsproperty.co.uk
www.hobarts.co.uk



These property details, including measurements, floor plans and items depicted in photographs etc. are intended only as a brief guide to prospective purchasers and are not intended to be relied upon for any purpose whatsoever. Any interested party should satisfy themselves by inspection or otherwise as to the correctness of each statement contained in these details.