

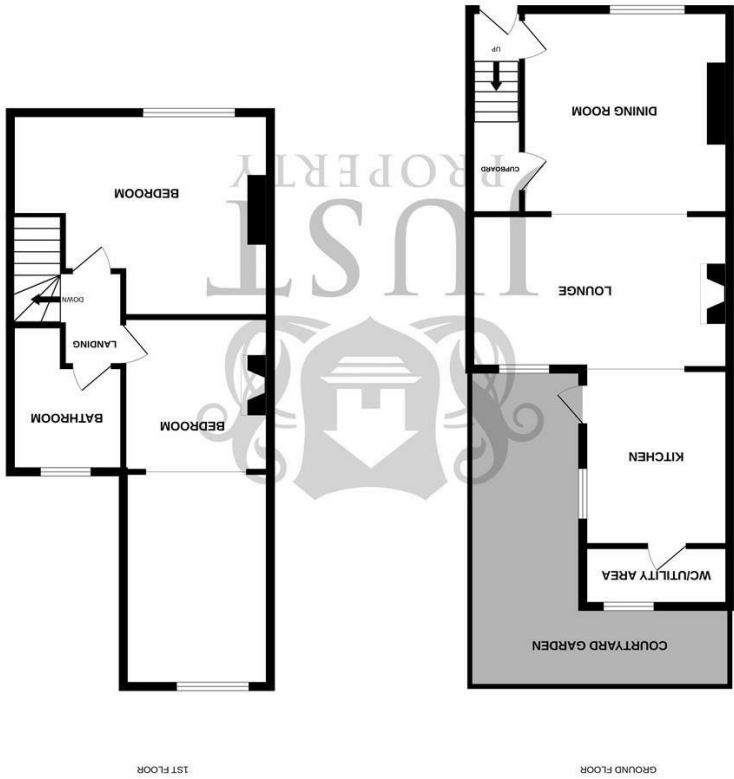

| England & Wales | | |
|---|-----------|-----------|
| EU Directive 2002/91/EC | | |
| Energy Efficiency Rating | Current | Potential |
| | 70 | 81 |
| Very energy efficient - lower running costs | | |
| A | (92 plus) | |
| B | (81-91) | |
| C | (69-80) | |
| D | (55-68) | |
| E | (39-54) | |
| F | (21-38) | |
| G | (1-20) | |
| Not energy efficient - higher running costs | | |

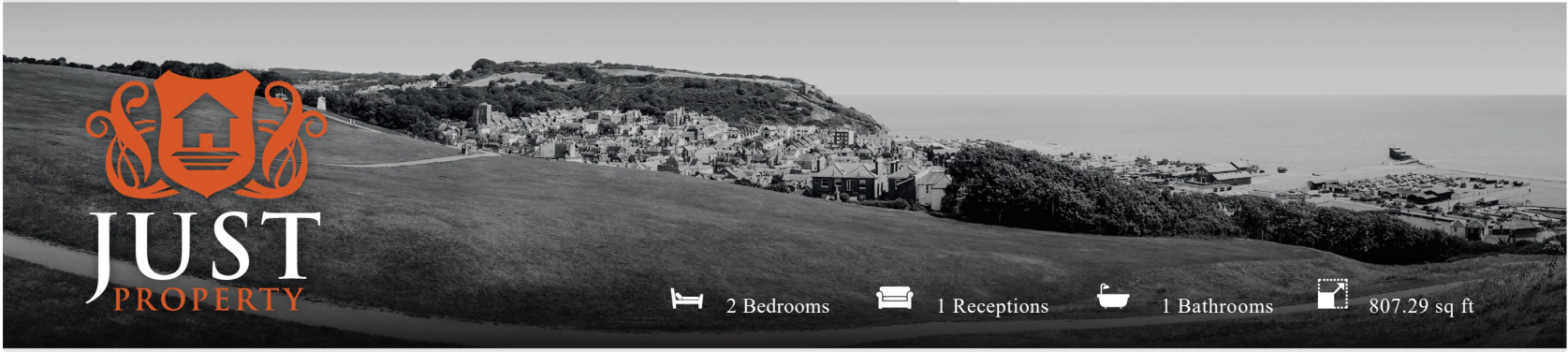

www.justproperty.net



Freehold

£300,000

8 Chievely Cottages Gillsmans Hill, St. Leonards-On-Sea, TN38 0SS





Freehold

£300,000



ROOM DIMENSIONS

| | |
|---|------------------|
| Front Door | Off-Road Parking |
| Entrance Hall | |
| Open Plan Lounge/Dining Room 22'0" x 14'3" (6.73m x 4.35m) | |
| Kitchen 8'11" x 8'7" (2.73m x 2.64m) | |
| Downstairs WC/Utility Area | |
| Stairs To First Floor | |
| Landing | |
| Bedroom 14'2" x 11'8" (4.34m x 3.58m) | |
| Bedroom 8'2" x 19'9" (2.50m x 6.02m) | |
| Family Bathroom | |
| Rear Courtyard Garden | |

FEATURES

- Delightful Period Cottage
- Excellent Location Nearby Transport Links, Mainline Station & Amenities
- Two Double Bedrooms
- Period Features
- Off-Road Parking
- Rear Courtyard Garden
- Accommodation Spanning Two Floors
- Open Plan Lounge/Diner With Modern Fitted Kitchen
- Family Bathroom With Bath & Separate Shower
- Council Tax Band - B



Please note that we have not tested the services or any of the equipment or appliances in this property, accordingly we strongly advise prospective buyers to commission their own survey or service reports before finalising their offer to purchase. While we endeavour to make our sales particulars fair, accurate and reliable, they are only a general guide to the property and accordingly if there are any point which is of particular importance to you, please contact the office and we will be pleased to check the position for you, especially if you are contemplating travelling some distance to view the property.