

These energy ratings have been made to ensure the accuracy of the England's standard data. Measurements of energy, water, space and other items are approximate and no responsibility is taken for any errors. The ratings are based on the information provided and no guarantee is made for any other purpose. The ratings are not intended to be used for any other purpose.

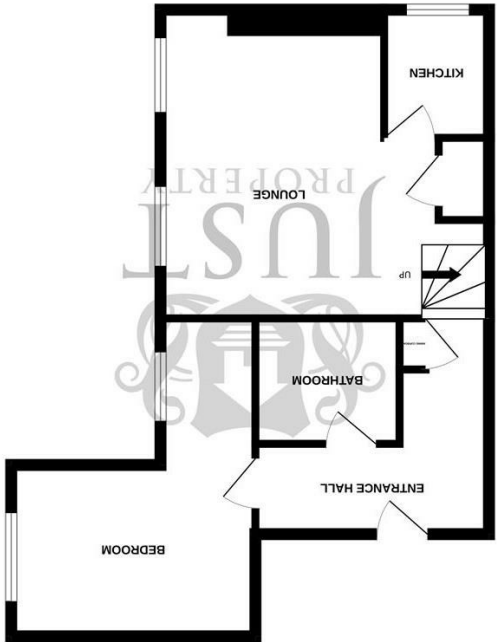

GROUND FLOOR



[www.justproperty.net](http://www.justproperty.net)

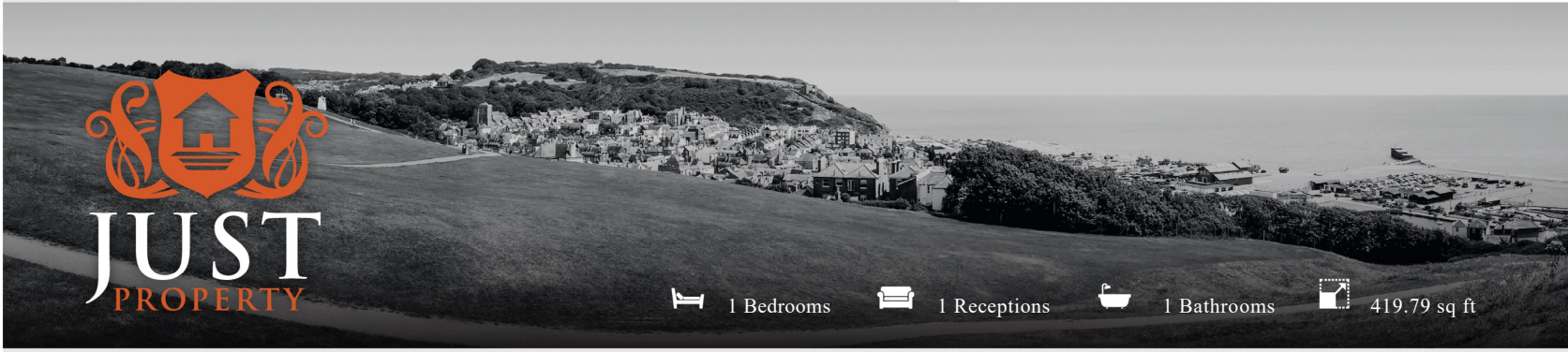

1 Bedrooms 1 Receptions 1 Bathrooms 419.79 sq ft

Flat 4 Wellington House Castle Hill Passage, Hastings, TN34 1PG

Leasehold

£125,000







Leasehold

£125,000



1 Bedrooms



1 Receptions



1 Bathrooms



419.79 sq ft

## PROPERTY DETAILS

This meticulously renovated 1-bedroom first-floor apartment, located in the heart of Hastings on Castle Hill Passage, offers the perfect combination of modern living and period charm. Every detail of this property has been carefully updated to provide a stylish and comfortable home, with high-quality finishes and a bright, airy feel throughout.

The apartment features a spacious living area that seamlessly flows into a well-appointed kitchen, creating a welcoming space for both relaxation and entertaining. The generously sized bedroom offers a peaceful retreat, while the sleek, modern bathroom completes the stylish interior.

Perfectly situated, the apartment is just moments away from a range of local amenities, including independent shops, cafes, restaurants, and the seafront, making it ideal for those who want to immerse themselves in the vibrant atmosphere of Hastings.

With its meticulous renovation, stylish presentation, and proximity to all the best Hastings has to offer, this 1-bedroom apartment is a rare find and a wonderful opportunity for those looking to enjoy coastal living in a sought-after area.

Additional features include a newly extended lease and UPVC Double Glazing.

To arrange access, please contact the vendors choice of sole agents, Just Property.

## ROOM DIMENSIONS

Communal Entrance

Front Door

Entrance Hall

Storage

Lounge

18'0" x 15'3" (5.49m x 4.67m)

Kitchen

7'11" x 5'1" (2.43m x 1.56m)

Storage

Bathroom

7'0" x 5'6" (2.15m x 1.68m)

Bedroom

15'10" x 12'3" (4.85m x 3.74)

## FEATURES

- CHAIN FREE
- Furniture & Appliances Included
- Exceptional Location in The Heart of Hastings
- Close To Local Amenities, Sea Front & Mainline Station
- One Bedroom First Floor Flat
- 18'0" Lounge
- Meticulous Renovation
- UPVC Double Glazing
- One Double Bedroom
- First Floor Apartment

