

These plans have been made to show the general layout of the property and are not intended to be used as a contract. The company does not warrant the accuracy of the information shown on these plans. The company does not warrant the accuracy of the information shown on these plans. The company does not warrant the accuracy of the information shown on these plans.

England & Wales	
EU Directive 2002/91/EC	
Very energy efficient - lower running costs	A (92 plus)
	B (81-91)
	C (69-80)
	D (55-68)
	E (39-54)
	F (21-38)
Not energy efficient - higher running costs	G (1-20)
Current	Potential

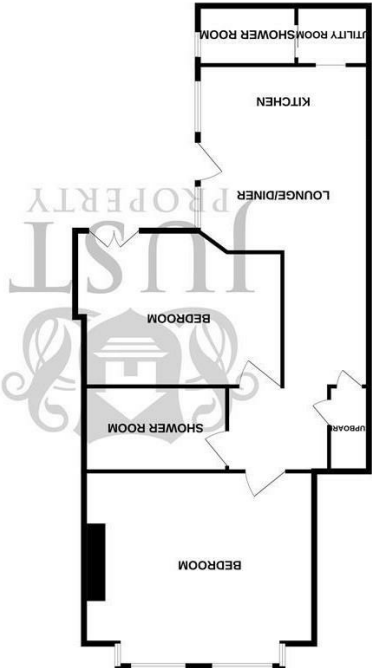

GROUND FLOOR



81 & 81A Braybrooke Road, Hastings, TN34 1TE

FLOORPLANS

www.justproperty.net

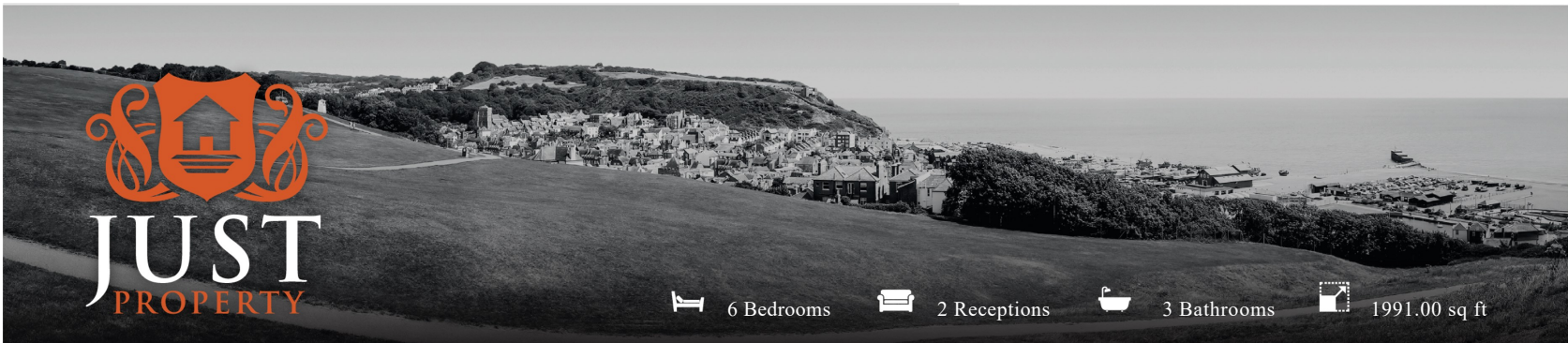

6 Bedrooms 2 Receptions 3 Bathrooms 1991.00 sq ft

Freehold

£600,000

81 & 81A Braybrooke Road, Hastings, TN34 1TE





6 Bedrooms 2 Receptions 3 Bathrooms 1991.00 sq ft

PROPERTY DETAILS

Just Property are delighted to bring to the market this recently converted property, housing 2 private access flats that have been maintained and renovated to an exceptionally high standard by the current owner.

Upstairs, the first floor of the 4-bedroom maisonette features a spacious open-plan living room & kitchen, highlighted by a charming bay-fronted window that fills the space with natural light. The kitchen is fully equipped with integrated appliances making it both functional & stylish. This floor also includes a well-proportioned double bedroom. A utility area for added convenience, & a modern shower room complete with a walk-in shower, hand wash basin, and toilet.

Towards the rear of the property, you will find another double bedroom featuring patio doors that open onto the private garden, providing a seamless connection between indoor and outdoor living.

On the second floor, you are greeted by two additional double bedrooms, each featuring elegant freestanding bathtubs, adding a touch of luxury and relaxation to these spaces. A separate shower room on this floor includes a walk-in shower, hand wash basin, and toilet.

As you enter the ground floor garden flat, you are welcomed into the open-plan living room & kitchen, creating a spacious and inviting environment. The kitchen features a stylish breakfast bar & integrated appliances.

Off the kitchen, there is a practical utility area, providing additional storage & space for laundry. Adjacent to this, the shower room is sleekly designed with a walk-in shower, wash hand basin, toilet, & a heated towel rail.

The property offers two well-sized bedrooms. The second shower room features a walk-in shower, hand wash basin, and toilet, all finished to a high standard. The main bedroom is a standout feature, boasting a bay front with charming sash-style windows that flood the room with natural light.

If you would like to arrange access to this spectacular property, please contact Just Property.



ROOM DIMENSIONS

MAISONETTE

Front Door

Entrance Hall

Stairs Leading To

First Floor Landing

Bedroom
10'9" x 9'2" (3.28 x 2.81)

Utility Room

Shower Room

Bedroom
11'3" x 13'3" (3.43 x 4.04)

Kitchen / Living Room
17'6" x 16'9" (5.34 x 5.11)

Stairs Leading Up To

Second Floor Landing

Bedroom
13'7" x 11'9" (4.16 x 3.60)

Bedroom

12'7" x 14'0" (3.86 x 4.28)

Shower Room

Garden

GROUND FLOOR FLAT

Front Door

Lounge / Diner
19'9" x 10'10" (6.03 x 3.32)

Kitchen

Utility Room

Shower Room

Bedroom
11'2" x 13'1" (3.42 x 3.99)

Shower Room

Bedroom
17'0" x 13'1" (5.20 x 3.99)

Garden

FEATURES

- Recently Converted
- 2 Private Gardens
- CHAIN FREE
- Ground Floor Flat and Maisonette
- Four Double Bedrooms in Maisonette
- Two Double Bedrooms in Ground Floor Flat
- Period Features
- Far Reaching Views from the Maisonette
- 2 Utility Areas
- Internal Viewing Highly Recommended

