

Whist every attempt has been made to ensure the accuracy of the floorplan contained here, measurements of doors, windows, rooms and other items are approximate and no responsibility is taken for any omission or mis-statement. This plan is for illustrative purposes only and should be used as such by any prospective purchaser. The services, systems and appliances shown have not been tested and no guarantee as to their operability or efficiency can be given.
 Made with Metropix ©2024

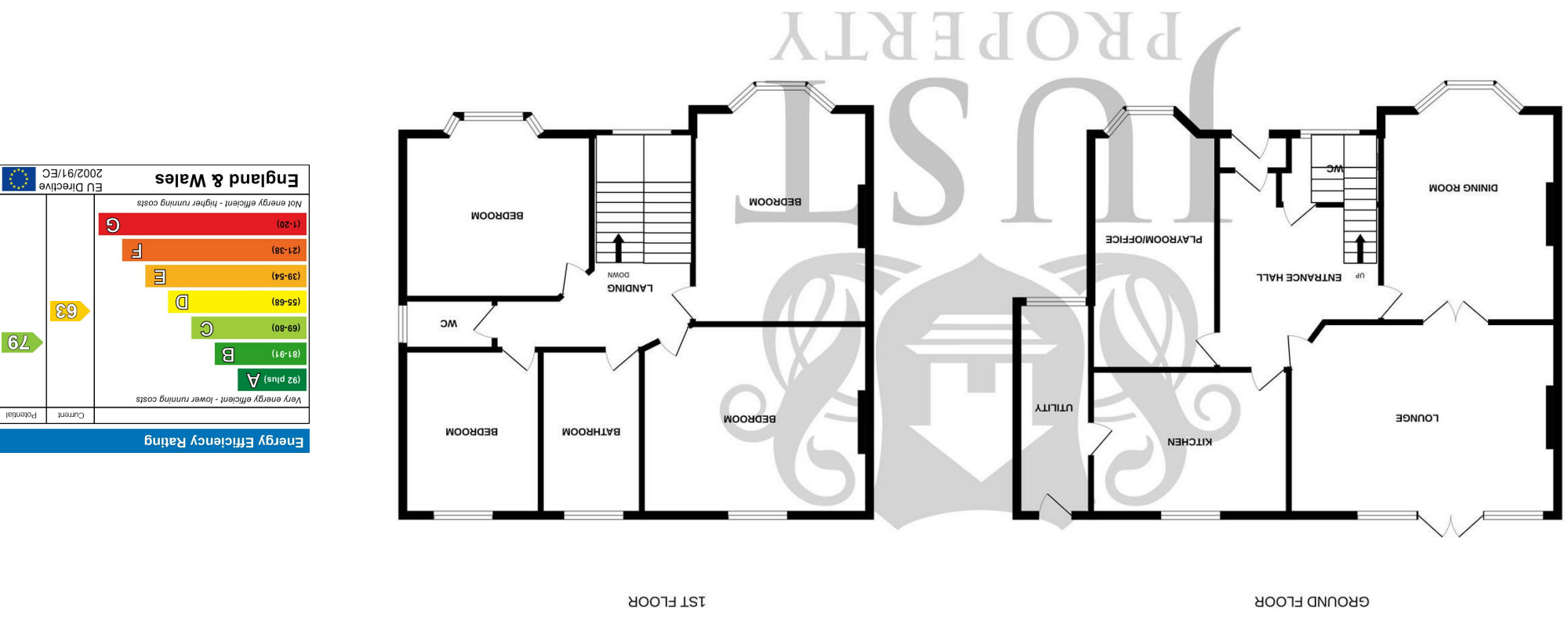

FLOORPLANS

9 Priory Close, Hastings, TN34 1UJ

www.justproperty.net

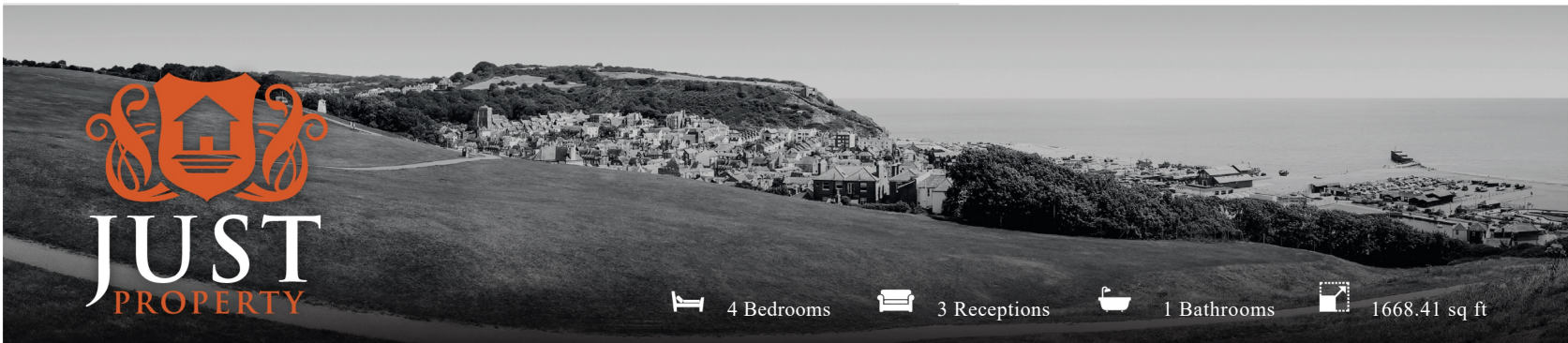

4 Bedrooms | 3 Receptions | 1 Bathrooms | 1668.41 sq ft

Freehold

£630,000

9 Priory Close, Hastings, TN34 1UJ





Freehold

£630,000



4 Bedrooms 3 Receptions 1 Bathrooms 1668.41 sq ft

PROPERTY DETAILS

OFFERS IN EXCESS OF £630,000

Welcome to Priory Close, Hastings - a charming property that offers a delightful blend of character and modern living. This detached house, boasting 3 reception rooms and 4 bedrooms, provides ample space for comfortable living. With a generous 1,668 sq ft of living area, there is room for the whole family to enjoy.

Dating back to the 1930s, this property exudes a timeless appeal while also offering versatile accommodation to suit your lifestyle needs. The interiors are simply wonderful, combining traditional features with contemporary finishes to create a warm and inviting atmosphere.

One of the standout features of this property is the great views it offers. Imagine waking up to picturesque scenes every morning and unwinding in the evening with a stunning backdrop. The gardens are a real feature of the property with many well established plants and shrubs.

Conveniently located within walking distance to the town centre and seafront, you'll have easy access to a plethora of amenities, entertainment options, and the beautiful coastline. Whether you enjoy a leisurely stroll by the sea or exploring the vibrant town centre, this location has it all.

Don't miss out on the opportunity to make this house your home. Embrace the charm, space, and convenience that this property in Priory Close has to offer. Book a viewing today and step into a world of endless possibilities.



ROOM DIMENSIONS

| | |
|------------------------------|------------------------------|
| Front Door | Bedroom |
| Entrance Porch | 15'5" x 13'1" (4.70 x 3.99) |
| Entrance Hall | Bedroom |
| Cloakroom | 14'4" x 11'10" (4.39 x 3.63) |
| Kitchen | Bedroom |
| 12'11" x 9'8" (3.94 x 2.95) | 13'1" x 12'2" (4.01 x 3.73) |
| Utility Room | Bedroom |
| 11'8" x 4'0" (3.58 x 1.24) | 11'1" x 8'11" (3.38 x 2.72) |
| Playroom / Office | Separate WC |
| 14'7" x 7'10" (4.45 x 2.41) | Bathroom |
| Lounge | Front Garden |
| 18'4" x 12'9" (5.59 x 3.91) | Rear Garden |
| Dining Room | Off Road Parking x 3 |
| 14'4" x 11'10" (4.37 x 3.61) | |
| First Floor Landing | |

FEATURES

- Detached Family Home
- Four Bedrooms
- Off Road Parking
- Far Reaching Views
- Three Reception Rooms
- Original Features
- Close To Town and Seafront
- Extensive Gardens
- Gas Central Heating and UPVc Windows
- Spacious Family Property

