



2 Bedroom Terraced For Sale, Ashton Road, Lu1 3Qe

OFFERS OVER £220,000

Tel: 01582 346 203

93-95 Castle Street, Luton, LU1 3AJ

office@vapropertyconsultants.co.uk

- Garden
- Double Bedrooms





VA are delighted to offer this fantastic 2 bed house in the centre of Luton. The property consists of two reception rooms and two double bedrooms upstairs. This property is located just 3 minutes walk from the town centre. Shops, restaurants, and all transport hubs are very close by. The property has central heating. If you are living in London and paying large amounts to rent the property you occupy this could be just the thing for you. This south Luton property is close to junction 10 for the M1 and is now available. This is a MUST SEE!!
* 2 Double Bedrooms * Town Centre Location

Dining Room

10' 10" x 10' 6" (3.32m x 3.22m)

Living Room

14' 2" x 10' 6" (4.32m x 3.22m)

Kitchen

14' 6" x 5' 11" (4.45m x 1.82m)

Bathroom

First Floor

Bedroom One

11' 3" x 10' 7" (3.45m x 3.25m)

Bedroom Two

10' 11" x 10' 7" (3.33m x 3.25m)

GROUND FLOOR

APPROX. 35.7 SQ. METRES (384.5 SQ. FEET)

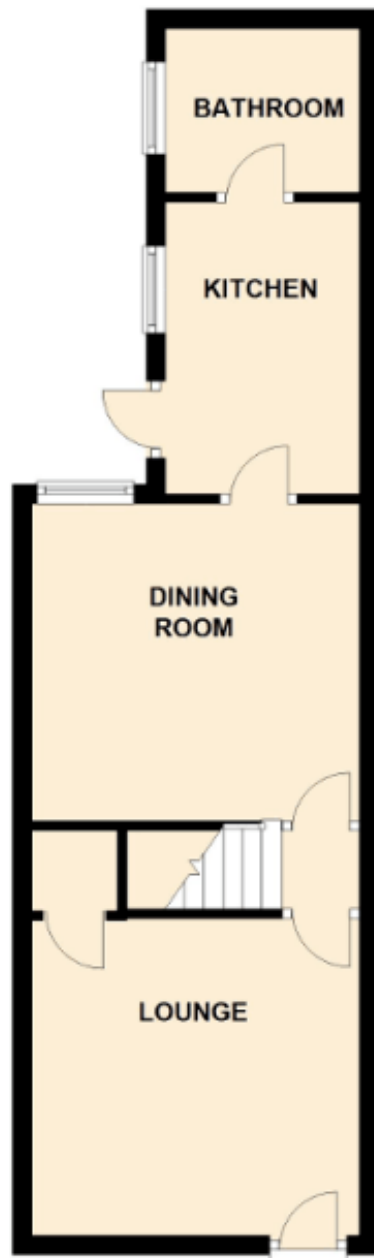

FIRST FLOOR

APPROX. 28.5 SQ. METRES (306.5 SQ. FEET)

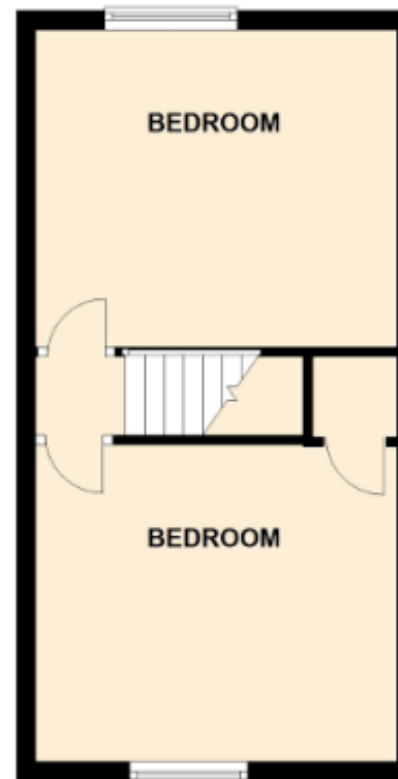

TOTAL AREA: APPROX. 64.2 SQ. METRES (691.0 SQ. FEET)

These Floor Plans are for illustrative purposes only. Areas shown are approximate. These plans will not show the correct wall thickness, especially in older properties. We aim to provide plans that are accurate and correctly represent the rooms within the property. We do not, however, provide any guarantees, warranty or representation as to the total accuracy and completeness of the floorplan. Anyone relying on the information provided should conduct a careful independent investigation of the property to determine the suitability of the property for their requirements.

Plan produced using PlanUp.

