



OFFICE HOURS:

Monday to Friday	9 am	to	5 pm
Saturday	9 am	to	2 pm
Sunday and Bank Holidays	12 noon	to	2 pm

10 good reasons to choose DMA

- * Open 7 days a week.
- * Filey's longest established family run independent estate agency.
 - * Prompt efficient friendly service.
 - * 360° virtual tours and floor plans.
 - * Free advertising: no sale - no charge.
 - * Free no obligation market valuation.
 - * Free accompanied viewing.
 - * Dedicated sales progression.
 - * Prominent town centre location.
 - * Modern walk-round self selection display.

RESIDENTIAL
SALES

DMA ESTATE
AGENTS

COMMERCIAL
SALES



Proprietors: David Mansfield ATTON FNAEA.
Samantha ADDISON
www.dmaestateagents.co.uk
ESTABLISHED 1992



These particulars are intended only to give a fair description of the property, as a guide to prospective buyers. Accordingly a) their accuracy is not guaranteed and neither DMA Estate Agents nor the vendor(s) accept any liability in respect of their contents; b) they do not constitute an offer or contract of sale, and c) any prospective purchaser should satisfy themselves by inspection or otherwise as to the correctness of any statement or information in these particulars.

DMA

ESTATE
AGENTS



26 THORN TREE AVENUE, FILEY YO14 9NT



Freehold £225,000

FEATURES

- * Modern three bedroom semi-detached house located in a cul-de-sac.
- * Upvc double glazed windows.
- * Gas central heating to radiators.
- * Through lounge / diner.
- * Upvc double glazed conservatory.
- * Drive to brick garage.
- * Front garden and well enclosed rear garden.
- * **Sold with no onward chain.**
- * **EPC Rating: D.**
- * Viewing is highly recommended.

ACCOMMODATION IN BRIEF

GROUND FLOOR:	Upvc Front Door to Entrance Hall. Through Lounge / Diner. Conservatory. Kitchen.
FIRST FLOOR:	Three Bedrooms. Bathroom.
OUTSIDE:	Gardens front and rear. Drive to brick garage.

26 Belle Vue Street, FILEY, North Yorks. YO14 9HY. Telephone: 01723 515527
www.dmaestateagents.co.uk / www.rightmove.co.uk

Floor Plan:

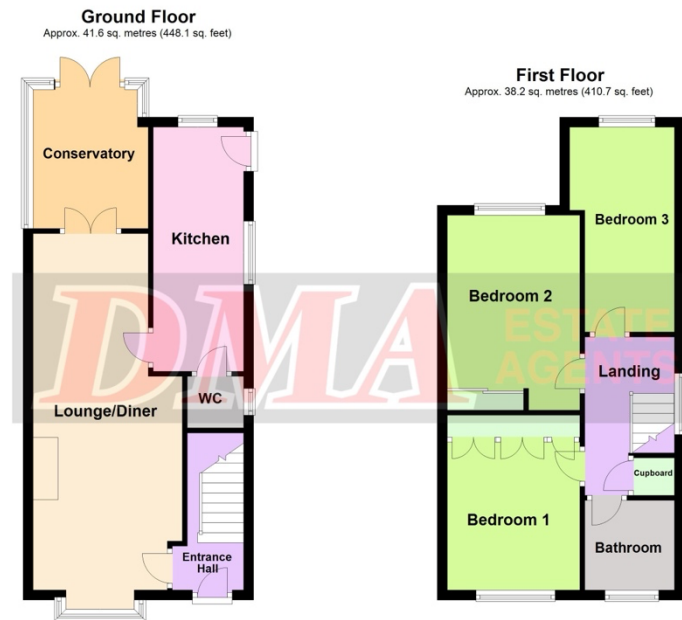

Total area: approx. 79.8 sq. metres (858.8 sq. feet)

Please note this floorplan is a guide and not to scale.
Plan produced using PlanUp.

26 Thorn Tree Avenue, Filey

BATHROOM

1.82m x 1.80m (6'0" x 5'11")

Mixer shower over the bath with shower screen. Handbasin in vanity unit, wc and bidet. Fully tiled walls and floor. White towel radiator. Upvc double glazed window.



OUTSIDE:

Open aspect to the front garden. Drive to brick **GARAGE** with plumbing for automatic washing machine. Enclosed rear garden.



Council Tax Band **B.**

DIRECTIONS:

Follow the directions for Scarborough out of Filey and take the last turning on the right onto Sycamore Avenue. Take the first right onto Thorn Tree Avenue and the property is located in the bottom right hand corner.

Viewing strictly by appointment only through DMA Estate Agents

Front Door to:

ENTRANCE HALL

Radiator.

LOUNGE / DINING AREA

2.99m narrowing to 2.31 x 7.16m
(9'10" narrowing to 7'7" x 23'6")

Freestanding log effect electric fire set in feature fireplace. Two radiators. Upvc double glazed window.



CONSERVATORY

2.79m x 2.10m (9'2" x 6'11")

Upvc double glazed windows. **Upvc double glazed doors to garden.**

KITCHEN

4.90m x 2.10m (16'1" x 6'11")

Inset stainless steel sink, vegetable sink and drainer. Excellent range of modern base units finished in grey with worktops over. Matching wall cupboards. Gas hob with extractor over. Built-in electric oven. Provision for tall 'fridge / freezer. Integrated dishwasher. Spotlights. Laminate floor. Radiator. Two upvc double glazed windows.



SEPARATE WC

2.10m x 3.06m (0'86" x 1'06")

Upvc double glazed window.



FIRST FLOOR:



LANDING

Built-in cupboard housing combination boiler. Upvc double glazed side window. **Loft access.**

BEDROOM ONE

2.97m x 2.66m (9'9" x 8'9")

Built-in wardrobes. Radiator. Upvc double glazed window.



BEDROOM TWO

2.64m x 3.47m (8'8" x 11'5")

Built-in wardrobes with sliding doors. Radiator. Upvc double glazed window.



BEDROOM THREE

1.82m widening to 2.08m x 4.11m
(6'0" widening to 6'10" x 13'6")

Radiator. Upvc double glazed window.



/ continued over