



# 11 Clifton Drive

Sprotbrough, Doncaster, DN5 7NL

£350,000

Offered with no onward chain is this beautifully presented and extended four bedroom detached house occupying an enviable position on a sought after roadway of Sprotborough. The property benefits from; an entrance hallway, bright an airy open plan lounge with connecting dining room & sitting room which features patio doors to the rear garden, kitchen with access to the utility room and WC. Upstairs; a large master bedroom, a further three spacious bedrooms and a family shower-room. Outside; The gardens are particularly attractive with a well maintained lawned area to the rear of the property complete with patio, numerous shrubs, flower beds and borders. To the front is a large blocked paved driveway accommodating up to 2/3 vehicles. Located in a popular village close to local amenities, reputable schools and transport links this to the A1/M1 motorway network, is a fantastic purchase for the family buyer.

- A beautifully presented extended four bedroom detached house
- Spacious open plan lounge / dining room and additional sitting room
- Utility and downstairs WC
- Four spacious bedrooms
- Family shower - room
- Large, well maintained rear garden
- Driveway for 2/3 vehicles
- GCH / Double Glazing
- NO ONWARD CHAIN
- Sought after village location, close to a range of local amenities

## Viewing

Please contact our Office on 01302 751616 if you wish to arrange a viewing appointment for this property or require further information.

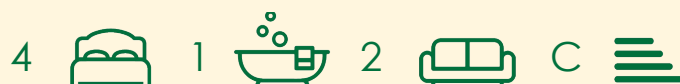



Floor Plan

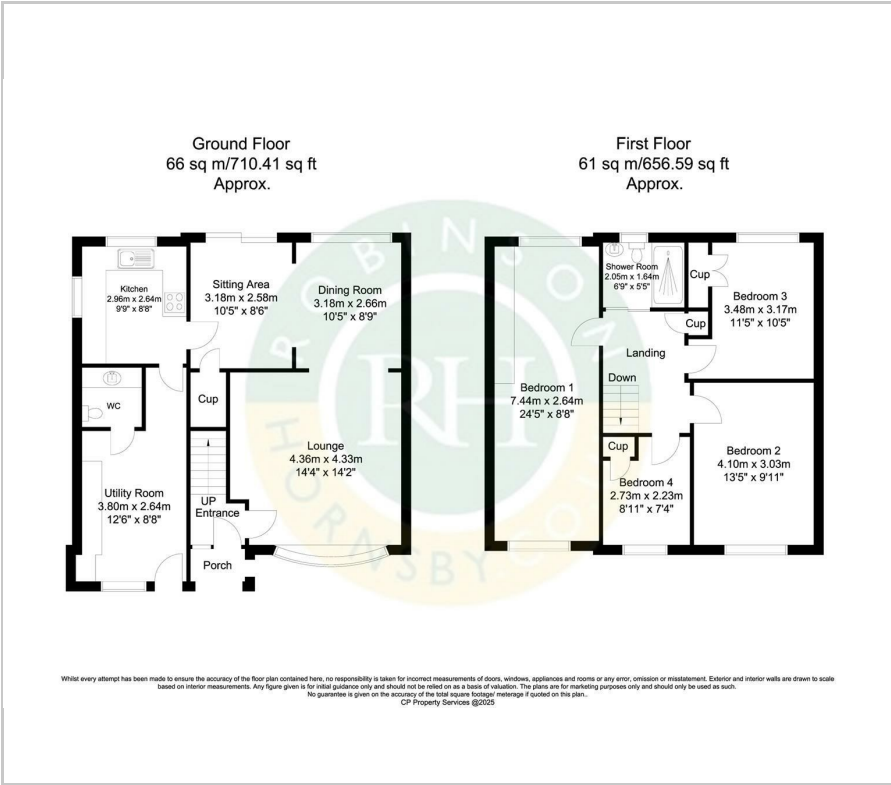

Area Map



Energy Efficiency Graph

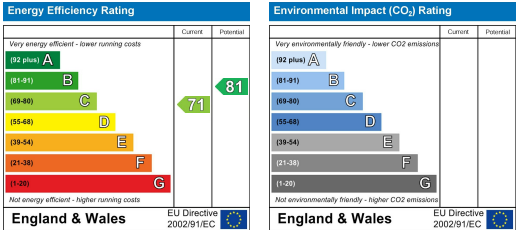

These particulars, whilst believed to be accurate are set out as a general outline only for guidance and do not constitute any part of an offer or contract. Intending purchasers should not rely on them as statements of representation of fact, but must satisfy themselves by inspection or otherwise as to their accuracy. No person in this firms employment has the authority to make or give any representation or warranty in respect of the property.