



39 Radcliffe Lane

Scawthorpe, Doncaster, DN5 7XS

Asking Price £299,500

Situated on a small, select cul de sac, with an open aspect to the rear, a well presented 4 bedroom detached family home, with garage and further parking. Briefly comprises; hall, lounge with through dining area, well appointed kitchen, recently re fitted, and having a host of integrated appliances. Side entrance lobby with WC and store. Internal garage access.

1st floor; master bedroom with en suite shower room; 3 further bedrooms and bathroom.

Outside; private, low maintenance rear gardens, with 'astro' style lawn, and secluded patio areas.

Front lawn, integral garage, currently used as gym.

- 4 bedroom detached family home in ever popular setting
- private plot, on small cul de sac, with open rear aspect
- low maintenance, secluded rear gardens
- recently re fitted kitchen and bathroom
- City centre / mainline railway : 3.5 miles
- local schools for all ages within easy reach
- good motorway access
- worthy of inspection!
- solar panels (leased)

Viewing

Please contact our Office on 01302 751616 if you wish to arrange a viewing appointment for this property or require further information.



Floor Plan

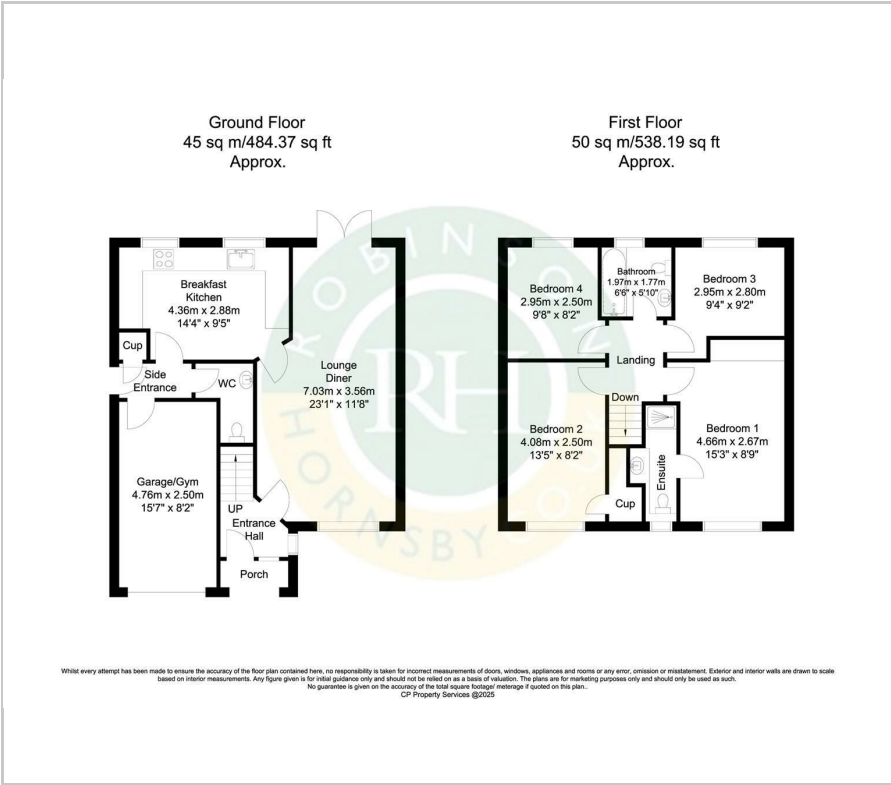

Area Map



Energy Efficiency Graph

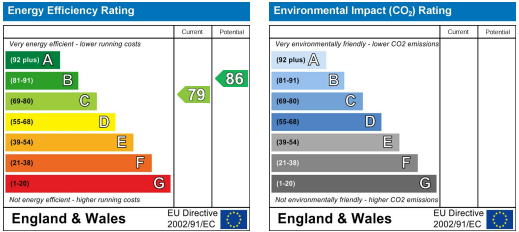

These particulars, whilst believed to be accurate are set out as a general outline only for guidance and do not constitute any part of an offer or contract. Intending purchasers should not rely on them as statements of representation of fact, but must satisfy themselves by inspection or otherwise as to their accuracy. No person in this firms employment has the authority to make or give any representation or warranty in respect of the property.