



## 28 Mirabelle Way

Harworth, Doncaster, DN11 8DA

### Guide Price £250,000

GUIDE PRICE £250,000 - £260,000

A fantastic opportunity to purchase a deceptively spacious four bedroom detached town house situated on this popular modern development. The property in brief comprises; entrance hallway, lounge, open plan kitchen/dining room, utility room, cloaks/wc, guest bedroom with en suite, two further double bedrooms and family bathroom to the first floor and master bedroom with en suite to the second floor. Outside; front garden, landscaped rear enclosed garden, driveway and garage with electric door. Situated close to local amenities and motorway connections this well presented modern family home must be viewed to be appreciated

### Viewing

Please contact our Office on 01302 751616 if you wish to arrange a viewing appointment for this property or require further information.

- Detached house
- Four good sized bedrooms
- Two en suite shower rooms
- Stunning open plan kitchen/dining room
- Utility room and cloaks/wc
- Landscaped rear enclosed garden
- Driveway and large garage with electric door
- Popular modern development
- Close to local amenities
- Must be viewed





Floor Plan

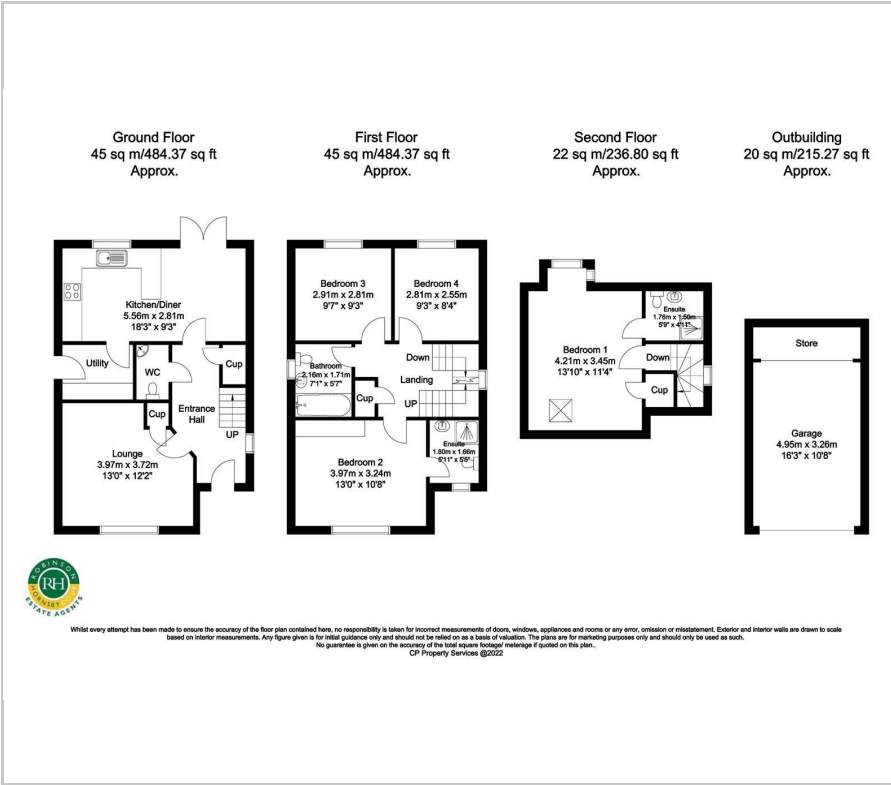

Area Map



Energy Efficiency Graph

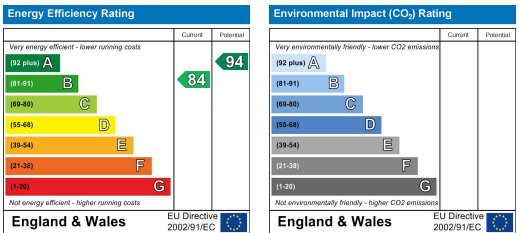

These particulars, whilst believed to be accurate are set out as a general outline only for guidance and do not constitute any part of an offer or contract. Intending purchasers should not rely on them as statements of representation of fact, but must satisfy themselves by inspection or otherwise as to their accuracy. No person in this firms employment has the authority to make or give any representation or warranty in respect of the property.