



# 1 Scotsman Drive

Scawthorpe, Doncaster, DN5 9JA

**Guide Price £225,000**

GUIDE PRICE £225,000 - £230,000

A fantastic opportunity to purchase a spacious four bedroom semi detached house situated on a sought after modern development within Scawthorpe. The property in brief comprises; entrance hallway, cloaks/WC, open plan kitchen/dining room and sitting room to the ground floor, lounge and master bedroom with en suite shower room to the first floor and three further good sized bedrooms and family bathroom to the second floor. Outside; tandem driveway to the side thereafter leading to a garage and private rear enclosed garden. Ideally located close to local amenities, reputable schools and motorway connections and offered for sale with NO ONWARD CHAIN early viewing is highly recommended.

## Viewing

Please contact our Office on 01302 751616 if you wish to arrange a viewing appointment for this property or require further information.

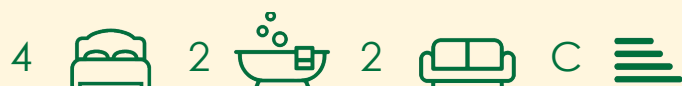



Floor Plan

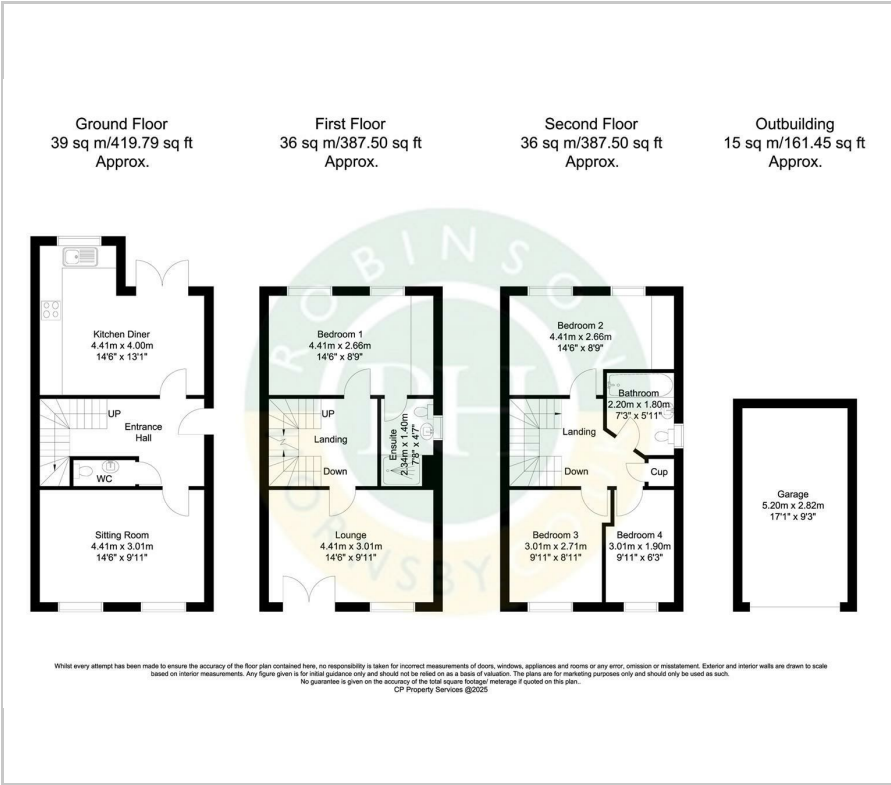

Area Map

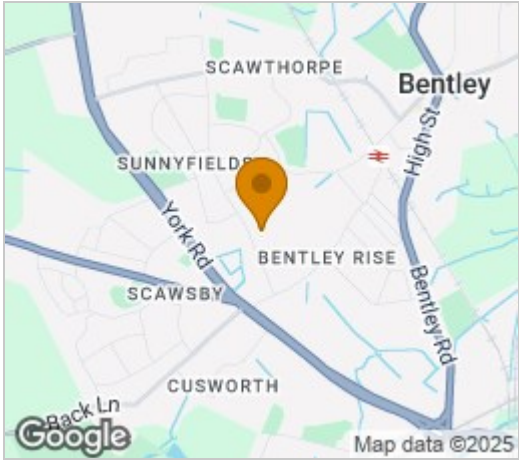

Energy Efficiency Graph

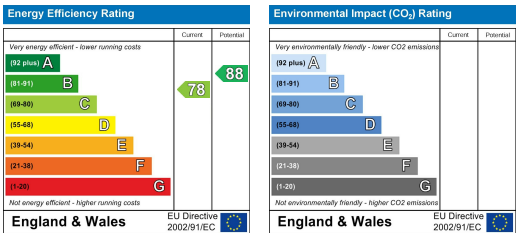

These particulars, whilst believed to be accurate are set out as a general outline only for guidance and do not constitute any part of an offer or contract. Intending purchasers should not rely on them as statements of representation of fact, but must satisfy themselves by inspection or otherwise as to their accuracy. No person in this firms employment has the authority to make or give any representation or warranty in respect of the property.