



# The Mount High Street

Wadworth, Doncaster, DN11 9BG

## Offers Around £275,000

A rare opportunity to purchase a fantastic two double bedroom detached bungalow occupying an enviable position on this sought after roadway. The property in brief comprises; entrance hallway with storage cupboards, lounge, modern kitchen, two double bedrooms and family bathroom with separate wc. Outside; gated access to the front leads to an attractive resin driveway providing ample off road parking, single garage with electric roller door and lawned front garden with shaped established flower beds. To the rear is an enclosed garden with storage shed and greenhouse and elevated rolling views. The property is offered for sale with NO ONWARD CHAIN, early viewings are highly recommended.

- Detached bungalow
- Two double bedrooms
- Modern fitted kitchen
- Family bathroom with white suite and separate WC
- Gated to the front
- Ample parking and garage
- Stunning open aspect views to the rear
- No onward chain
- Early viewing is highly recommended
- Sought after roadway

### Viewing

Please contact our Office on 01302 751616 if you wish to arrange a viewing appointment for this property or require further information.





## Floor Plan

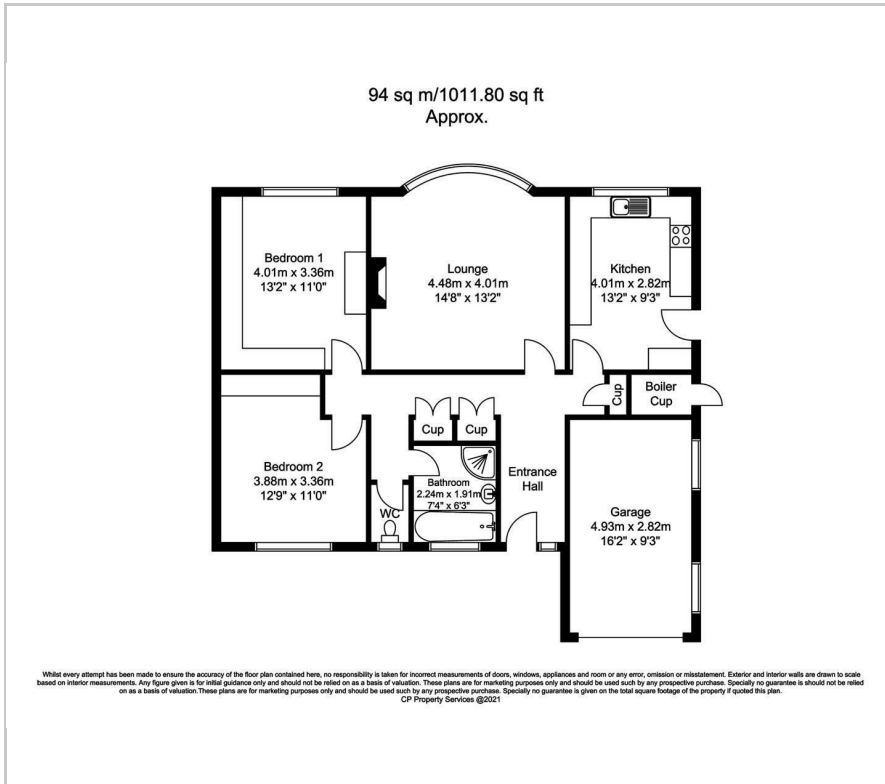

## Area Map



## Energy Efficiency Graph

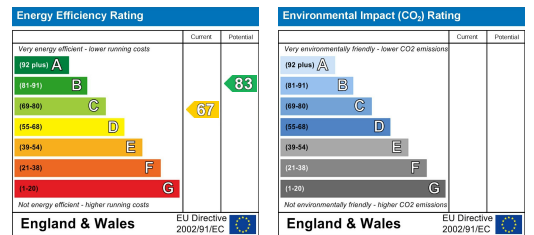

These particulars, whilst believed to be accurate are set out as a general outline only for guidance and do not constitute any part of an offer or contract. Intending purchasers should not rely on them as statements of representation of fact, but must satisfy themselves by inspection or otherwise as to their accuracy. No person in this firm's employment has the authority to make or give any representation or warranty in respect of the property.