



# 10 Coxley Court

Rossington, Doncaster, DN11 0FT

Price Guide £330,000

GUIDE PRICE: £330,000 - £335,000

An opportunity to purchase this stunning four bedroom detached family home, situated in a quiet cul-de-sac, on this ever popular estate. Located within easy reach of local amenities including, shops, pubs, bus routes, and reputable schools. The accommodation comprises: entrance hall, cloakroom/wc, spacious lounge with feature fireplace with French doors giving access to the dining room, fully fitted kitchen with integrated appliances, leading into utility area and a large conservatory overlooking the rear garden. Master bedroom with ensuite and further three sizeable bedrooms plus stunning family bathroom. Outside: block paved double driveway leading to integral garage with side gate giving access to the rear garden which is mainly laid to lawn with patioed seating areas and stocked with mature trees and shrubs.

- Deatched
- Four Bedrooms
- Cloakroom WC
- Conservatory
- Utility Room
- En Suite
- DG and GCH
- Council Tax Band C
- Cul-de-sac
- Viewing Highly Recommended

## Viewing

Please contact our Office on 01302 751616 if you wish to arrange a viewing appointment for this property or require further information.

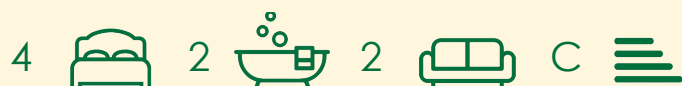



# Floor Plan

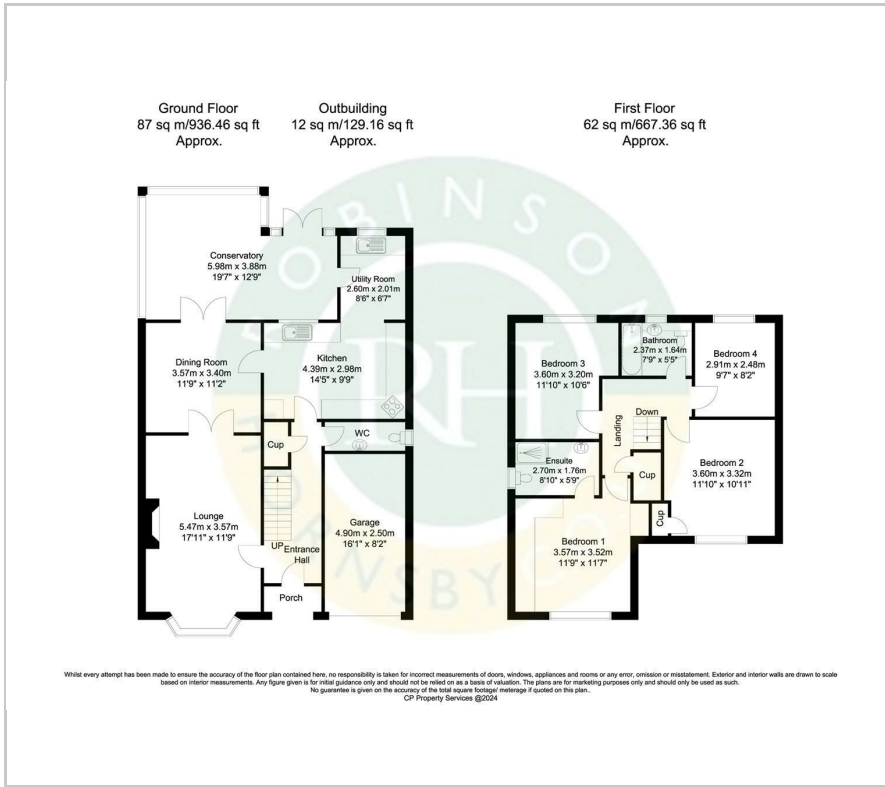

# Area Map



# Energy Efficiency Graph

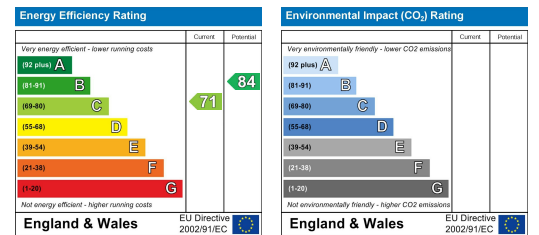

These particulars, whilst believed to be accurate are set out as a general outline only for guidance and do not constitute any part of an offer or contract. Intending purchasers should not rely on them as statements of representation of fact, but must satisfy themselves by inspection or otherwise as to their accuracy. No person in this firm's employment has the authority to make or give any representation or warranty in respect of the property.