



98 Thorne Road

Doncaster, DN2 5BJ

Asking Price £325,000

Offering around 2,500 sq ft of accommodation, this characterful semi detached home provides 6 bedrooms over 3 floors, and is positioned on a generous corner plot. Briefly comprises; ground floor; large entrance hall, 3 reception rooms, breakfast kitchen, WC. Access to 2 basement rooms. 1st floor; 4 bedrooms and bathroom. 2nd floor, 2 further bedrooms. Outside; private rear garden, access from Zetland Road to the detached brick built garage.

Although in need of some general upgrading this property offers great potential to create a superb family home, within easy reach of Doncaster City Centre.

- superbly spacious semi detached home on generous corner plot
- 6 bedrooms, 3 reception rooms, over 3 floors
- detached garage, off road parking
- close to City Centre, mainline rail and motorway routes
- full of character, with some period features
- offers plenty of further potential

Viewing

Please contact our Office on 01302 751616 if you wish to arrange a viewing appointment for this property or require further information.

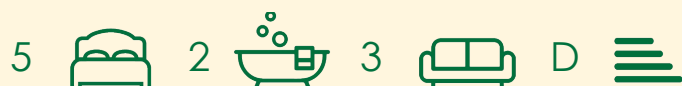

Floor Plan

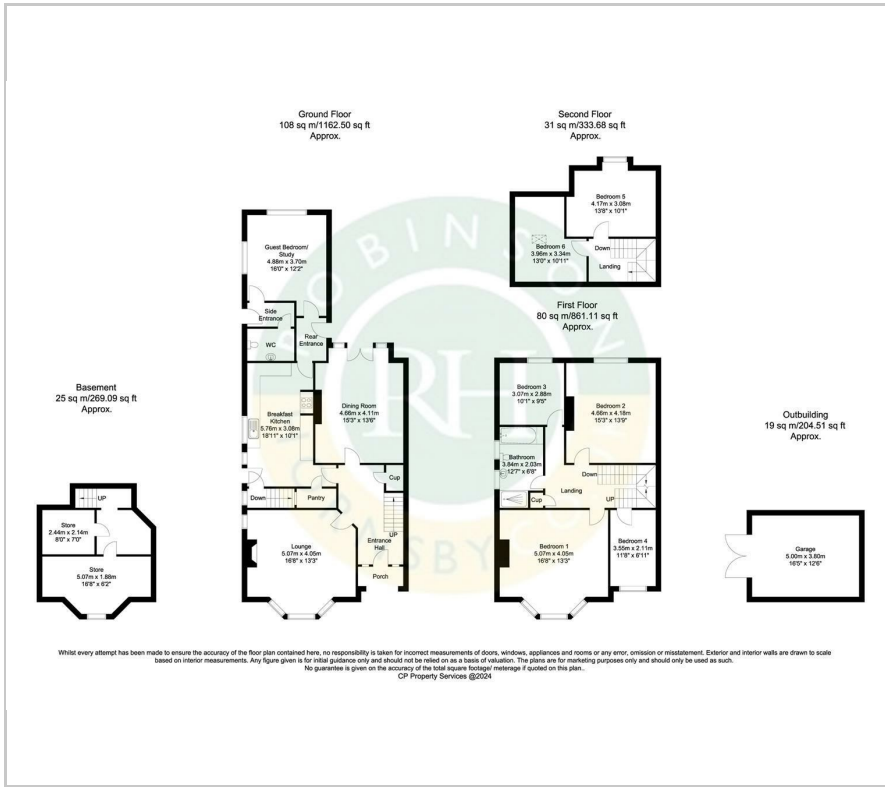

Area Map



Energy Efficiency Graph

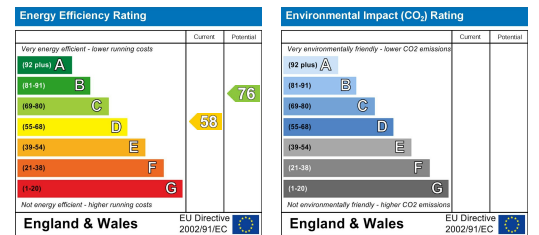

These particulars, whilst believed to be accurate are set out as a general outline only for guidance and do not constitute any part of an offer or contract. Intending purchasers should not rely on them as statements of representation of fact, but must satisfy themselves by inspection or otherwise as to their accuracy. No person in this firm's employment has the authority to make or give any representation or warranty in respect of the property.