



# 10 Mill Lane

Warmsworth, Doncaster, DN4 9RQ

## Offers In The Region Of £200,000

Positioned in the sought after suburb of Warmsworth, this immaculate 3-bedroom semi-detached house is a true gem waiting to be discovered. As you step inside, you'll be greeted by a modern kitchen equipped with appliances, perfect for whipping up delicious meals. The stylish shower room adds a touch of luxury to your daily routine.

This property boasts one reception room, ideal for entertaining guests or simply relaxing with your loved ones. The open-plan kitchen/dining room is a delightful space, with French doors leading out to the rear garden, creating a seamless indoor-outdoor living experience.

Convenience is key with parking available for 2 vehicles, making coming home a breeze. The proximity to the A1 motorway network ensures easy access to various destinations, perfect for those who are always on the go.

- Semi detached house
- Three bedrooms
- Modern open plan kitchen/dining room
- Luxury shower room
- Block paved driveway providing ample off road parking
- Rear enclosed garden
- Well presented throughout
- Sought after roadway
- Close to local amenities and reputable schools
- Must be viewed

### Viewing

Please contact our Office on 01302 751616 if you wish to arrange a viewing appointment for this property or require further information.



## Floor Plan

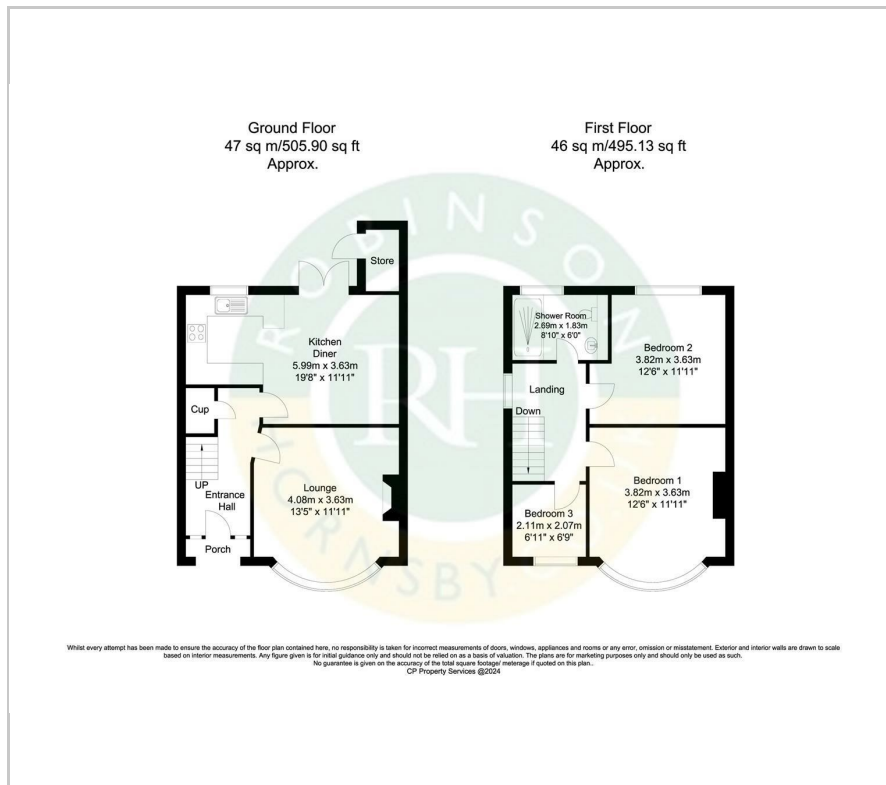

## Area Map



## Energy Efficiency Graph

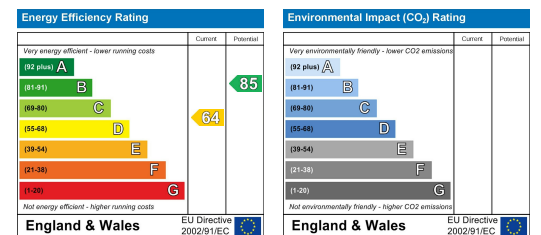

These particulars, whilst believed to be accurate are set out as a general outline only for guidance and do not constitute any part of an offer or contract. Intending purchasers should not rely on them as statements of representation of fact, but must satisfy themselves by inspection or otherwise as to their accuracy. No person in this firm's employment has the authority to make or give any representation or warranty in respect of the property.