



67 Clifton Drive

Sprotbrough, Doncaster, DN5 7NL

Asking Price £230,000

A rare opportunity to purchase a beautifully presented, recently renovated three bedroom EXTENDED semi detached occupying an enviable position on a sought after roadway within Sprotbrough. The property in brief comprises; entrance hallway, lounge with feature fireplace, stunning extended open plan kitchen/dining room with a range of integrated appliances and breakfast bar and family bathroom to the ground floor with three good sized bedrooms all with quality fitted wardrobes to the first floor. Outside; driveway and garage to the front and rear enclosed garden with open views over school fields. Ideally located close to local amenities and reputable schools this fantastic family property, which is offered for sale with NO ONWARD CHAIN, must be viewed.

- Semi detached house
- Three bedrooms
- Stunning open plan kitchen/dining room
- Renovated to a high specification by the current owner
- Driveway and garage
- Overlooking school fields to the rear
- Immaculately presented throughout
- Front and rear gardens
- NO ONWARD CHAIN
- Must be viewed

Viewing

Please contact our Office on 01302 751616 if you wish to arrange a viewing appointment for this property or require further information.



Floor Plan

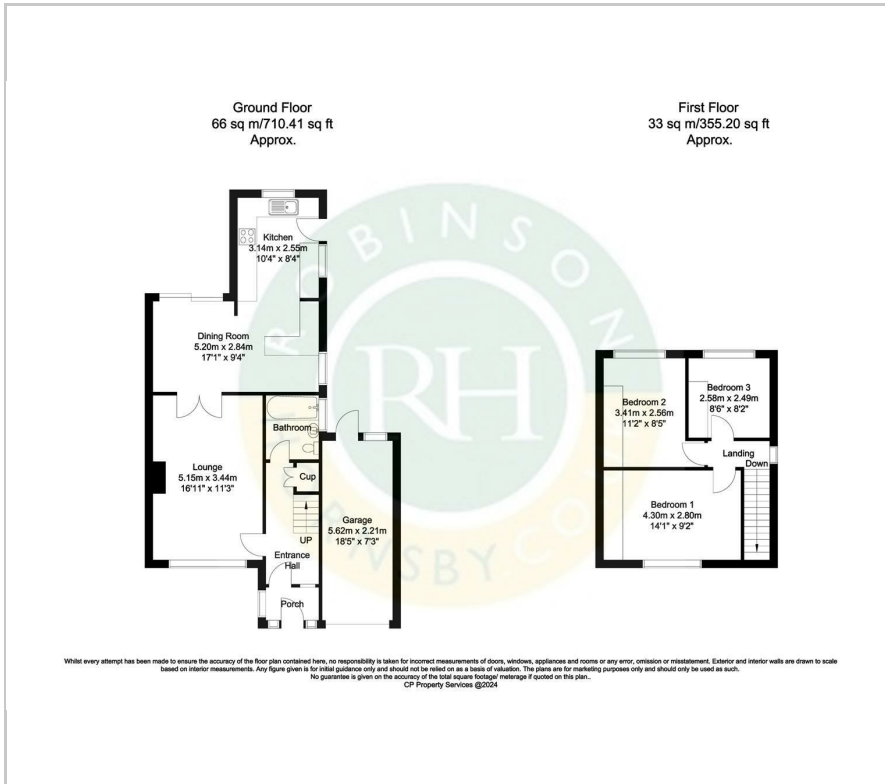

Area Map



Energy Efficiency Graph

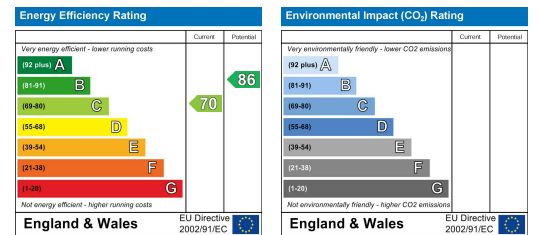

These particulars, whilst believed to be accurate are set out as a general outline only for guidance and do not constitute any part of an offer or contract. Intending purchasers should not rely on them as statements of representation of fact, but must satisfy themselves by inspection or otherwise as to their accuracy. No person in this firm's employment has the authority to make or give any representation or warranty in respect of the property.