



22 Birchwood Gardens

Braithwell, Rotherham, S66 7BT

Asking Price £180,000

Located in the heart of this most sought after rural village, a well presented 2 bedroom semi detached house, with detached garage and private garden. Briefly comprises; porch, lounge / dining room, rear fitted breakfast kitchen. First floor; 2 bedrooms and bathroom.

Outside; well presented rear lawned gardens, private patio area. Front garden.

Driveway to detached garage.

Easy access to surrounding towns, motorway and rail links.

An ideal first time buy!

- well presented 2 bedroom semi detached home
- detached garage and parking
- sought after rural village
- easy access to main motorway routes
- Tickhill 5 miles. Doncaster 7 miles. Rotherham 7 miles
- private rear garden
- cul de sac position
- an ideal first time buy

Viewing

Please contact our Office on 01302 751616 if you wish to arrange a viewing appointment for this property or require further information.



Floor Plan

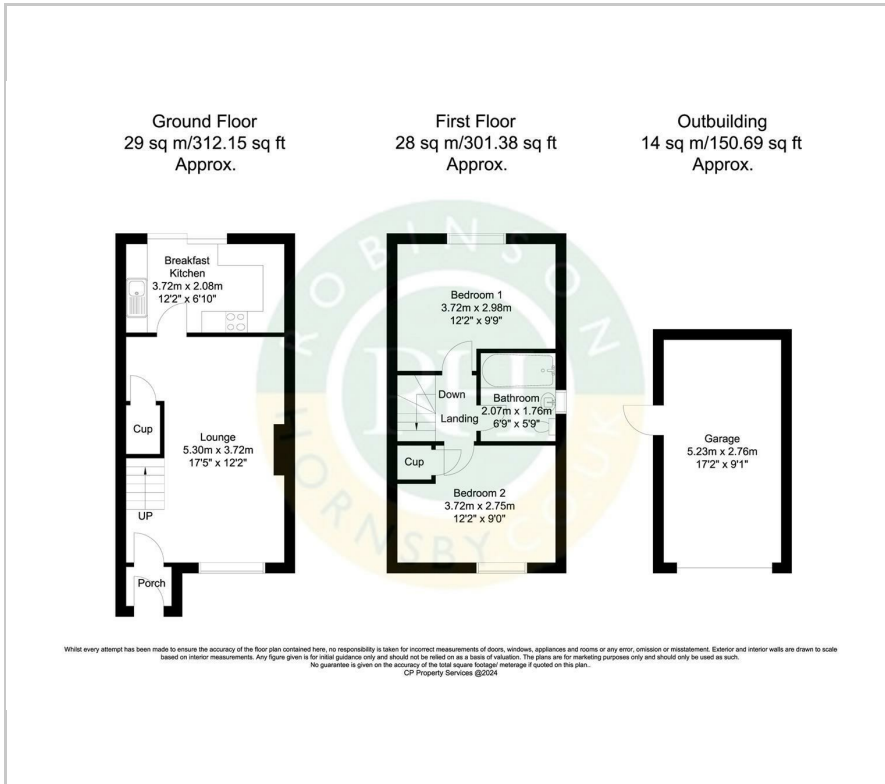

Area Map



Energy Efficiency Graph

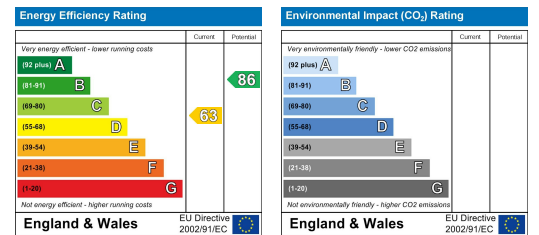

These particulars, whilst believed to be accurate are set out as a general outline only for guidance and do not constitute any part of an offer or contract. Intending purchasers should not rely on them as statements of representation of fact, but must satisfy themselves by inspection or otherwise as to their accuracy. No person in this firm's employment has the authority to make or give any representation or warranty in respect of the property.