



6 Glendale Road

Sprotbrough, Doncaster, DN5 7RA

Guide Price £390,000

Guide price £390,000-£400,000

A beautifully presented, deceptively spacious four bedroom detached house which has been substantially extended and renovated to a high specification throughout. The property in brief comprises; entrance porch, hallway, lounge with feature log burning stove, stunning open plan kitchen/dining room with a range of integrated appliances, family room/playroom, utility room, luxury shower room, four good sized bedrooms with en-suite to master, dressing room to bedroom three and contemporary family bathroom. Outside; ample off road parking to the front, storage garage and rear enclosed garden which is predominantly laid to lawn with patio seating area. Ideally located on a sought after roadway within Sprotbrough village, lying close to reputable schools and amenities this fantastic family home really must be viewed to be appreciated.

■ ***GUIDE PRICE £390,000 - £400,000***

- Four good sized bedrooms
- Substantially extended and beautifully presented throughout
- Lounge with log burning stove
- Stunning open plan kitchen/dining room
- Family room/playroom
- Downstairs shower room, en suite to master and family bathroom
- Utility room
- Driveway and storage garage
- Must be viewed

Viewing

Please contact our Office on 01302 751616 if you wish to arrange a viewing appointment for this property or require further information.

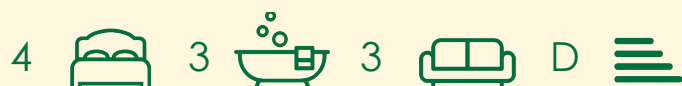

Floor Plan

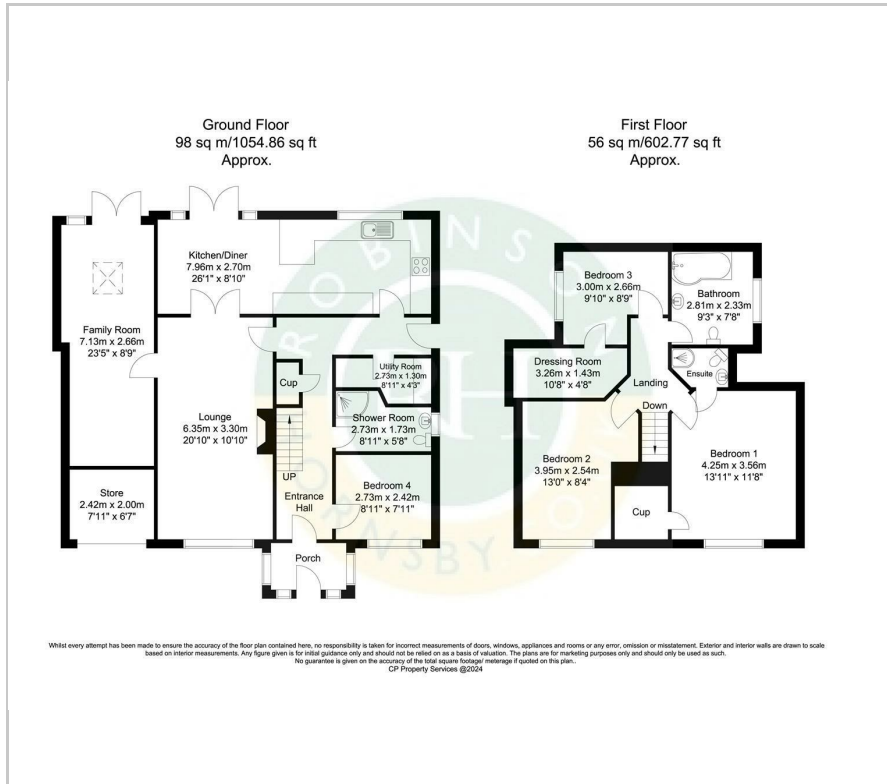

Area Map



Energy Efficiency Graph

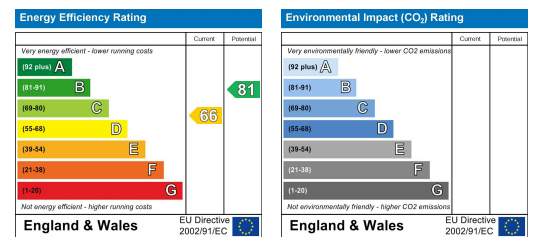

These particulars, whilst believed to be accurate are set out as a general outline only for guidance and do not constitute any part of an offer or contract. Intending purchasers should not rely on them as statements of representation of fact, but must satisfy themselves by inspection or otherwise as to their accuracy. No person in this firm's employment has the authority to make or give any representation or warranty in respect of the property.