



The Maples Scrooby Road

Harworth, Doncaster, DN11 8JT

Offers Around £270,000

NO ONWARD CHAIN - A fantastic opportunity to purchase an immaculately presented larger style four bedroom detached house occupying an enviable corner plot within the popular village of Harworth. The property in brief comprises; entrance hallway, cloaks/WC, lounge, formal dining room, fitted kitchen/breakfast room, utility room, master bedroom with luxury en suite shower room, three further double bedrooms and family bathroom. Outside; Landscaped rear enclosed garden with large timber summer house enclosed within fenced boundaries, block paved driveway and detached garage. Ideally located close to local amenities, reputable schools and motorway connections this spacious, well maintained family home must be viewed to be appreciated.

- Larger style detached house with NO ONWARD CHAIN
- Four double bedrooms
- Two reception rooms
- Fitted kitchen/breakfast room & utility room
- Luxury en suite to master bedroom
- Landscaped rear enclosed garden and large timber summer house
- Driveway and detached garage
- Immaculately presented throughout
- Close to reputable schools and amenities within Harworth
- Must be viewed

Viewing

Please contact our Office on 01302 751616 if you wish to arrange a viewing appointment for this property or require further information.

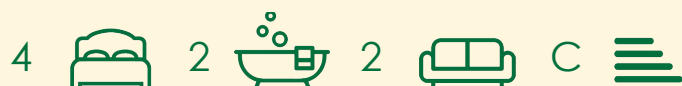

Floor Plan

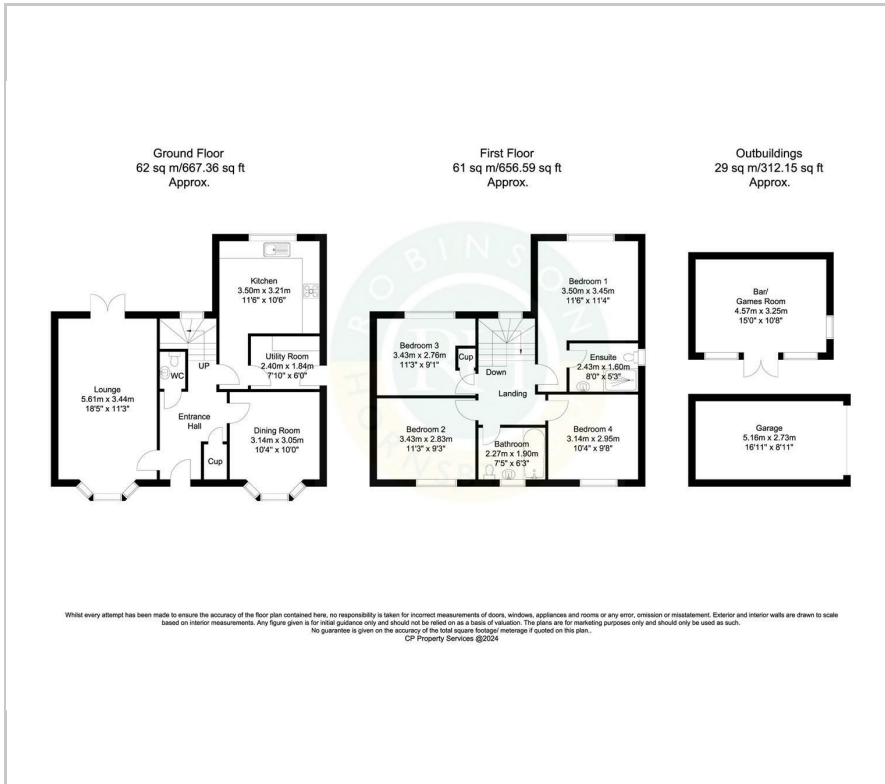

Area Map



Energy Efficiency Graph

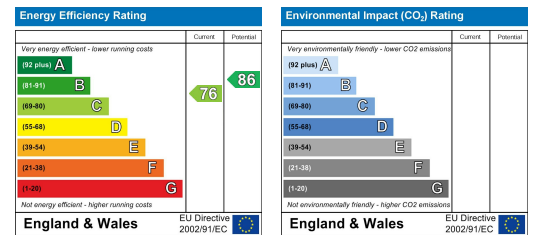

These particulars, whilst believed to be accurate are set out as a general outline only for guidance and do not constitute any part of an offer or contract. Intending purchasers should not rely on them as statements of representation of fact, but must satisfy themselves by inspection or otherwise as to their accuracy. No person in this firm's employment has the authority to make or give any representation or warranty in respect of the property.