



20 Silverdale Close

Branton, Doncaster, DN3 3PS

Offers In The Region Of £240,000

BROUGHT TO THE MARKET WITH NO ONWARD CHAIN. Viewing is advised of this 2 bedroom detached bungalow occupying a pleasant position on this ever popular development within the village of Branton. The accommodation comprises: hall with storage cupboard, lounge/dining room with fireplace, kitchen/breakfast room with side access and pantry cupboard, two bedrooms and a conservatory to the rear, modern shower room. Outside; to the front of the property there is a garden with side driveway and detached garage, enclosed rear garden with shed, raised decking and laid to lawn garden together with a patio area.

- NO ONWARD CHAIN
- 2 bedroom detached bungalow
- Modern shower room
- Lounge/dining room
- Kitchen/breakfast room
- Conservatory leading off bedroom 2
- Village location
- Well-maintained private garden with shed and decking
- Driveway and garage
- Freehold, council tax band C

Viewing

Please contact our Office on 01302 751616 if you wish to arrange a viewing appointment for this property or require further information.



Floor Plan

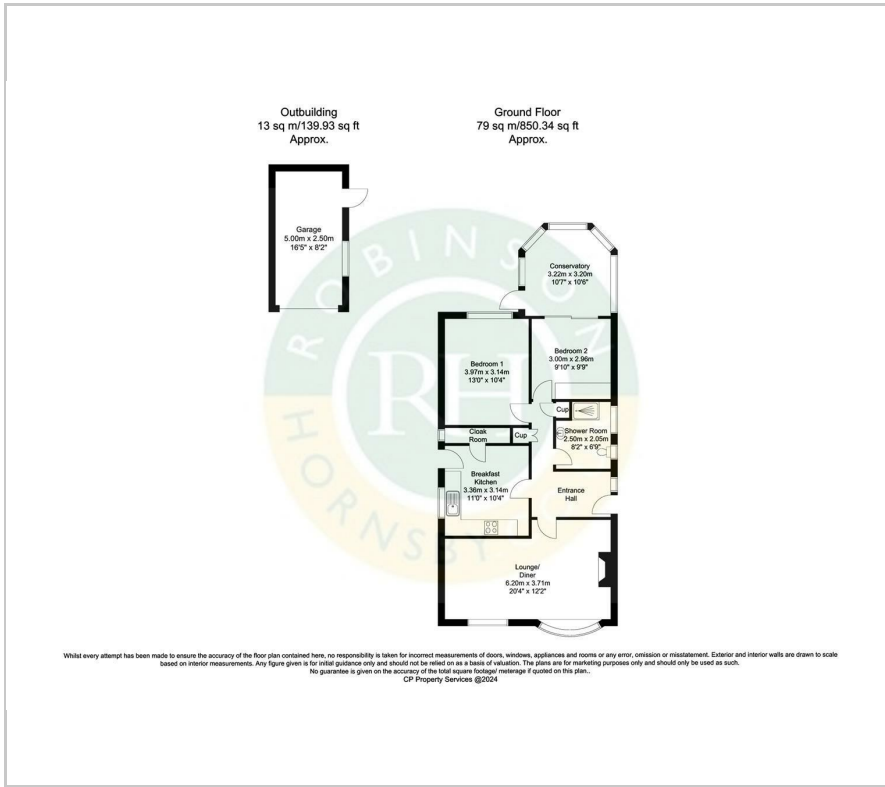

Area Map



Energy Efficiency Graph

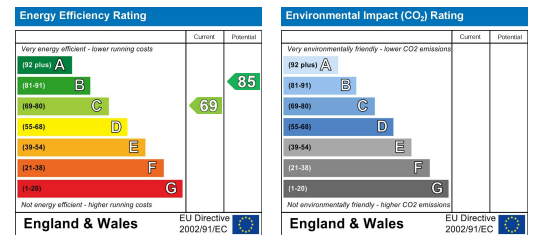

These particulars, whilst believed to be accurate are set out as a general outline only for guidance and do not constitute any part of an offer or contract. Intending purchasers should not rely on them as statements of representation of fact, but must satisfy themselves by inspection or otherwise as to their accuracy. No person in this firm's employment has the authority to make or give any representation or warranty in respect of the property.