



4 Ashdale Close

Edenthorpe, Doncaster, DN3 2LA

£265,000

A rare opportunity to purchase an extremely well appointed 2 bedroom detached bungalow (formally 3 bedrooms) brought to the market with NO ONWARD CHAIN. The versatile accommodation is currently laid out as: dining room (potential 3rd bedroom) featuring twin glazed doors leading to an attractive lounge with feature stone fireplace which has an open walkway through to an open plan kitchen/living space, the kitchen area is fitted with an array of wall and base units, space for white goods and built in ovens, ample space for table. Two double bedrooms, one with a wardrobe and an access door to the rear garden, bedroom 2 has further wardrobes. Re fitted, contemporary shower room with wall hung storage unit and fully tiled. To the outside of the property there is a front garden together with side driveway leading to a detached garage, access to rear garden laid to lawn with central path and fenced boundaries.

- Spacious two bedroom detached bungalow (formally 3 beds)
- Versatile layout with separate dining room currently
- Attractive lounge with stone fireplace
- Superb open plan living space with generous area for table
- Two double bedrooms both with wardrobes
- Contemporary shower room with wall hung unit
- Sought after area close to amenities
- Bus routes nearby
- No onward chain
- Freehold, council tax band C

Viewing

Please contact our Office on 01302 751616 if you wish to arrange a viewing appointment for this property or require further information.



Floor Plan

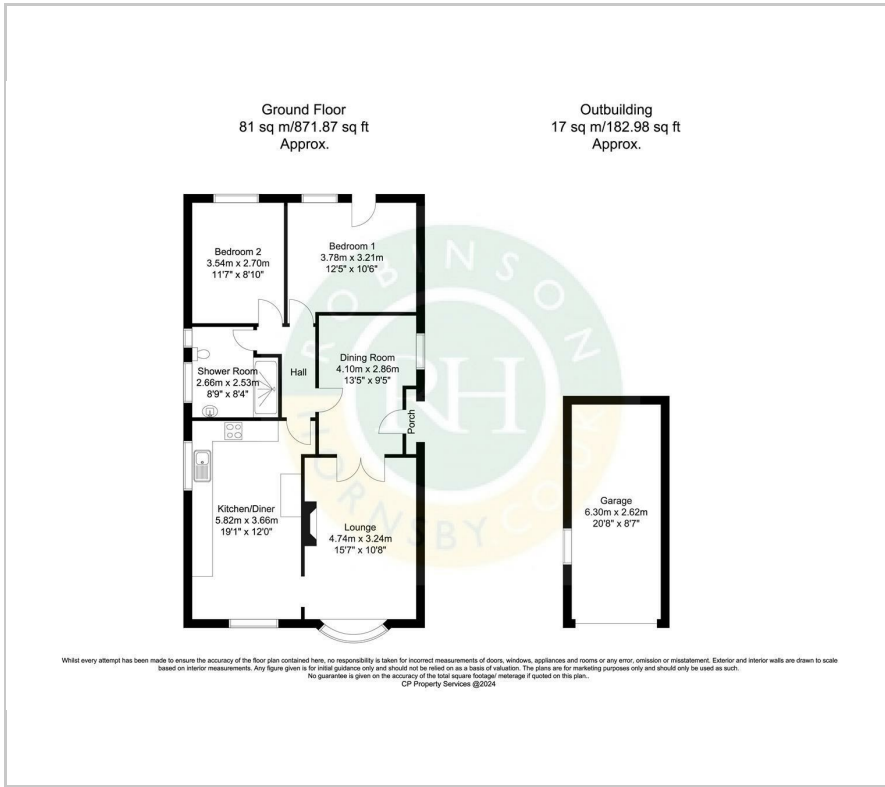

Area Map



Energy Efficiency Graph

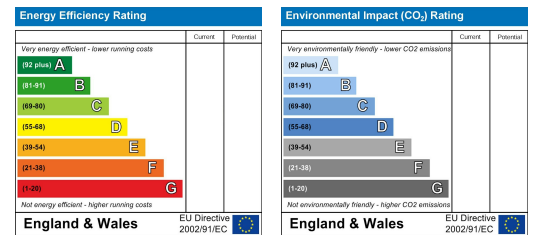

These particulars, whilst believed to be accurate are set out as a general outline only for guidance and do not constitute any part of an offer or contract. Intending purchasers should not rely on them as statements of representation of fact, but must satisfy themselves by inspection or otherwise as to their accuracy. No person in this firm's employment has the authority to make or give any representation or warranty in respect of the property.