



34 Reeves Way

Armthorpe, Doncaster, DN3 2FD

Guide Price £150,000

***GUIDE PRICE £150,000-£155,000 ***

A modern, three bedroom end town house available in the popular village of Armthorpe. Located close to excellent local schools and countless amenities with convenient transport links to motorways and Doncaster town centre. The property comprises of; entrance hallway, downstairs WC, lounge with patio doors leading to the enclosed rear garden, modern fitted kitchen with integrated oven, hob & extractor. Upstairs there are three bedrooms and family bathroom with white suite and shower. Outside; enclosed rear garden and allocated car parking space. Lovely property must be viewed.

- End Townhouse
- Three bedrooms
- Modern Fitted Kitchen
- Lounge with Patio doors
- Downstairs WC and White Bathroom Suite with Shower
- Popular location
- Close to local amenities
- Recently decorated throughout
- Rear Garden & Allocated parking
- No onward chain

Viewing

Please contact our Office on 01302 751616 if you wish to arrange a viewing appointment for this property or require further information.



Floor Plan

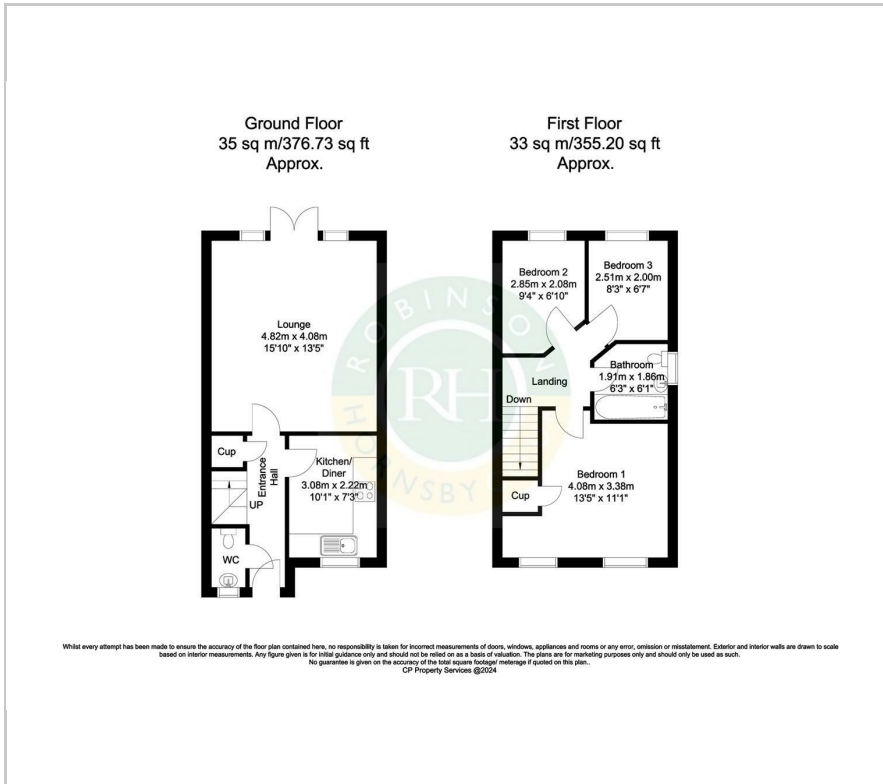

Area Map



Energy Efficiency Graph

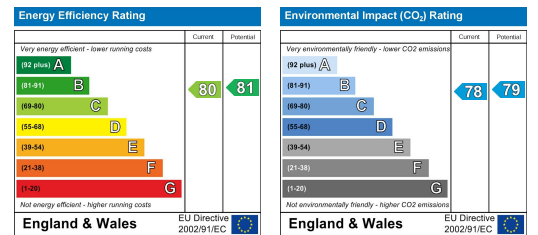

These particulars, whilst believed to be accurate are set out as a general outline only for guidance and do not constitute any part of an offer or contract. Intending purchasers should not rely on them as statements of representation of fact, but must satisfy themselves by inspection or otherwise as to their accuracy. No person in this firm's employment has the authority to make or give any representation or warranty in respect of the property.