



2 Swinburne Close

Barnby Dun, Doncaster, DN3 1BS

Offers In The Region Of £290,000

FORMALLY 4 BEDROOMS, this spacious 3 bedroom larger than average bungalow occupies a cul-de-sac position. Lying within easy reach of local bus routes, shops and schools this property offers versatile accommodation. Comprising; entrance hall, archway through to kitchen/breakfast room with peninsular bar, through to second reception room, doors lead through to an impressive size lounge/dining room with feature glazed window and views to the front. Inner hall has storage, master bedroom with en-suite, further two bedrooms and a modern bathroom. Outside there is a blockpaved driveway and dwarf wall separating the driveway to a side pathway leading to small garden to the rear and access to the front of the property, further to the front and side is a hard standing ideal for garden furniture, fenced boundaries opening to a lawned garden with flower borders stretching to the front of the property. No onward chain.

- Larger than average 3 (formally 4 bedrooms) bedroom detached bungalow
- Corner plot in sought after village
- Amenities closeby including schools and bus stops
- Kitchen/breakfast room
- Second reception room
- Large lounge/dining room
- En-suite to master bedroom
- No onward chain
- Driveway and detached garage, attractive gardens
- Freehold, council tax band D

Viewing

Please contact our Office on 01302 751616 if you wish to arrange a viewing appointment for this property or require further information.

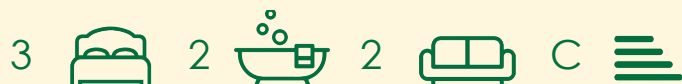

Floor Plan

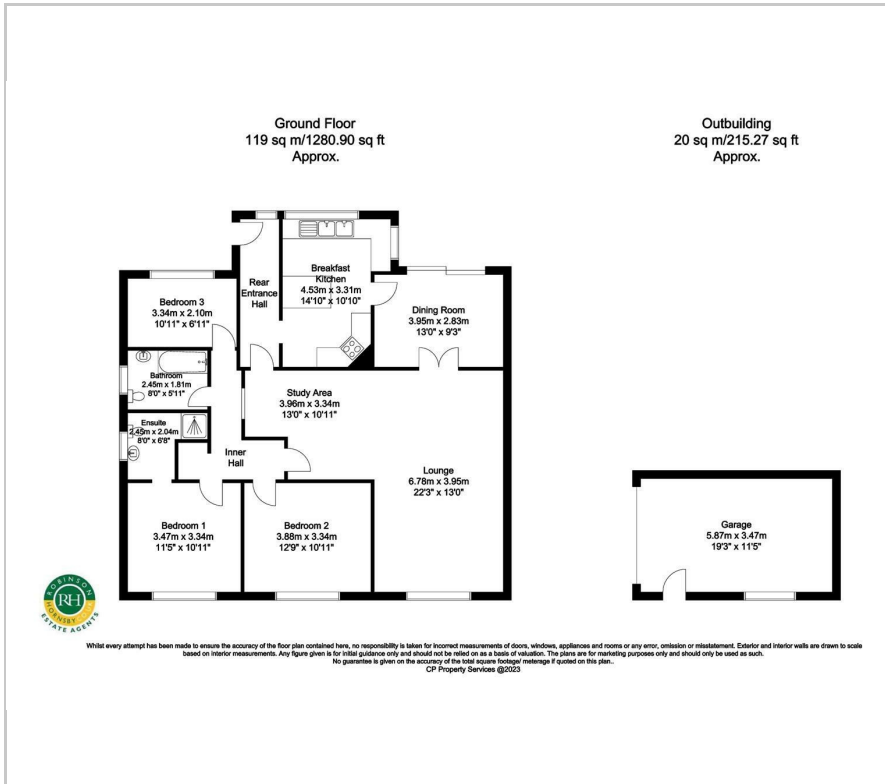

Area Map



Energy Efficiency Graph

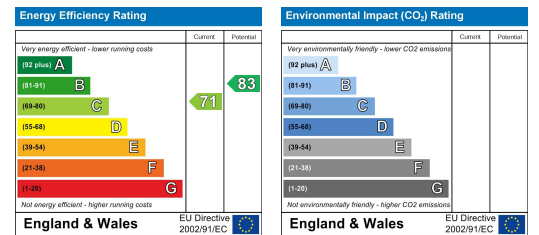

These particulars, whilst believed to be accurate are set out as a general outline only for guidance and do not constitute any part of an offer or contract. Intending purchasers should not rely on them as statements of representation of fact, but must satisfy themselves by inspection or otherwise as to their accuracy. No person in this firm's employment has the authority to make or give any representation or warranty in respect of the property.