



## 4 Millstream Close

Sprotbrough, Doncaster, DN5 7YA

### Offers In The Region Of £420,000

Set in the sought after location of Sprotbrough is this well presented and EXTENDED 4 Bedroom Detached Family Home. Being situated close to local amenities to include primary schools and the A1 motorway link. The spacious accommodation briefly comprises: Entrance hall with WC. Lounge. Impressive Open Plan Kitchen/Family Room to the rear of the property which opens out onto the rear garden. Stairs lead to the first floor landing and the Master Bedroom with En-Suite and Dressing Room. Three further generous size Bedrooms and Family Bathroom. Externally is a driveway providing parking which leads to the Garage. The Rear Garden has a Summer House and mainly laid to Lawn. An Early Viewing is highly recommended.

- Sought After Location
- Detached Family Home
- Four Bedrooms
- Open Plan Kitchen/Family Room
- En-suite and Dressing Room to Master
- Garage
- Downstairs WC
- EXTENDED
- Council Tax Band D
- Freehold

### Viewing

Please contact our Office on 01302 751616 if you wish to arrange a viewing appointment for this property or require further information.



# Floor Plan

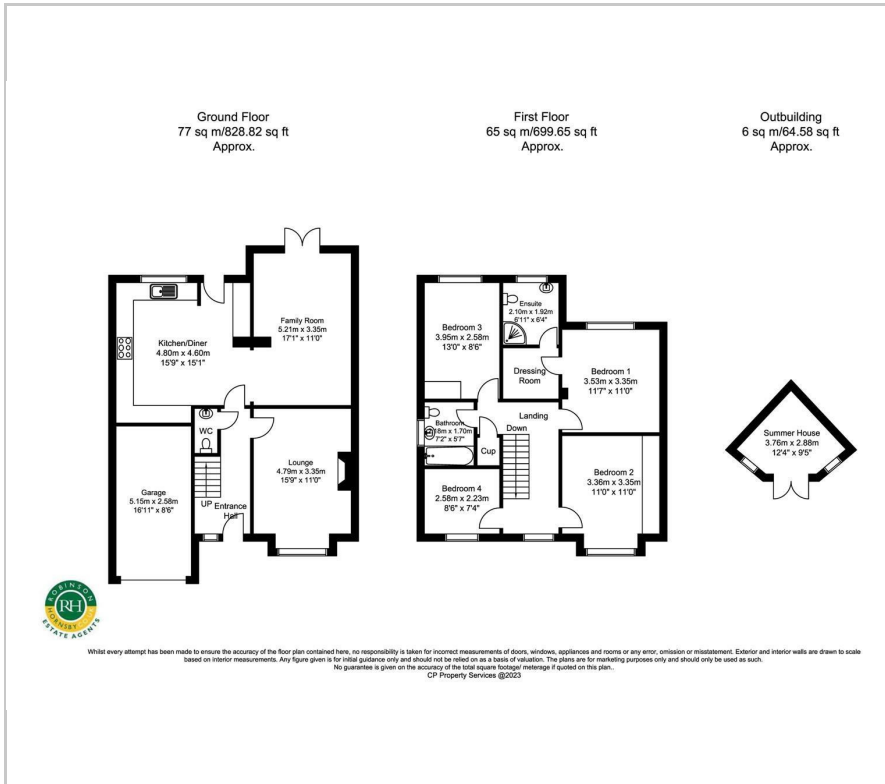

# Area Map



# Energy Efficiency Graph

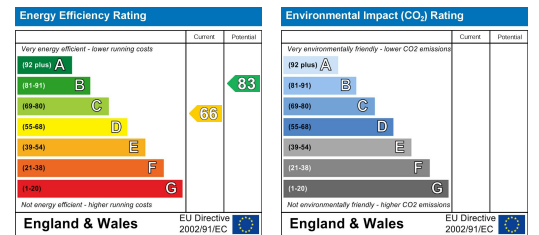

These particulars, whilst believed to be accurate are set out as a general outline only for guidance and do not constitute any part of an offer or contract. Intending purchasers should not rely on them as statements of representation of fact, but must satisfy themselves by inspection or otherwise as to their accuracy. No person in this firm's employment has the authority to make or give any representation or warranty in respect of the property.