

CHRISTIAN REID
ESTATE AGENTS



52 Westdene

£219,950

Cranleigh, GU6 8UJ



1 Bedrooms



1 Receptions



1 Bathrooms



Terraced



EPC:

A one bedroom Mews style house, situated in a quiet corner of this sought after development and enjoying stunning views over open meadow land. Westdene Meadows is a small, modern attractive development situated on edge of the village and within walking distance of the High Street. The property is approached via a pitched and tiled canopied entrance with courtesy light and a front door opening into a spacious living room with a pleasant front aspect enjoying the views. Stairs lead to the first floor and a door opens into the kitchen which is well equipped and modern. Upstairs provides a bathroom and a double bedroom with built in wardrobes and far reaching views. In our opinion this lovely home will appeal to a wide range of purchasers especially first time buyers, professionals and rental investors searching for an excellent yield.

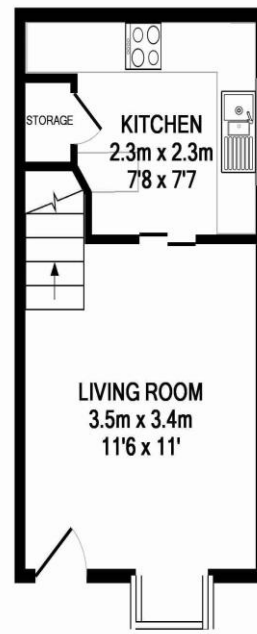

GROUND FLOOR

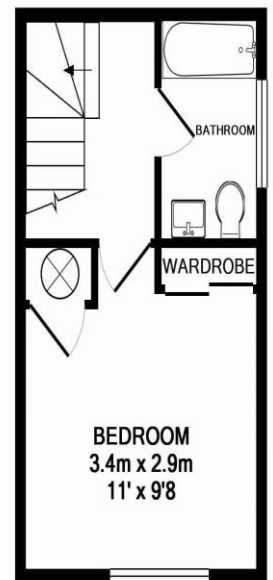

1ST FLOOR

Whilst every attempt has been made to ensure the accuracy of the floor plan contained here, measurements of doors, windows, rooms and any other items are approximate and no responsibility is taken for any error, omission, or mis-statement. This plan is for illustrative purposes only and should be used as such by any prospective purchaser. The services, systems and appliances shown have not been tested and no guarantee as to their operability or efficiency can be given

Made with Metropix ©2015