



Sky Apartments, Homerton Road, Hackney, E9 5FA

£370 Per Week

A studio apartment for rent within this fantastic luxury riverside development 'Matchmakers Wharf'

Located in Homerton, Hackney E9, situated on the Hackney Cut River and Hackney Marches.

Easy commute to Stratford and the City, short walk to the station.

The apartment boasts solid wood flooring, floor to ceiling windows with glass doors leading out to a private terrace, luxury fitted kitchen and bathroom suite, 24 hour concierge, residents gym, stunning communal residents roof garden.

Comes furnished.

PROPERTY AVAILABLE FROM 07.10.2024

- Matchmakers Wharf E9
- Riverside Development
- Residents Gymnasium
- Large Studio Flat
- Excellent Transport Links
- Available From 07.10.2024
- Furnished
- 24 Hour Concierge
- Walk To Station

Sky Apartments, Homerton Road, Hackney, E9 5FA



LIVING SPACE



BEDROOM SPACE VIEW



KITCHEN



SHOWER ROOM



BEDROOM SPACE



BALCONY

Sky Apartments, Homerton Road, Hackney, E9 5FA



BALCONY VIEW



COMMUNAL TERRACE



GYM



CANAL VIEW



COMMUNAL TERRACE VIEW

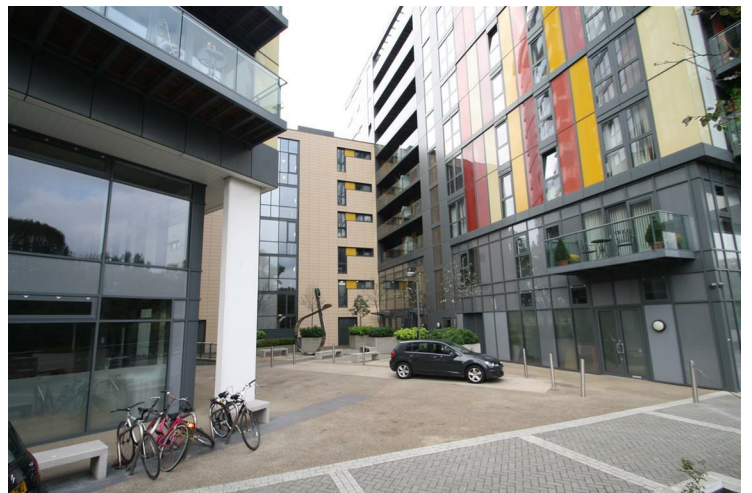

MATCHMAKERS WHARF

Sky Apartments, Homerton Road, Hackney, E9 5FA



SKY APARTMENTS



CONCIERGE



CONCIERGE VIEW

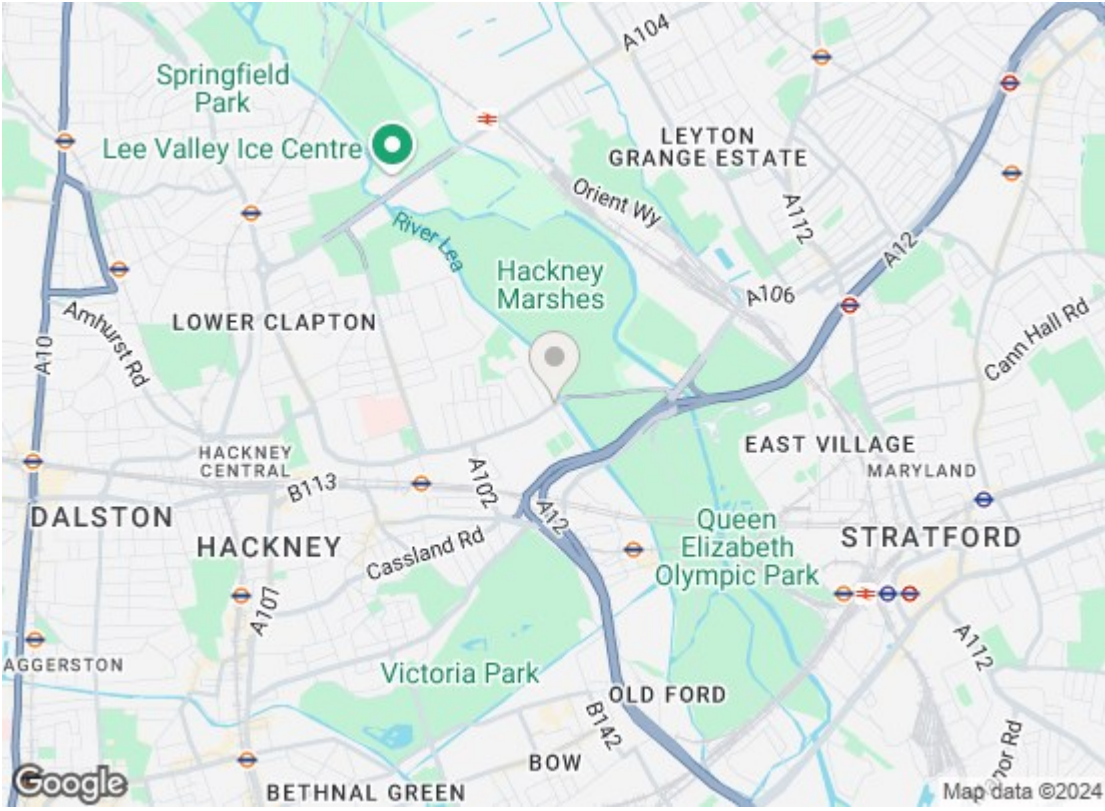

Energy Efficiency Rating

	Current	Potential
Very energy efficient - lower running costs		
(92 plus) A		
(81-91) B	81	81
(69-80) C		
(55-68) D		
(39-54) E		
(21-38) F		
(1-20) G		
Not energy efficient - higher running costs		

England & Wales EU Directive 2002/91/EC

Environmental Impact (CO₂) Rating

	Current	Potential
Very environmentally friendly - lower CO ₂ emissions		
(92 plus) A		
(81-91) B		
(69-80) C		
(55-68) D		
(39-54) E		
(21-38) F		
(1-20) G		
Not environmentally friendly - higher CO ₂ emissions		

England & Wales EU Directive 2002/91/EC

We have prepared these property particulars as a general guide to a broad description of the property. They are not intended to constitute part of an offer or contract. We have not carried out a structural survey and the services, appliances and specific fittings have not been tested. All photographs, measurements, floorplans and distances referred to are given as a guide only and should not be relied upon for the purchase of carpets or any other fixtures or fittings. Lease details, service charges and ground rent (where applicable) and council tax are given as a guide only and should be checked and confirmed by your Solicitor prior to exchange of contracts.