



Webbs

Helping people move since 1994

Heathland Close | Heath Hayes, Cannock | WS12 3XB

Offers Over £240,000

 **Webbs**
estate agents

Summary

** WOW ** STUNNING THREE BED SEMI DETACHED FAMILY HOME ** PLAYROOM/OFFICE/BEDROOM ** GREAT SIZED LOUNGE ** UTILITY ROOM ** PRIVATE DRIVE ** DINING ROOM ** FULLY ENCLOSED REAR GARDEN **

WEBBS ESTATE AGENTS are delighted to welcome to market the beautiful Heathland close a three bed semi detached family home . Heathland road is a pure delight providing space, comfort and convenience . The property briefly comprises of a good sized lounge and dining area , kitchen, play room/bedroom/office and utility room . On the first floor landing there are three good sized bedroom and a family bathroom . Heathland close has had the garage converted so it has the versatility to provide room for working from home or perhaps another bedroom .

EXTERNALLY

There is a lovely enclosed rear garden where children can play safely or perhaps unwind after a long day at work . There is a private drive with parking for several vehicles . Location is perfect being within walking distance to your local amenities and the local good schools . Hednesford hills an are of outstanding natural beauty is also within easy reach .

** VIEWING IS ESSENTIAL TO AVOID DISAPPOINTMENT **

Key Features

- THREE BED SEMI
- FAMILY BATHROOM
- DINING ROOM
- ENCLOSED RER GARDEN
- PLAYROOM/4TH BEDROOM/OFFICE
- LOUNGE
- PRIVATE DRIVE
- WALKING DISTANCE TO LOCAL AMENITIES

Rooms and Dimensions

ENTRANCE HALLWAY

LOUNGE

12'7" x 12'1" (3.853 x 3.685)

DINING ROOM

9'5" x 7'5" (2.877 x 2.277)

KITCHEN

9'6" x 7'4" (2.908 x 2.259)

UTLITY ROOM

8'4" x 7'6" (2.550 x 2.287)

PLAYROOM/ BEDROOM

8'4" x 7'6" (2.554 x 2.310)

FIRST FLOOR LANDING

MASTER BEDROOM

9'7" x 9'1" (2.942 x 2.772)

BEDROOM TWO

12'9" x 8'6" (3.898 x 2.612)

BEDROOM THREE

7'4" x 6'6" (2.254 x 1.996)

FAMILY BATHROOM

EXTERNALLY

ENCLOSED REAR GARDEN

PRIVATE DRIVE

IDENTIFICATION CHECKS - C

Premium Conveyancing (B)





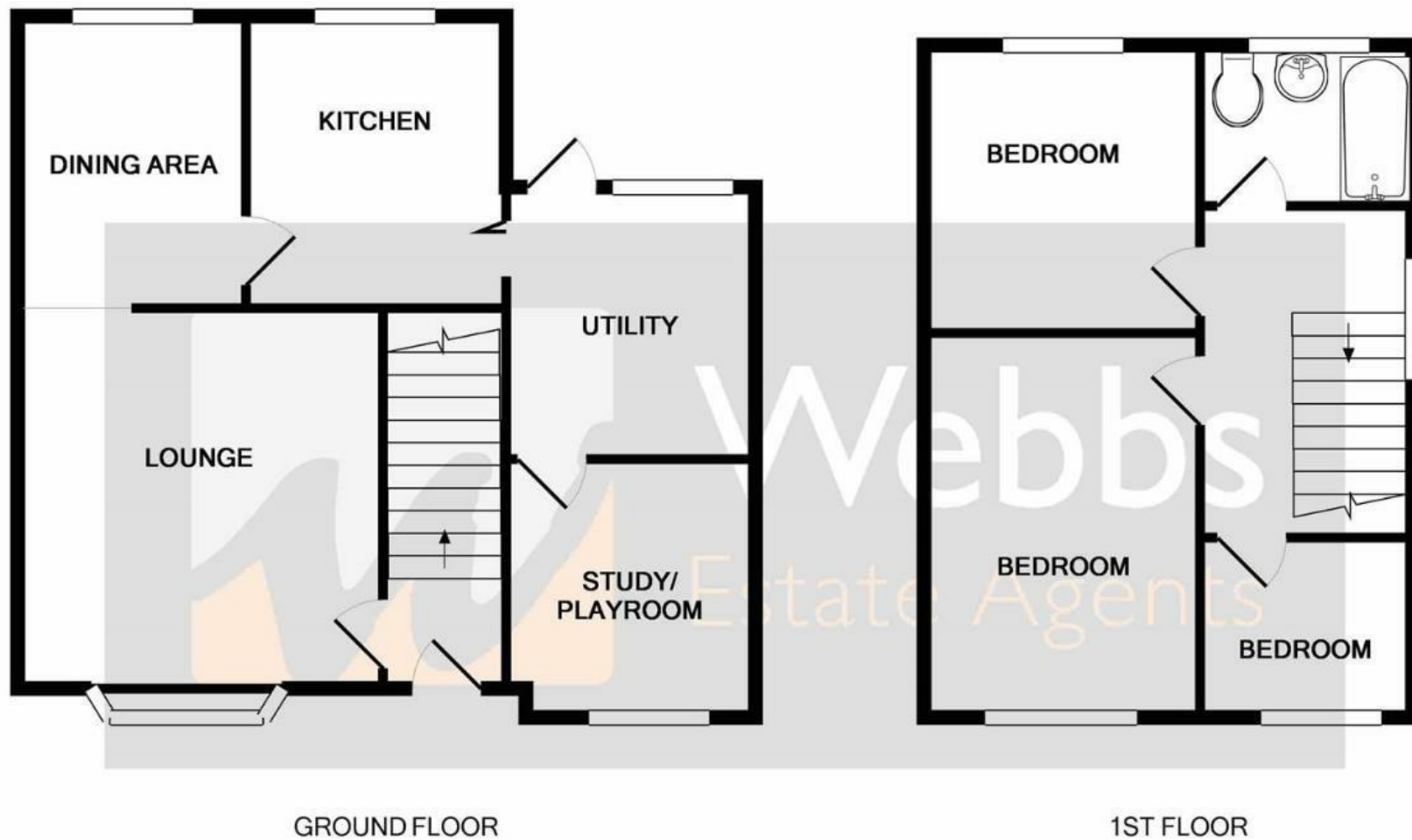

Webbs Estate Agents - endeavour to maintain accurate depictions of properties in Virtual Tours, Floor Plans and descriptions, however, these are intended only as a guide and purchasers must satisfy themselves by personal inspection.

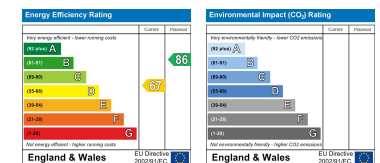

153 Avon Road, Cannock, WS11 1LF

Tel: 01543 468846 | Email: sales@webbestateagents.co.uk | www.webbestateagents.co.uk