



Webbs
Helping people move since 1994

Gilpin Crescent | Walsall | WS3 4HX

£975 PCM

 **Webbs**
estate agents

Summary

Webbs Estate Agents are pleased to offer this beautifully presented and much-improved two-bedroom link-detached home in a popular, well-connected location.

The property features a spacious driveway, lawned frontage, and access to a storage garage. Inside, a welcoming lounge with bay window and cosy fireplace leads to a dining room and an impressive extended orangery overlooking the private rear garden.

The refitted kitchen is finished to a high standard and includes quality appliances, with a separate utility room, downstairs WC, and a versatile study which can be used as a playroom or snug. Upstairs offers two generous double bedrooms and a modern shower room.

Externally, the well-maintained rear garden features a paved patio, ideal for outdoor enjoyment.

Early viewing recommended.

Key Features

Rooms and Dimensions

PROPERTY DETAILS:

Lounge

14'11" x 14'11" (4.57 x 4.57)

Kitchen

12'0" x 6'9" (3.66 x 2.08)

Dining Room

10'2" x 7'8" (3.12 x 2.36)

Conservatory

8'9" x 8'7" (2.69 x 2.64)

Utility

7'8" x 6'5" (2.36 x 1.98)

Study

6'7" x 6'3" (2.03 x 1.93)

Bedroom 1

14'11" x 9'8" (4.57 x 2.97)

Bedroom 2

11'6" x 8'11" (3.53 x 2.74)

Please Note



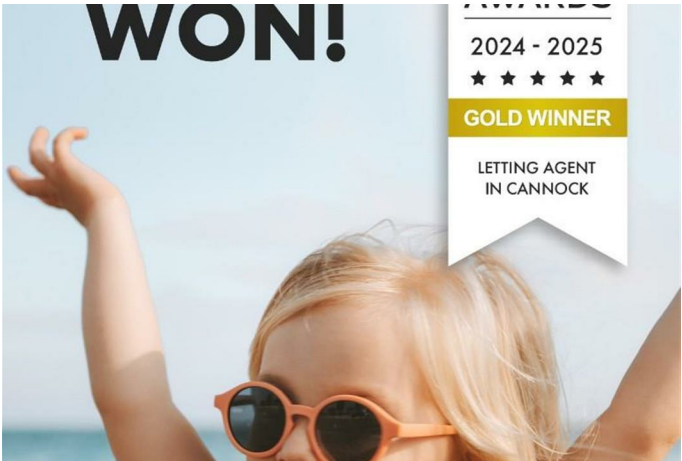

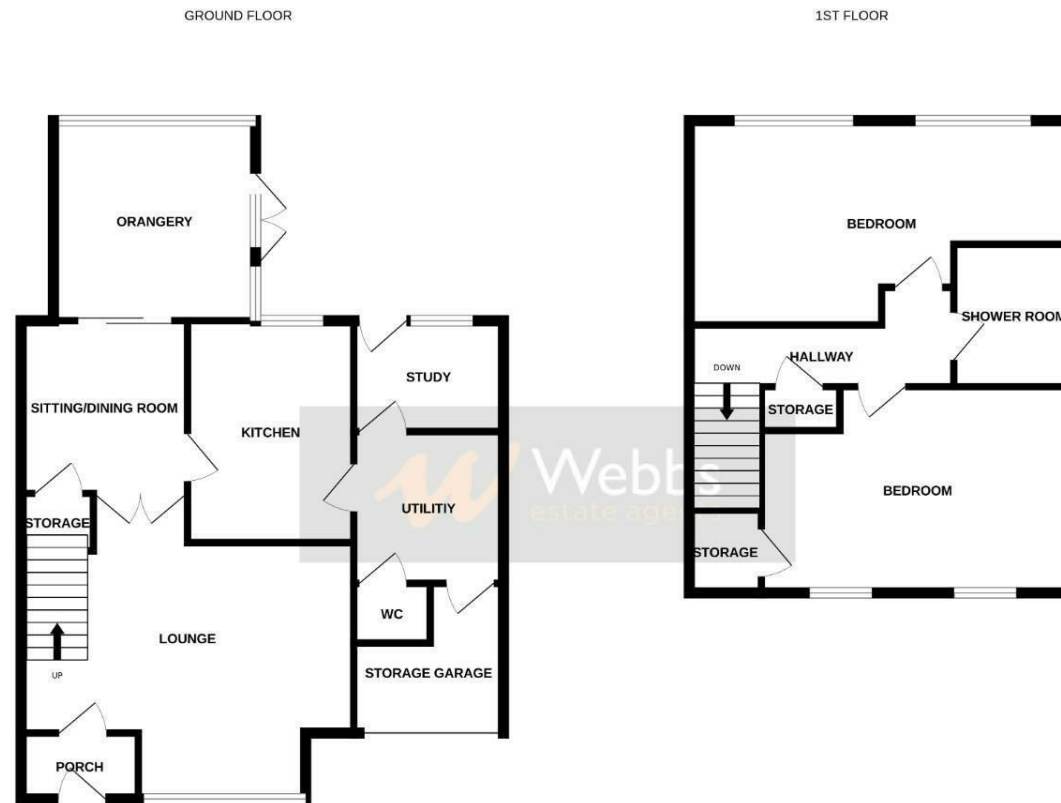

Whilst every attempt has been made to ensure the accuracy of the floorplan contained here, measurements of doors, windows, rooms and any other items are approximate and no responsibility is taken for any error, omission or mis-statement. This plan is for illustrative purposes only and should be used as such by any prospective purchaser. The services, systems and appliances shown have not been tested and no guarantee as to their operability or efficiency can be given.
Made with Metropix 6/2025.

Webbs Estate Agents - endeavour to maintain accurate depictions of properties in Virtual Tours, Floor Plans and descriptions, however, these are intended only as a guide and purchasers must satisfy themselves by personal inspection.

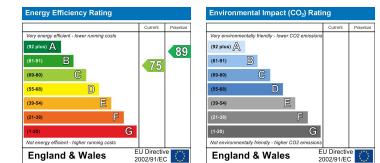

153 Avon Road, Cannock, WS11 1LF

Tel: 01543 468846 | Email: sales@webbestateagents.co.uk | www.webbestateagents.co.uk

Webbs
estate agents